

U.P.R.N. :

1336

Cadastral Sheet B. 25. A. $\frac{24C}{4/a}$

1033

R.P.O. Vol. 11 Fol. 389

Ward of Arima

C.T. Vol. 4701 Fol. 151

County of St. George

Vide: Bk. 1227 Fol.127

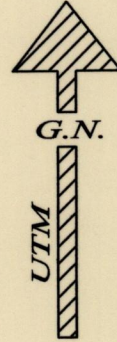

10 & 9A2 to be amalgamated

Area of (9A2) = 56.6 m²

A - B 99° 54' 24.35

K - G 157° 26' 21.55

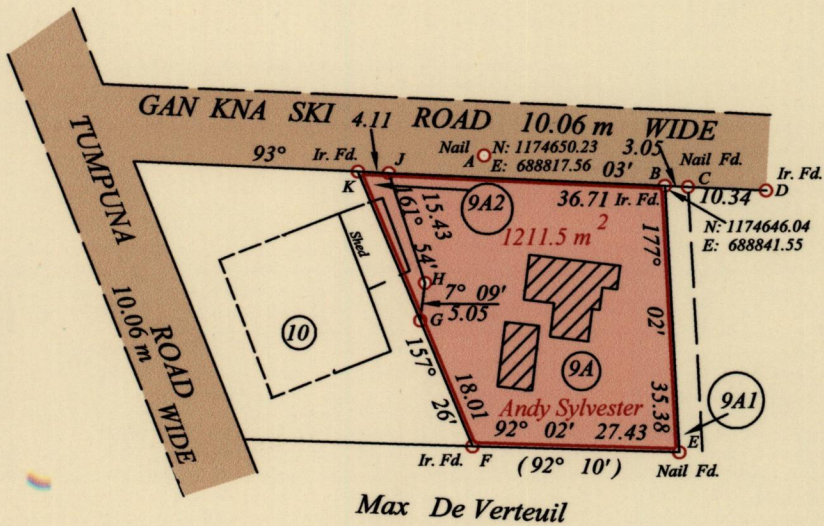

Max De Verteuil

Approved

Director of Surveys 2010.8.13

SCALE : 1:1000

Distances are in Metres

To obtain Cassini Bearing add 18 minutes.

U.T.M. Bearings are based on Solar Observations

⊙ Denotes Iron Put unless otherwise stated

GPS coordinates of Point A & B were determined using two Geodetic type GPS receivers and then transformed to the Naparima Datum using parameters obtained from the Lands and Surveys Division. The coordinates are precise to ± 0.03 metres.

Plan of two parcels of land coloured pink, in the Ward of Arima, containing together one two one one point five square metres, surveyed by me, with due authority, in November 2005, at the request of Andy Sylvester.

In accordance with Reg. 25(1) of the Land Surveyors' Regulations 1998, I certify that this plan is correct.

Entered on

Checked by: MM 11/8/10

Trinidad and Tobago Land Surveyor 30-06-2010