

C.T Vol. 5511 Fol 35
RPO Vol. 631 Fol. 555
CT. Vol. Fol.

Coordinates

X (N.W. Cor.): N 1177870
E 674031

Error Statement : ± 4m

Datum Definition : U.T.M. Zone 20 Naparima

Source : Magellan Hand Held GPS

Lot No.	C.T.Ref.	Name	Area(m ²)
3	Vol.3412 Fol.273	Hadeed Hosein & Ann Marie Playa Hosein	727.6
5A	Vol.2698 Fol.349	Baldeo Ramlachan	4.4
5B	Vol.2961 Fol.165	Angela Cubie, Rosalind Cubie & Elizabeth Cubie	368.0

Area of 3 + 5A + 5B = 1100.0m²
 REMAINING PORTION = 2921.6m²

REMAINING PORTION

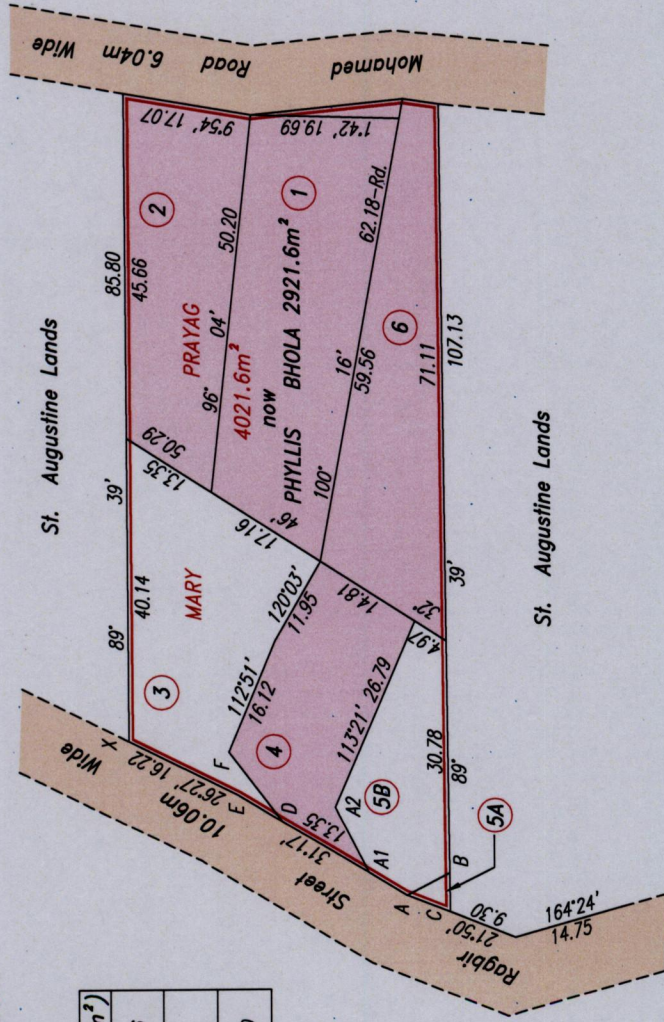

Approved *[Signature]*
 Director of Surveys
 20.0.8.12

SCALE 1 : 1000

Distances are in metres

This is a true copy of a diagram of four thousand and twenty one point six square metres originally transferred to Mary Prayag showing a portion (Parcels 1,2,4 and 6) coloured pink and containing two thousand nine hundred and twenty one point six square metres being the remainder after three previous transfers of other portions of the land. In accordance with Regulation 25 (1) of the Land Surveyors' Regulations 1998, I certify that this plan is correct.

Checked by *[Signature]* 6/8/10
 Entered on
 Trinidad & Tobago Land Surveyor..... July 2010

Ward of Tacarigua
 County of St. George
 Cadastral Sheet (B.18.1), 23C
 2/b



Parcel Address: Rogbir Street, Tacarigua

Line	Bearing	Distance
A - B	152° 15'	6.37
C - B	89° 37'	5.24
C - A	22° 49'	1.83
D - E	31° 17'	6.77
D - F	52° 28'	11.64
A1 - A2	63° 15'	9.78
A - A1	31° 17'	5.97

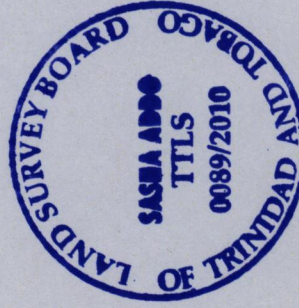

1336 05

1015