

1333 49

49

CONSOLIDATION PLAN

Cadastral Sheet G.13.B, 63F  
County of Victoria 1/a  
Ward of Naparima  
Debe

Refs. : Bk 1010 Fol 192 & 6  
Plan E.K. 8  
Plans J.L.102 & J.L.103

Cassini  
G.N.

Lot#	Area	CT Vol & Fol	Owner
13A	96.7 m <sup>2</sup>	5145:179	Edward Moodie & Ors.
13B	417.4m <sup>2</sup>	5145:163	Edward Moodie & Ors.

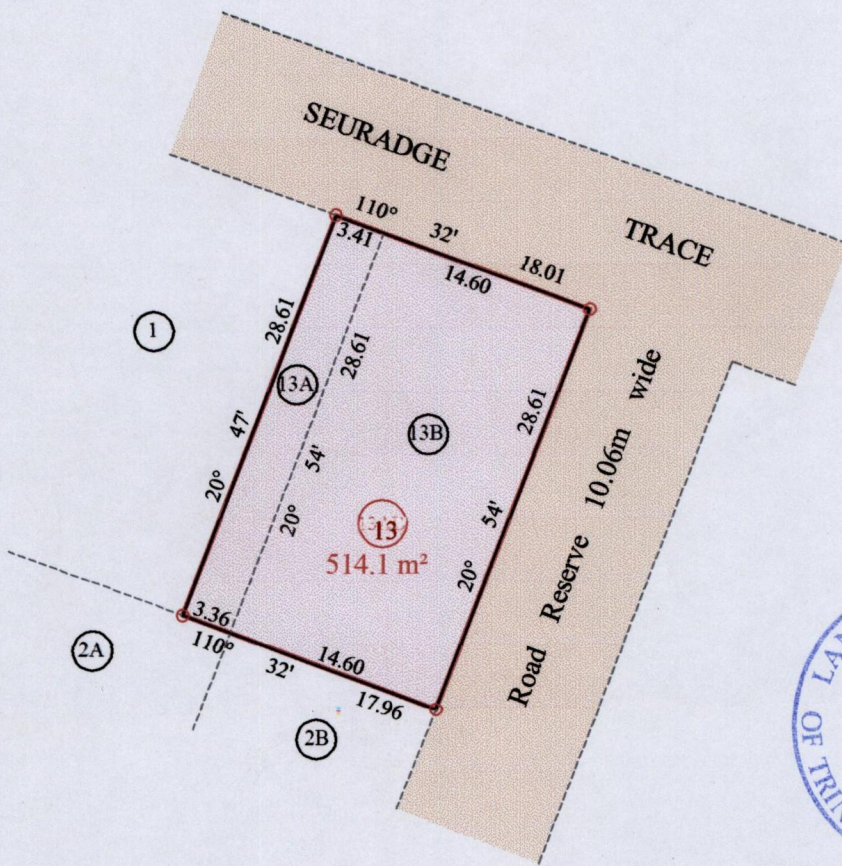

Approved

*[Signature]*  
Director of Surveys 2009.12.14

o denotes Iron put except otherwise stated  
Bearings are Cassini Grid based on Solar Obs.  
Distances are in METRES  
SCALE 1/500

PLAN of a parcel of land coloured pink in the Ward of Naparima  
Comprising five one four point one square metres.

Prepared by me, with due authority, from surveys done by Ron Gajadhar in September 2006.  
In accordance with Regulation 25 (1) of the Land Surveyors' Regulations 1998,  
I certify that this plan is correct.

Entered on.....  
Checked by *MM 20/5/109*

*[Signature]*  
Trinidad and Tobago Land Surveyor .....2009