

R.P.O. Vol. 178

Fol. 99

Cadastral Sheet F.14.K. 62D
37b

C.T. Vol. 1084

Fol. 93

Ward of La Brea

County of St.Patrick.

Bk.478 fol 5

Bk.488 fol 57

Plan FE 19

Cassini
G | N

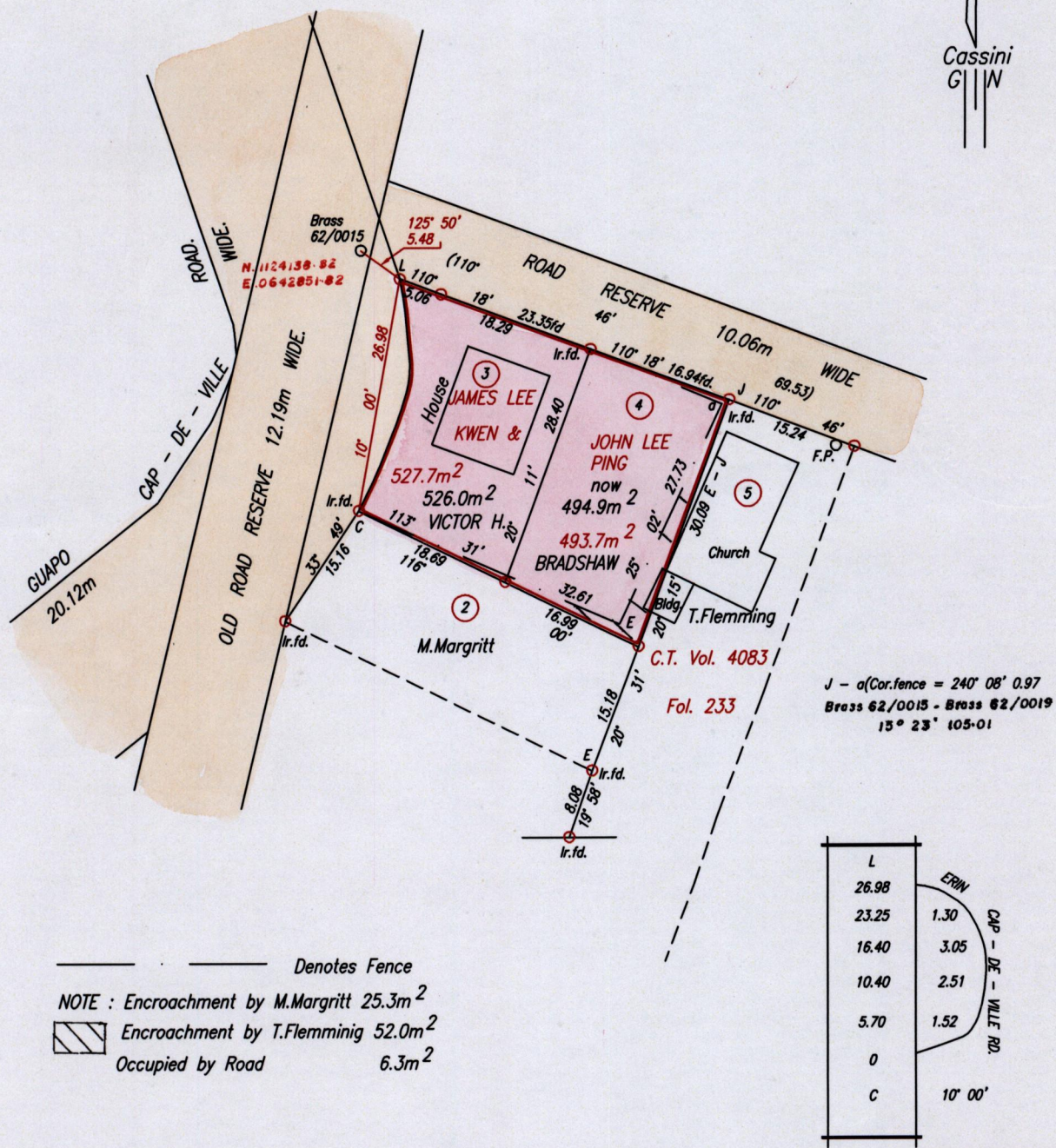

Approved *[Signature]*
 Director of Surveys 2009.12.11

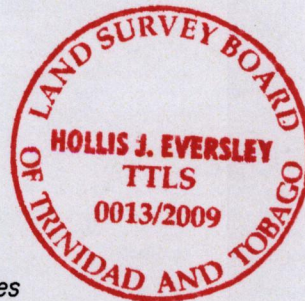

SCALE 1:750
 Distances are in Metres

○ Denotes Iron put except otherwise stated.
 Bearings are Cassini Grid based on Solar Observations.
 PLAN of 2 Parcels of land coloured pink in the Ward of La Brea
 Containing together one thousand and twenty point nine square metres.
 Surveyed by me, with due authority, in October, 2004 to be vested in Christina Hoyte
 In accordance with Regulation 25(1) of the Land Surveyors' Regulations 1998,
 I certify that this plan is correct.

Checked by *[Signature]* 25/8/09

Entered Trinidad & Tobago Land Surveyor 10th August 2009