

LOT#	Owner	C.T. Vol	Fol.
②	Merle Wheeler	3580	195
③	Olive Wheeler & Others	3580	201

References : L&S Bk. 1197 Fol. 24
 L&S Bk. 1227 Fol. 102

SCALE 1:2000
 Distances are in METRES

N.B Lot 1D to be amalgamated with lands belonging to the Seventh Day Adventists

INSET

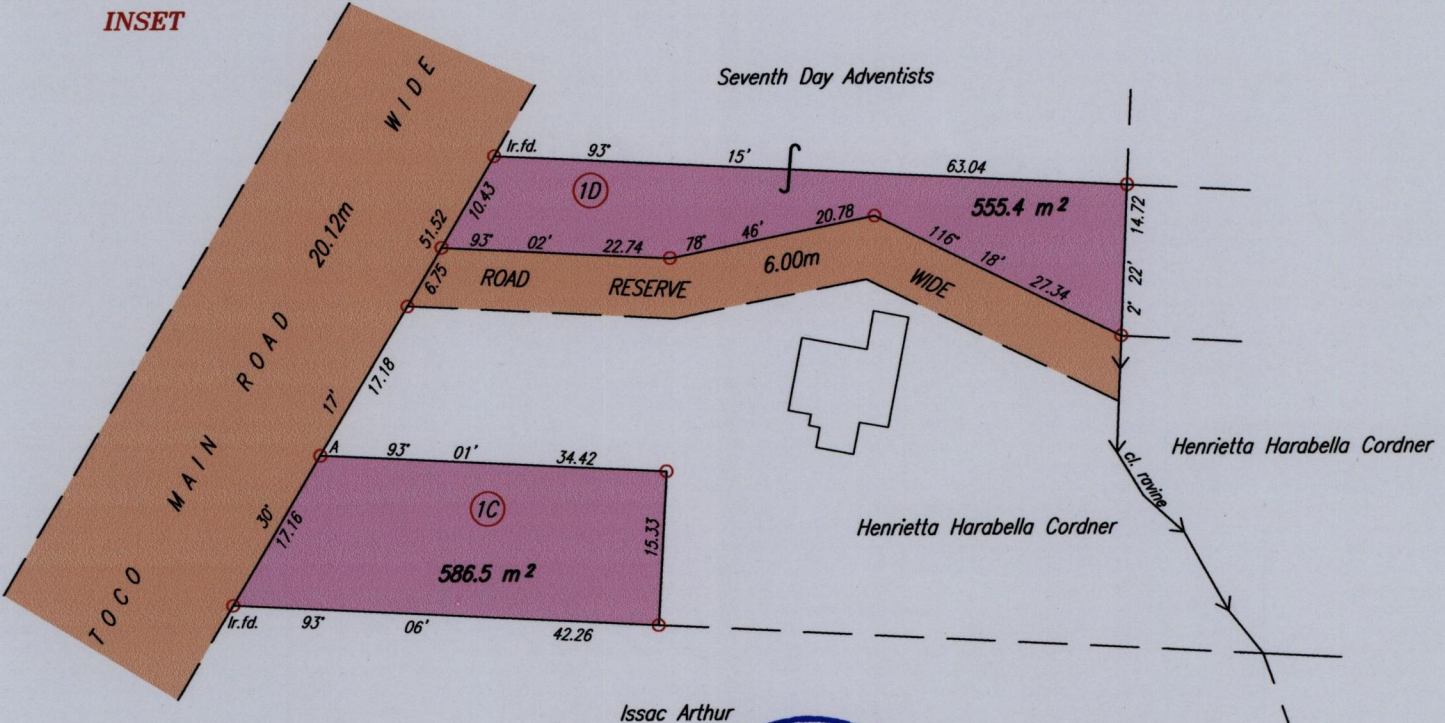

Coordinates of A (lr.pt.): 0724731mE, 1193933mN
 U.T.M. 20 WGS 84 (+/- 8.00m)
 G.P.S. Direct Observation

Approved *[Signature]*
 Director of Surveys 2010.3.26

SCALE 1:750

○ Denotes Iron put except where otherwise stated
 Distances are in METRES

Bearings are Cassini Grid based on Solar Observations
 PLAN of 2 Parcels of land coloured pink in the Ward of Toco
 Containing together one thousand one hundred and forty one point nine square metres
 Surveyed by me, with due authority, in December 2004
 In accordance with Regulation 25 (1) of The Land Surveyors' Regulations 1998,
 I certify that this plan is correct.

Checked by *[Signature]* 22/2/10
 Entered on

[Signature] TTLS
 Trinidad & Tobago Land Surveyor
 C:\LESS 2009\TRINIDAD\JUEANVILLE,JOHN.dwg
 FILE NO: J009