

R.P.O. Vol. 31 Fol. 237
C.T. Vol. 899 Fol. 31

Ward of Naparima
County of Victoria
Cadastral Sheet (G 8 N) 63 C
3/c

E 0669548
N 1128295
Reading taken with
Handheld G.P.S.
U.T.M. 20 Naparima
± 5m.

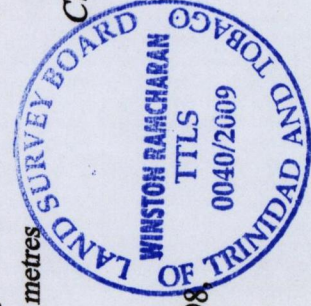
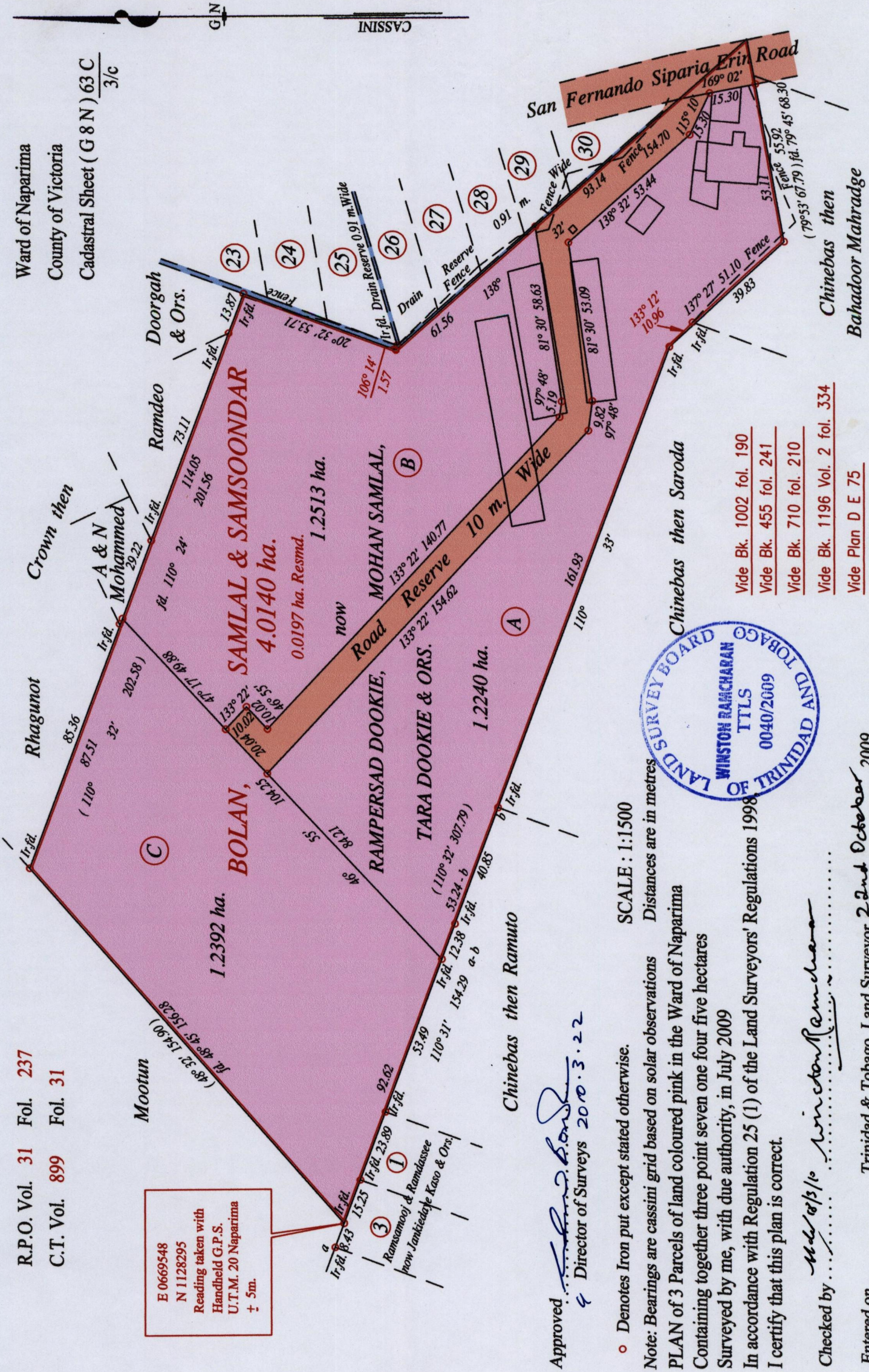

Approved: *[Signature]*
Director of Surveys 2003.22

o Denotes Iron put except stated otherwise. SCALE : 1:1500
 Note: Bearings are cassini grid based on solar observations Distances are in metres
 PLAN of 3 Parcels of land coloured pink in the Ward of Naparima
 Containing together three point seven one four five hectares
 Surveyed by me, with due authority, in July 2009
 In accordance with Regulation 25 (1) of the Land Surveyors' Regulations 1998
 I certify that this plan is correct.

Vide Bk. 1002 fol. 190
 Vide Bk. 455 fol. 241
 Vide Bk. 710 fol. 210
 Vide Bk. 1196 Vol. 2 fol. 334
 Vide Plan D E 75

Checked by *[Signature]*

Entered on Trinidad & Tobago Land Surveyor 22nd October 2009