

R.P.O Vol. 22 Fol. 577  
 C.T. Vol. 5136 Fol. 511

**Coordinates**

Ir.f.d B : N 1128117  
 E 678791

Error Statement : ±4m

Datum Definition : U.T.M. Zone 20 Naparima

Source : Magellan Hand Held GPS



Ward Sheet

Ward of Savana Grande  
 County of Victoria  
 Cadastral Sheet (G.9.0.), 64A  
 4/d  
 Parcel Address: Matoobar Trace,  
 Barrackpore

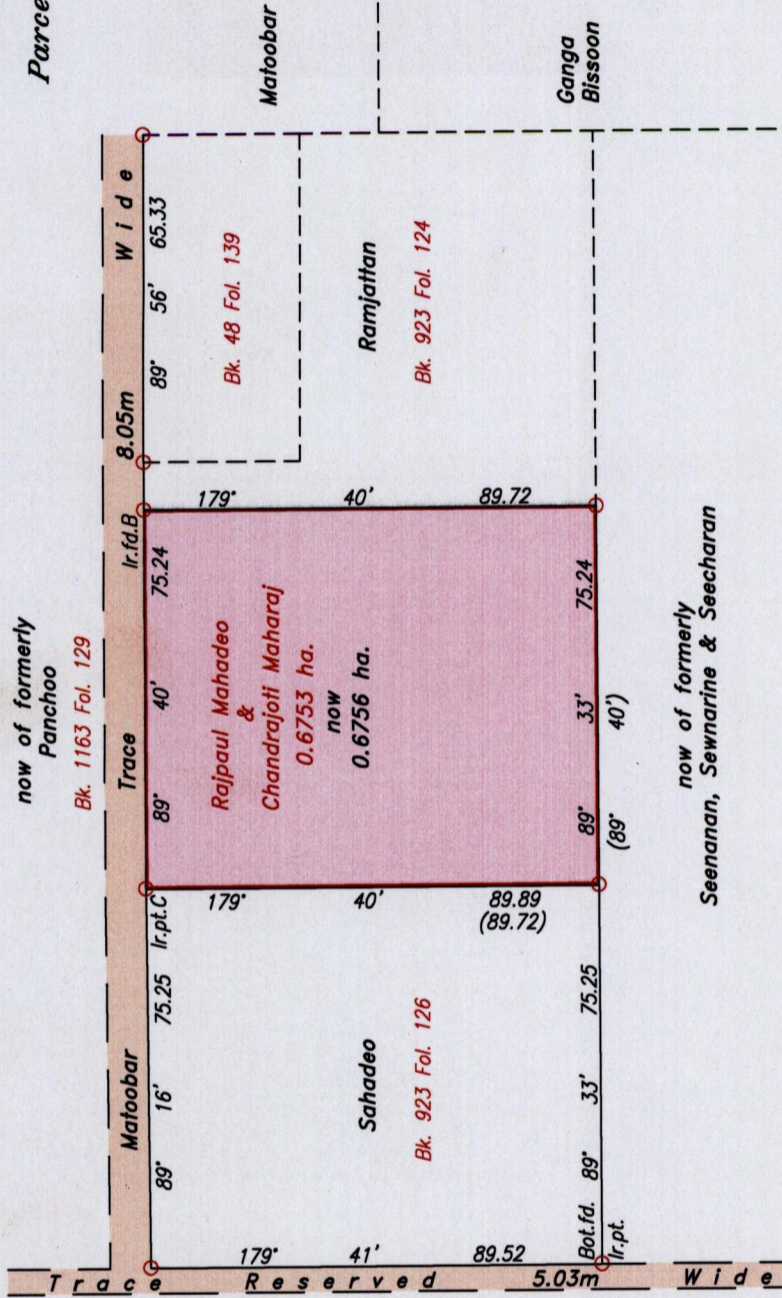

Approved...  
 Director of Surveys 2010.3.17

Ref: Bk. 923 Fol. 125  
 SCALE 1:1500

○ Denotes Iron found except otherwise stated.

Note: Bearings are U.T.M. grid based on solar observations.

Distances are in metres.

Plan of a Parcel of land coloured pink in the Ward of Savana Grande  
 Containing zero point six seven five six hectares

Surveyed by me, with due authority, in October 2009

In accordance with Regulation 25(1) of the Land Surveyors' Regulations 1998,

I certify that this plan is correct.

Checked by...  
 Mohd 2/1/10

.....  
 Lenny W. Manomansingh

Entered .....  
 Trinidad & Tobago Land Surveyor .....2010



1333

112