

Ward of Siparia

County of St. Patrick

Cadastral Sheet (G. 13. N.) $\frac{73 C}{1/a}$

R.P.O. Vol. 103 fol. 599

C.T. Vol. 1160 fol. 213

Vol. 5109 Fol. 211

Bk. 393 fol. 309

Bk. 886 fol. 266

Bk. 952 fol. 131

Bk. 935 fol. 27

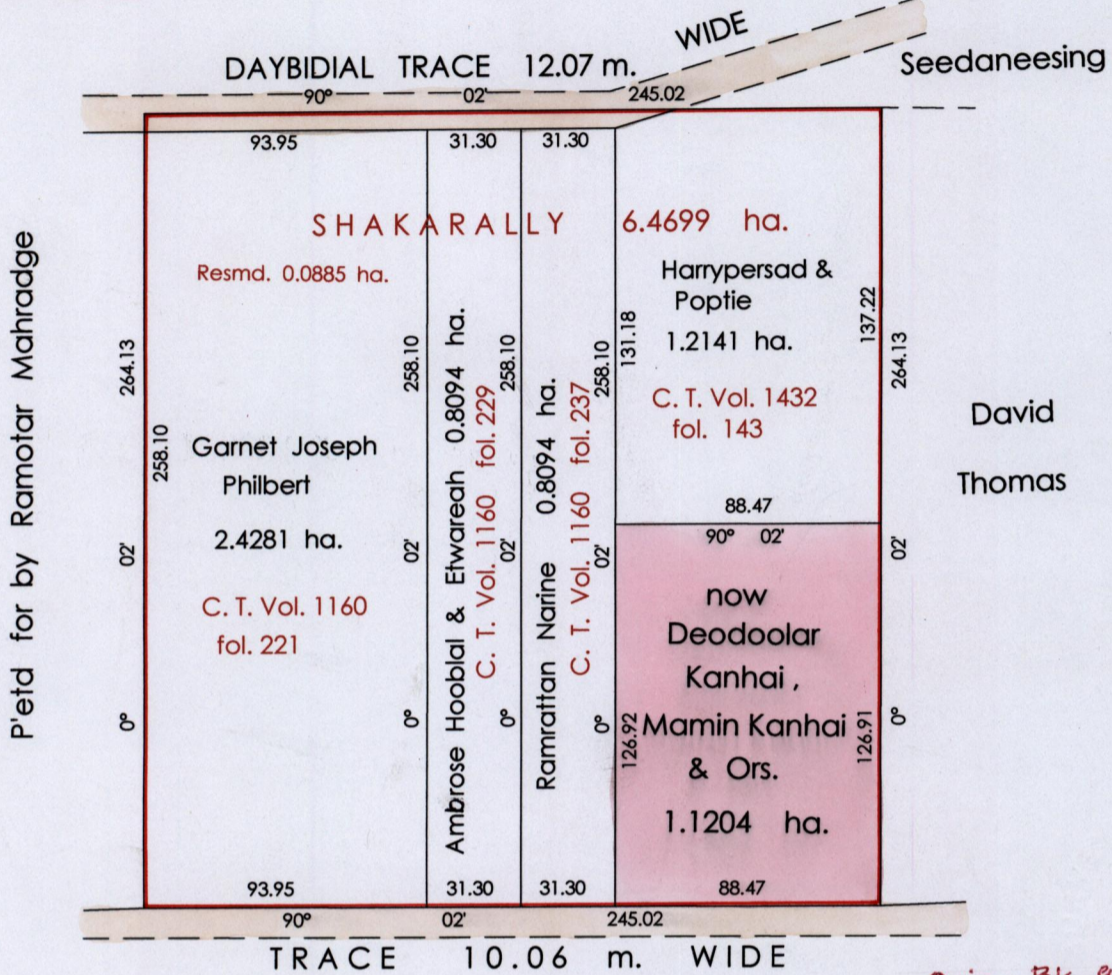

Orig - Bk. 952 : 131

Approved *[Signature]*
 Director of Surveys
 20070423



SCALE : 1 : 2500

Note: Bearings are cassini grid based on solar observations Distances are in metres

This is a true copy of a diagram of six point four six nine nine hectares ,originally transferred to SHAKARALLY showing a portion coloured pink and containing one point one two zero four hectares being the remainder after one resumption & four previous transfers of another portion of land. In accordance with Regulation 25 (1) of the Land Surveyors' Regulations 1998, I certify that this plan is correct.

Checked by *[Signature]*

Entered on Trinidad & Tobago Land Surveyor *[Signature]*2007

Original Bl. 935; 27

MINISTRY OF AGRICULTURE
LAND AND FORESTRY DIV.
05 MAR 2007
LANDS A/C

1386/89