

R.P.O. Vol. 39 Fol. 635

C.T. Vol. 604 Fol. 21

62F

Cadastral Sheet G.11.B. 1/b,2/a

Ward of La Brea

County of St. Patrick

Vide P.Lan A.D. 47

Bk. 711 Fol. 244

Vol. 5050 Fol. 237

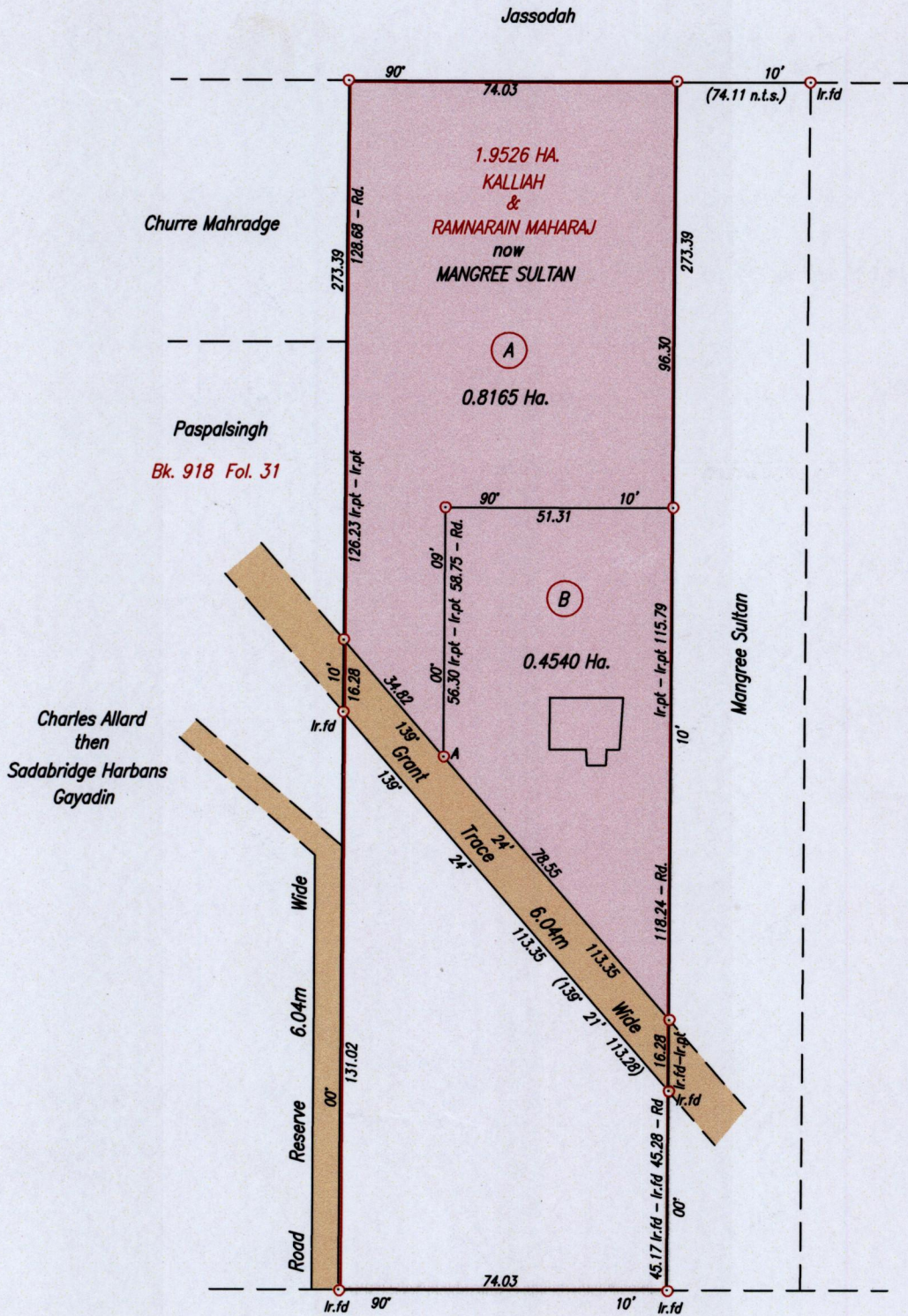

Orig - Bk. 461 : 178

Approved

Arthur Jugbundhun

Arthur Jugbundhun

Director of Surveys 2008. 7.25

Point A

Co-ordinates obtained by Hand Held G.P.S. (WGS84 U.T.M. Zone 20)

Accuracy ± 6m

E 654989.00m

N 1127333.00m

○ Denotes Iron put except otherwise stated
 Bearings are Cassini Grid based on Solar Observations
 Plan of 2 Parcels of land coloured pink in the Ward of La Brea
 Containing together one point two seven zero five hectares
 Surveyed by me, with due authority, on 26th October 2007
 In accordance with Regulation 25 (1) of the Land Surveyors' Regulations 1998,
 I certify that this plan is correct.

Entered on

Ganeshdath Ramcharitar

Checked by Trinidad & Tobago Land Surveyor 2008

SCALE 1/1500

Distances are in metres



A. VOL. 5050 FOL. 241 RAWLE SIRIDE

B. VOL. 5050 FOL. 43 BALKARAN, KEMRAI & ORS.

