

Vol. 5065 Fol. 533

R.P.O. Vol. 56

C.T. Vol. 4591

Fol. 333

Fol. 43

Cadastral Sheet D.5.P. 35A
2/c

Ward of Tamana

County of St. Andrew

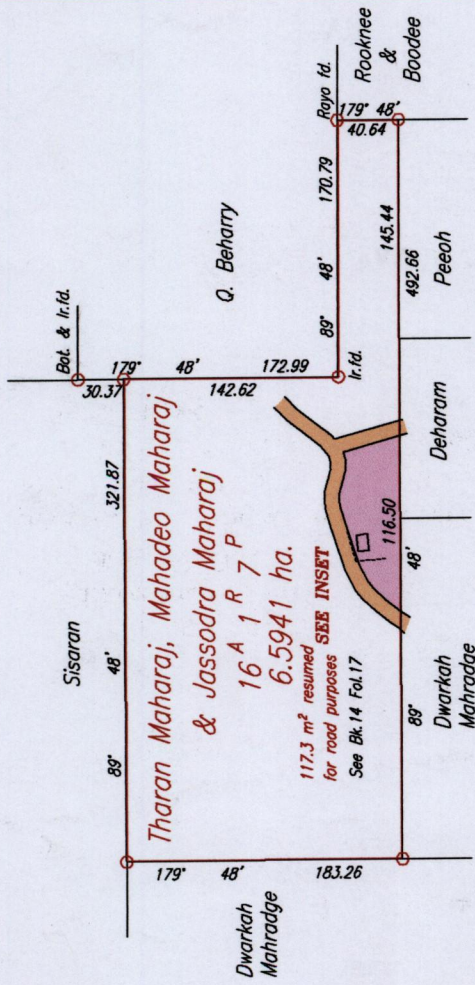

SCALE 1:5000

Distances are in METRES

Approved
Director of Surveys
2007.8.26

○ Denotes Iron put except where otherwise stated

Bearings are Cassini Grid based on Solar Observations

PLAN of a Parcel of land coloured pink in the Ward of Tamana

Containing three thousand three hundred and ninety four point five square metres

Surveyed by me, with due authority, in March 2005

In accordance with Regulation 25 (1) of The Land Surveyors' Regulations 1998,

I certify that this plan is correct.

Checked by
K. S. S. S.

Entered on

Trinidad & Tobago Land Surveyor

24 July 2007
FINE NO. M051

INSET

A - B	48°	37'	5.51
C - D	81°	27'	5.07
D - E	95°	36'	4.59
F - G	87°	57'	7.91
G - H	76°	14'	4.79

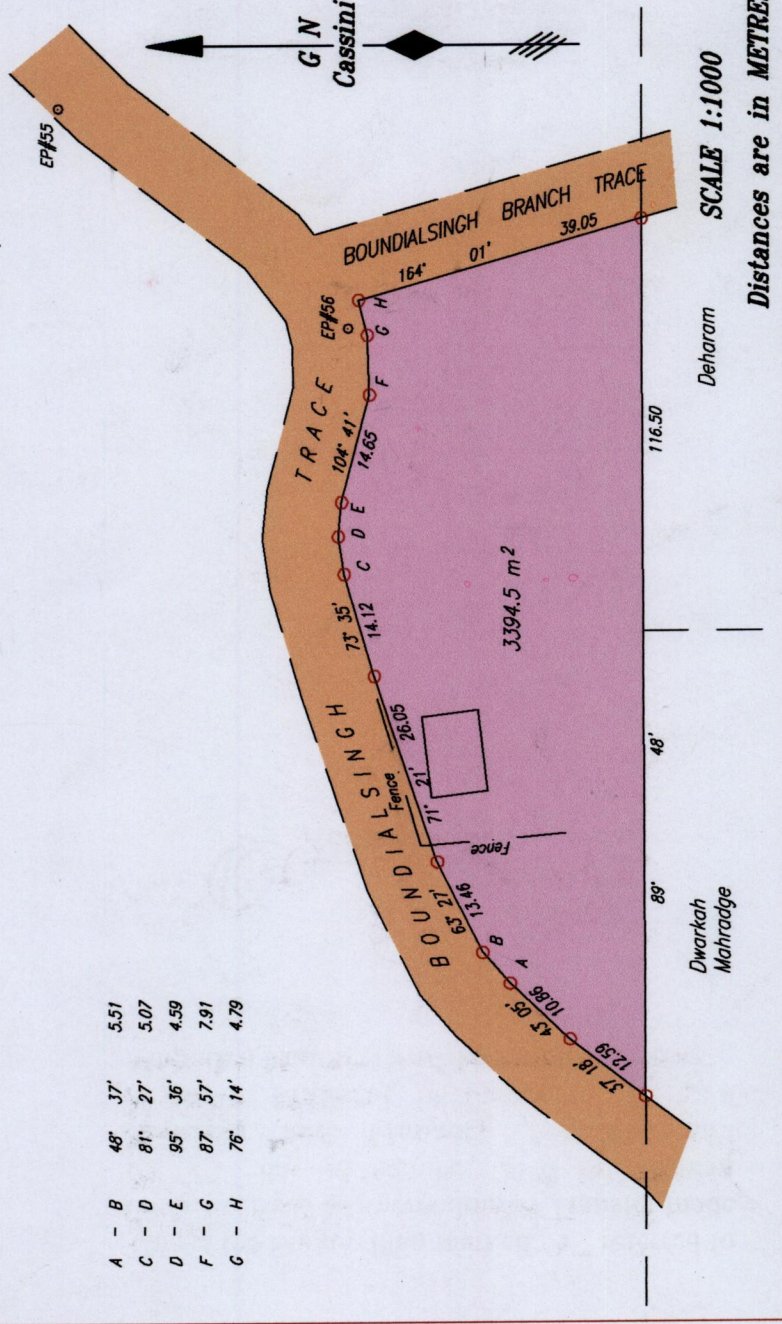

SCALE 1:1000

Distances are in METRES

Orig - Bk. 7 : 165

References:
Bk. 7 Fol. 165
Plan E.B. 19
PK. 71

Mahadeo + Jassodra Maharaj



55

1386/144

Original Survey BK. 7 fol. 165

Cover no. 1
pass.

“Y”

This is the Survey Plan marked “Y” referred to in the prefixed Memorandum of Transfer made the 7th day of October 2008 by **Tharan Maharaj and Mahadeo Maharaj and Jassodra Maharaj** in favour of the said **Mahadeo Maharaj and Jassodra Maharaj**.

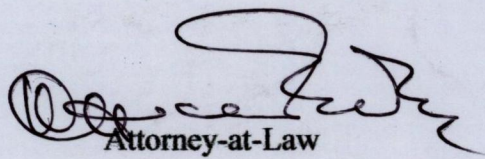

Attorney-at-Law

