

REMAINING PORTION

RPO Vol 54 Fol. 475

C.T. Vol. Fol.

Cadastral Sheet G.5.A. 54E

Ward of Savana Grande

County of Victoria

Vol. 4878 Fol. 317

Ref : Bk 358 fol 158

Bk 716 fol 144

Bk 717 fol 136

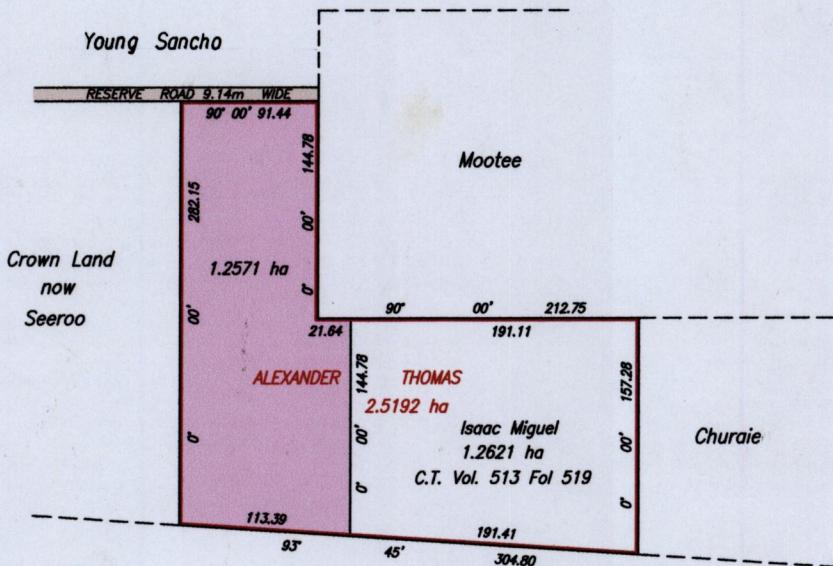

New Grant Estate now CARONI 1975 Ltd

Orig - Bk. 717 : 136

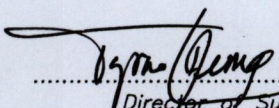

Approved   
 Director of Surveys  
 2008-2-13

CHANDRABOSE & KRISHA SOOKDEO,  
 DAVID PRAKASH & SHIVA SEECHARAN

SCALE 1 / 5000  
 Distances are in metres

Bearings are Cassini Grid, based on Solar Observations

This is a true copy of a diagram of two point five one nine two hectares originally transferred to Alexander Thomas, showing a portion coloured pink containing one point two five seven one hectares

being the remainder after one (1) transfer of another portion of the land

In accordance with Regulation 25 (1) of the Land Surveyors' Regulations 1998,

I certify that this plan is correct.

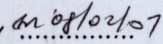
Checked by  10/02/07

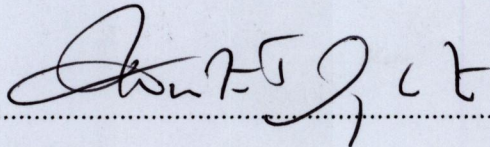
  
 \_\_\_\_\_

Entered on .....

Trinidad & Tobago Land Surveyor 12-12-2007

Original Bl. 717:136

Original Survey BK. 330:158

