

25F
 Cadastral Sheet E.2.A. 3/b
 Ward of Turure
 County of St. Andrew
 Vide : Bk. 871 Fol. 95
 Bk. 950 Fol. 98
 Bk. 1280 Fol. 200

REMAINING PORTION

R.P.O. Vol. 2 Fol. 570
 C.T. Vol. 1099 Fol. 47

VOL. 5045 FOL. 311

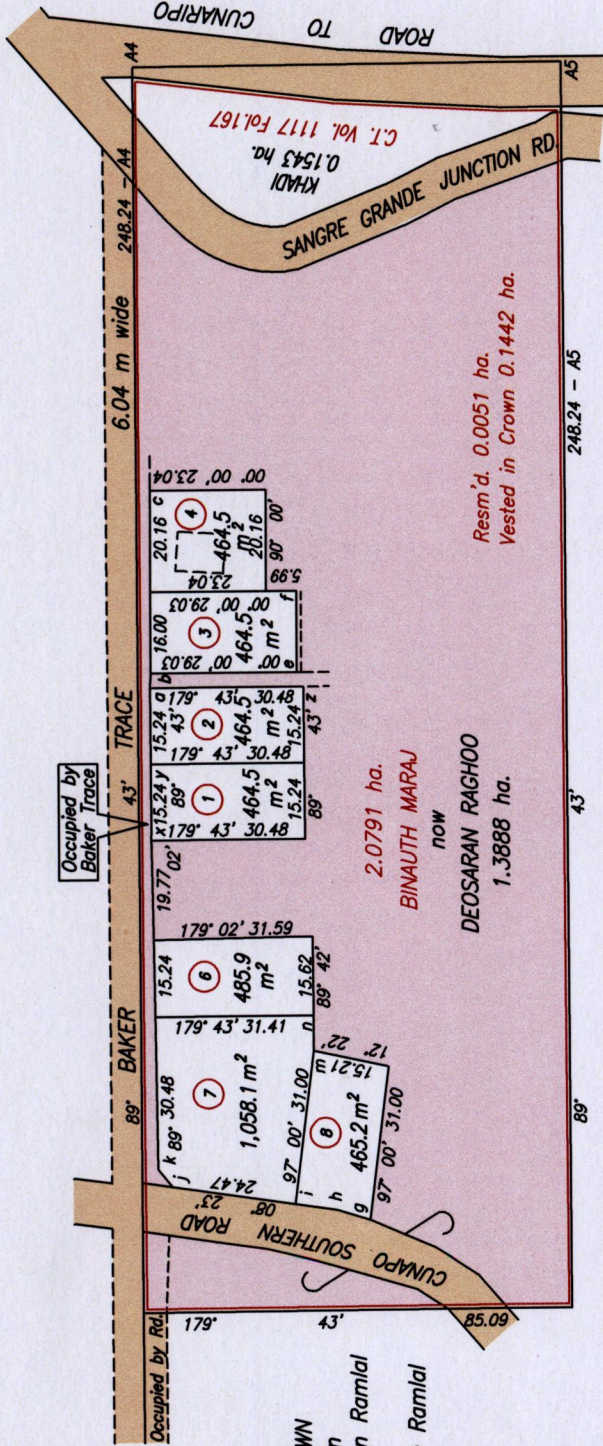
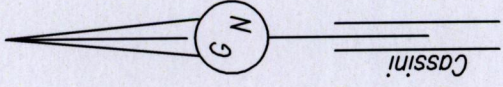

CROWN
 then
 Ramkissoon Ramlal
 &
 Phulmanie Ramlal

2.0791 ha.
 BINNAUTH MARAJ
 now
 DEOSARAN RAGHOO
 1.3888 ha.

Resm'd. 0.0051 ha.
 Vested in Crown 0.1442 ha.

DEOSARAN, DANARAM & RAJESH RAGOO

CROWN then I.F. SPRINGER

Orig - Bk. 871:94

SCALE 1/1500
 Distances are in metres

Legend	Sta.	Bearing	Dist
	b-c	90° 00'	36.16
	a-b	91° 26'	3.00
	e-f	90° 00'	16.00
	g-h	17° 03'	6.82
	h-i	08° 35'	8.43
	j-k	50° 55'	4.67
	m-n	89° 43'	7.05
	z-e	64° 14'	3.16
	A4 - A5	179° 43'	85.09

Lot 1	ANJORA MAHABIR & S. SINGH	C.T. Vol. 4204	Fol. 509
Lot 2	ANJORA MAHABIR & S. DHANPAT	C.T. Vol. 4204	Fol. 517
Lot 3	RODNEY BHARAT & ORS.	C.T. Vol. 4550	Fol. 545
Lot 4	RODNEY BHARAT & ORS.	C.T. Vol. 4550	Fol. 531
Lot 6	KAMLAL RAGOO - ALI	C.T. Vol. 4874	Fol. 153
Lot 7	MALA SOODEEN	C.T. Vol. 4874	Fol. 145
Lot 8	KAMILA RAGOO - ALI	C.T. Vol. 4874	Fol. 161



Approved *[Signature]*
 Director of Surveys
 2008 5.18

Bearings are based on solar observations
 This is a true copy of a diagram of two point zero seven nine one hectares originally transferred to Binauth Maraj, showing a portion coloured pink and containing one point three eight eight eight hectares being the remainder after eight previous transfers and two resumptions of another portion of the land. In accordance with Regulation 25(1) of the Land Surveyors' Regulations 1998, I certify that this plan is correct.

[Signature]
 Ramchand Prasad

Entered on
 9/5
 Checked by: *[Signature]* Trinidad & Tobago Land Surveyor 2008

51/816/

Original Bk. 1280:200



1418/15.