

R.P.O. Vol. 166 Fol. 215
C.T. Vol. 2227 Fol. 189
Vol. 5067 Fol. 521

Ward of La Brea
County of St. Patrick
Cadastral Sheet (G 6 N) $\frac{62.C}{3/d}$

G N
CASSINI

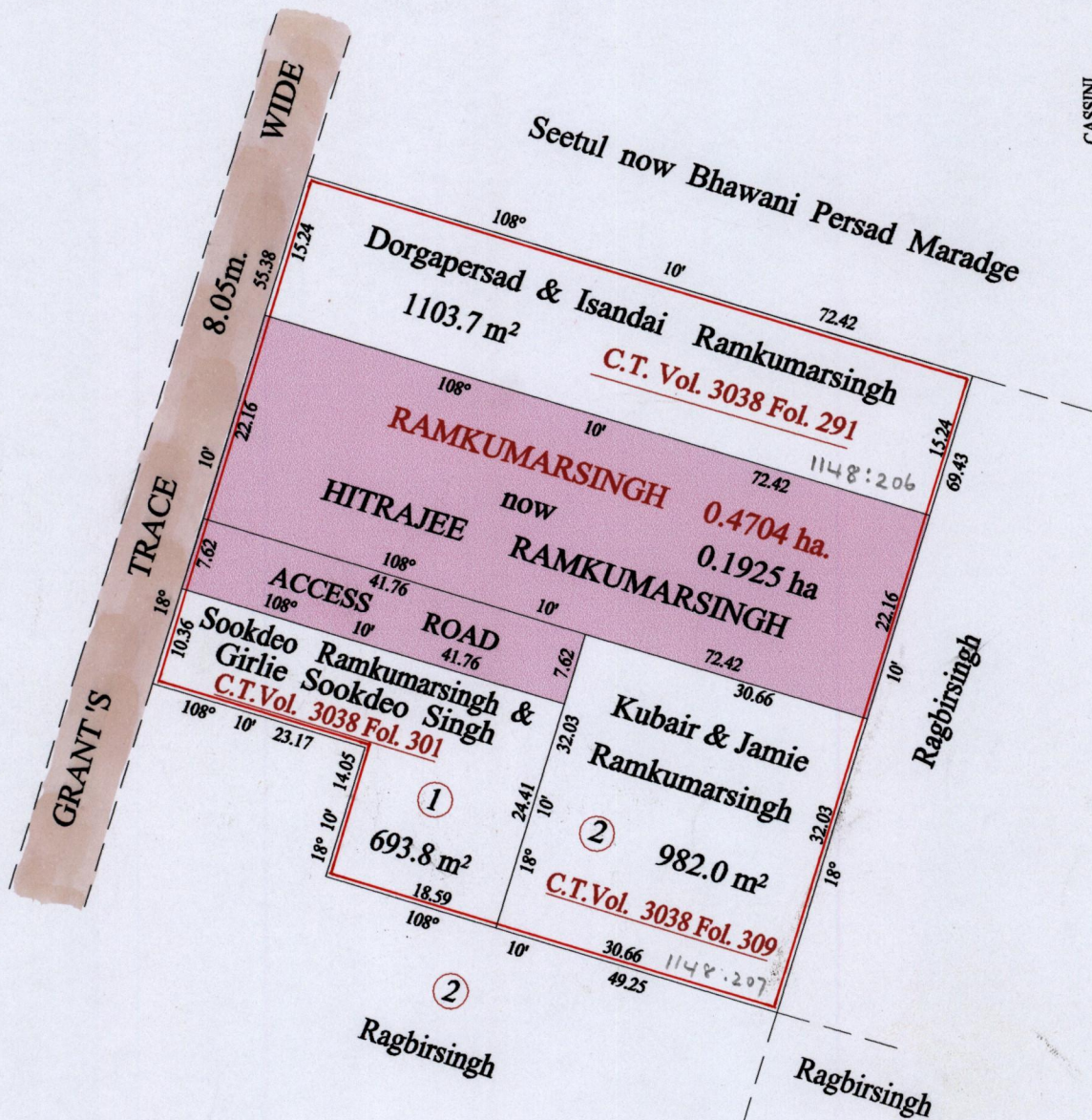

Orig - Bk. 999:142

999:142

Hitrajee Ramkumarsingh &
Saisnarine Ramkumarsingh
Vide Bk. 1148 fol. 207

Approved *[Signature]*
Director of Surveys
2007.8.6

SCALE : 1:750

Note: Bearings are cassini grid based on solar observations

Distances are in metres

This is a true copy of a diagram of zero point four seven zero four hectare, originally transferred to RAMKUMAR SINGH &, shewing a portion coloured pink and containing zero point one nine two five hectare being the remainder after three (3) previous transfers of another portion of the land. In accordance with Regulation 25 (1) of the Land Surveyors' Regulations 1998, I certify that this plan is correct.

Checked by *[Signature]* 21/7/07

Entered on Trinidad & Tobago Land Surveyor P. 01 2007



Original Bk. 1148 : 207

VI-2007-11-201

