

R.P.O. Vol. 108 / Fol. 467

Cadastral Sheet 2/c, 2/d, 4/a, 4/b, G12H86.13E

C. of T. Vol. 1151 / Vol. 213

Ward of Siparia

Vol. 5158 / Fol. 117

County of St. Patrick

Previous Remaining Portion Plan filed in Vol.1611 Fol.115

Vide L&S Bk.964 Fol.57

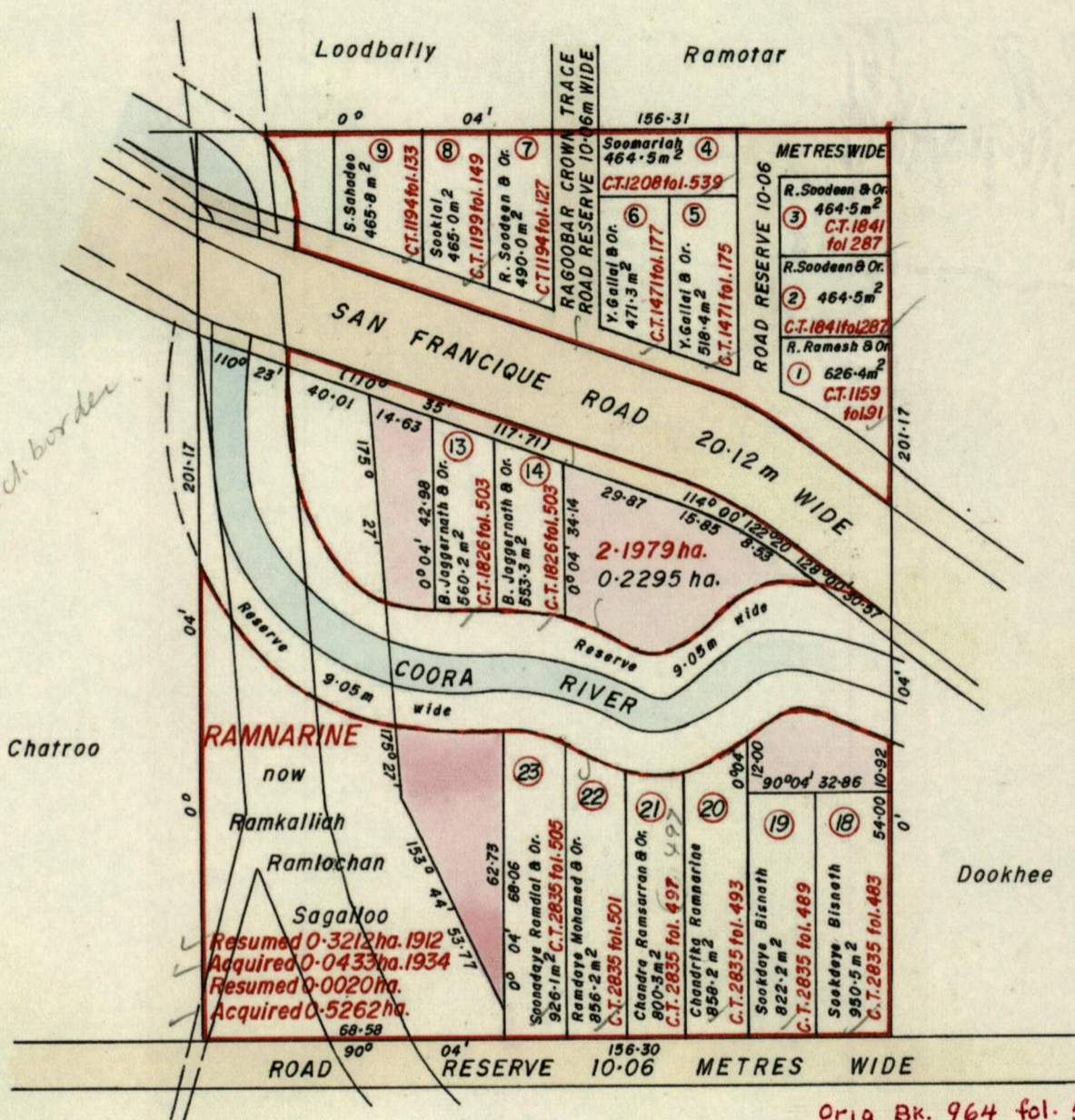

Orig BK. 964 fol. 57

Approved

[Signature]
Director of Surveys
98.12.11

SCALE 1/1500

Note: To obtain compass bearings ^{add} 3 minutes _{subtract}

Distances are in metres

This is a true copy of a diagram of two point one nine seven nine hectares originally transferred ~~granted~~ to RAMNARINE, shewing a portion coloured pink and containing point two two nine five of a hectare being the remainder after two acquisitions, two resumptions & seventeen previous transfer of another portion of the land. 14(2)(d) of the Land Surveyors Ordinance 1952 the dividing lines having been run in conformity with Rule 76 under Sec. 21(1) of Cap. 27, No. 2 and duly certified by the Director of Surveys.

Checked by *[Signature]* 98.12.11

Entered on

[Signature]
Land Surveyor, Trinidad, 8th Sept 1998

