

1289/226

R.P.O. Vol. Fol.
C.T. Vol. 3029 Fol. 105
U.P.R.N. No.:
Vol. 5174 Fol. 21.

Ward of Naparima
County of Victoria
Cadastral Sheet G.9.B. 64A
1/b

G.N.
Cassini

Reference: Bk.1149 Fol.6

| Legend | | |
|------------------------------------|----------|-------|
| a - b | 150° 31' | 4.62 |
| c - d | 155° 35' | 4.58 |
| R ₅ - Q ₅ | 93° 44' | 6.72 |
| P ₅ - O ₅ | 349° 08' | 21.86 |
| (P ₅ - O ₅) | 348° 38' | 21.89 |
| e - X | 69° 08' | 1.64 |
| f - Y | 66° 38' | 2.06 |
| Y - N ₅ | 154° 32' | 67.92 |
| N ₅ - M ₅ | 190° 16' | 29.77 |
| (N ₅ - M ₅) | 190° 35' | 29.77 |

Woodford
Dale
Estate
(Caroni (1975) Limited)

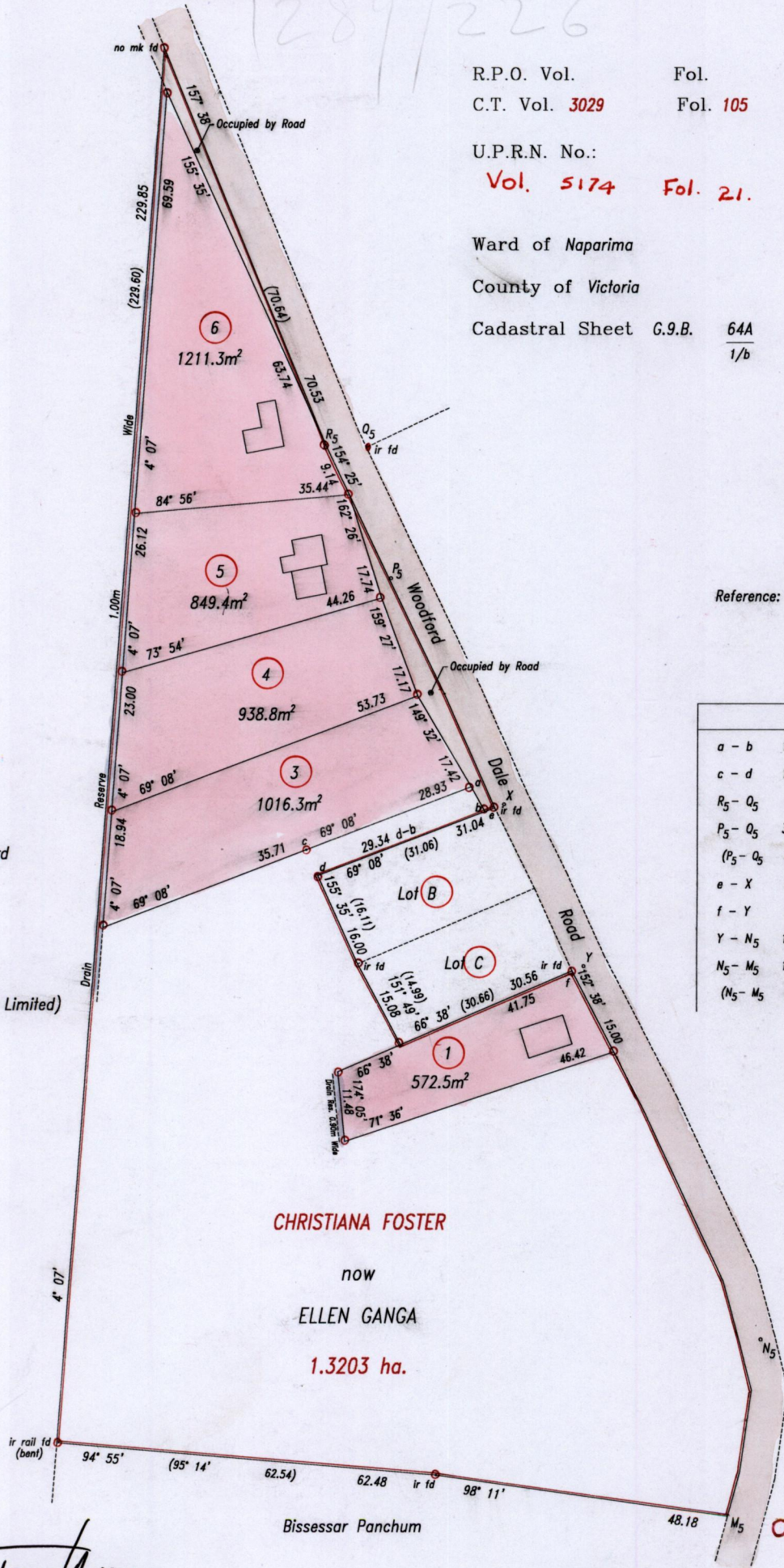

CHRISTIANA FOSTER

now
ELLEN GANGA

1.3203 ha.

Bissessar Panchum

Orig - Bk.1149:6

Approved
[Signature]
Director of Surveys
2004.6.28

SCALE 1:1000

Distances are in metres

○ Denotes iron put except otherwise stated

Bearings are Cassini Grid based on Solar Observations

PLAN of 5 parcels of land coloured pink in the Ward of Naparima
Containing together four thousand five hundred and eighty eight point three square metres
Surveyed by me, with due authority, in August 2002

In accordance with Regulation 25(1) of the Land Surveyors' Regulations 1998, I certify that this plan is correct.

Checked by *[Signature]*
Entered

[Signature]
Trinidad & Tobago Land Surveyor 26/5/2004



- (1)
- (3) Vol. 5174 Fol. 25 Kelly George Peters & Joel Peters.
- (4) Vol. 5174 Fol. 33 Kelly George Peters & Joel Peters.
- (5)
- (6)

1 - JUN 2004
Lands and
Surveys

1259/2004
1332/2005