

No 25406

Vol. 4987 Fol. 225

R.P.O. Vol. 92.

Fol. 137.

Ward of Tamana.

County of St. Andrew.

C.T. Vol.

Fol.

Cadastral Sheet E. I. Q

35B
17d

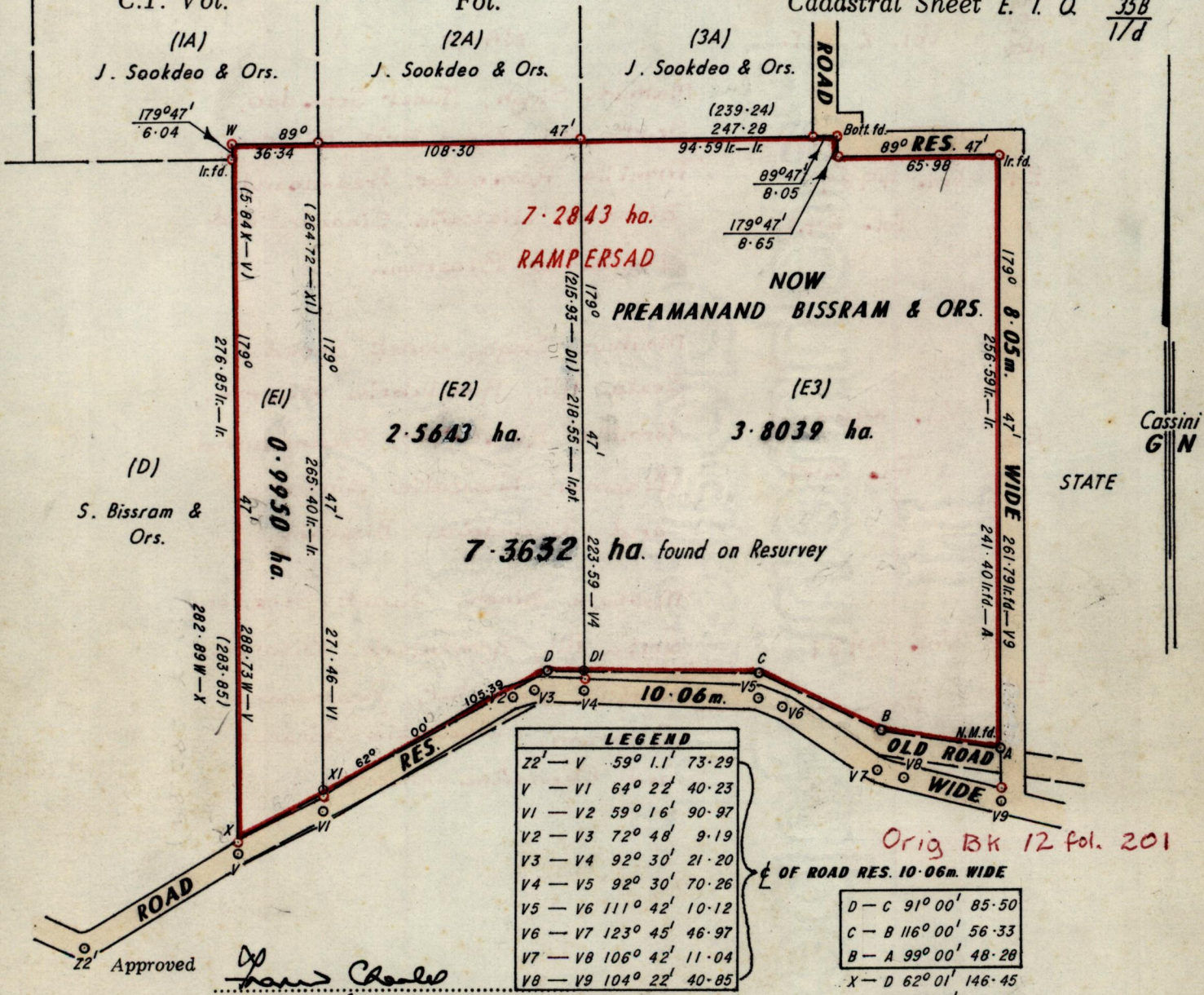

o Denotes Iron put except otherwise stated.
Note: To obtain compass bearings add/minutes

SCALE 1:2500.

Distances are in metres.

PLAN of 3 Parcels of land coloured pink in the Ward of Tamana. Containing together seven point three six three two hectares. Surveyed by me, with due authority, in September 1989. I certify that I have complied with rule 76 under section 14(2)(d) of the Land Surveyors' Ordinance 1952, and that this plan is correct.

Checked by *[Signature]* *[Signature]*

Entered Land Surveyor, Trinidad 10th October 1989 and Tobago

Rampersad

7.2843 ha

Red

Original Survey Bk 12 Fol. 201

7.41715 ha
found on Resurvey
Black

Lot No.	Vol. & c.T.	NAME
E1	Vol. 4987 Fol. 243	Mathura Singh, Janet Sookdeo, Seeta Ali, Ramdularie Bissram, Armilla Ramoutar, Preamanand Bissram, Lilawatie Sinanan and Deonarine Bissram.
E2	Vol. 4987 Fol. 247	Mathura Singh, Janet Sookdeo, Seeta Ali, Ramdularie Bissram, Armilla Ramoutar, Preamanand Bissram, Lilawatie Sinanan and Deonarine Bissram.
E3	Vol. 4987 Fol. 249	Mathura Singh, Janet Sookdeo, Seeta Ali, Ramdularie Bissram, Armilla Ramoutar, Preamanand Bissram, Lilawatie Sinanan and Deonarine Bissram.