

R.P.O. Vol. 205 Fol. 75
C.T. Vol. 1315 Fol. 419
Vol. 5142 Fol. 107
Original Survey: Bk. 415 Fol.157

Ward of Siparia
County of St. Patrick
Cadastral Sheet $\frac{74A}{1/c\&3/a}$ (G.19.E)

Ref: Bk. 1273 Fol. 61
Bk. 707 Fol. 169

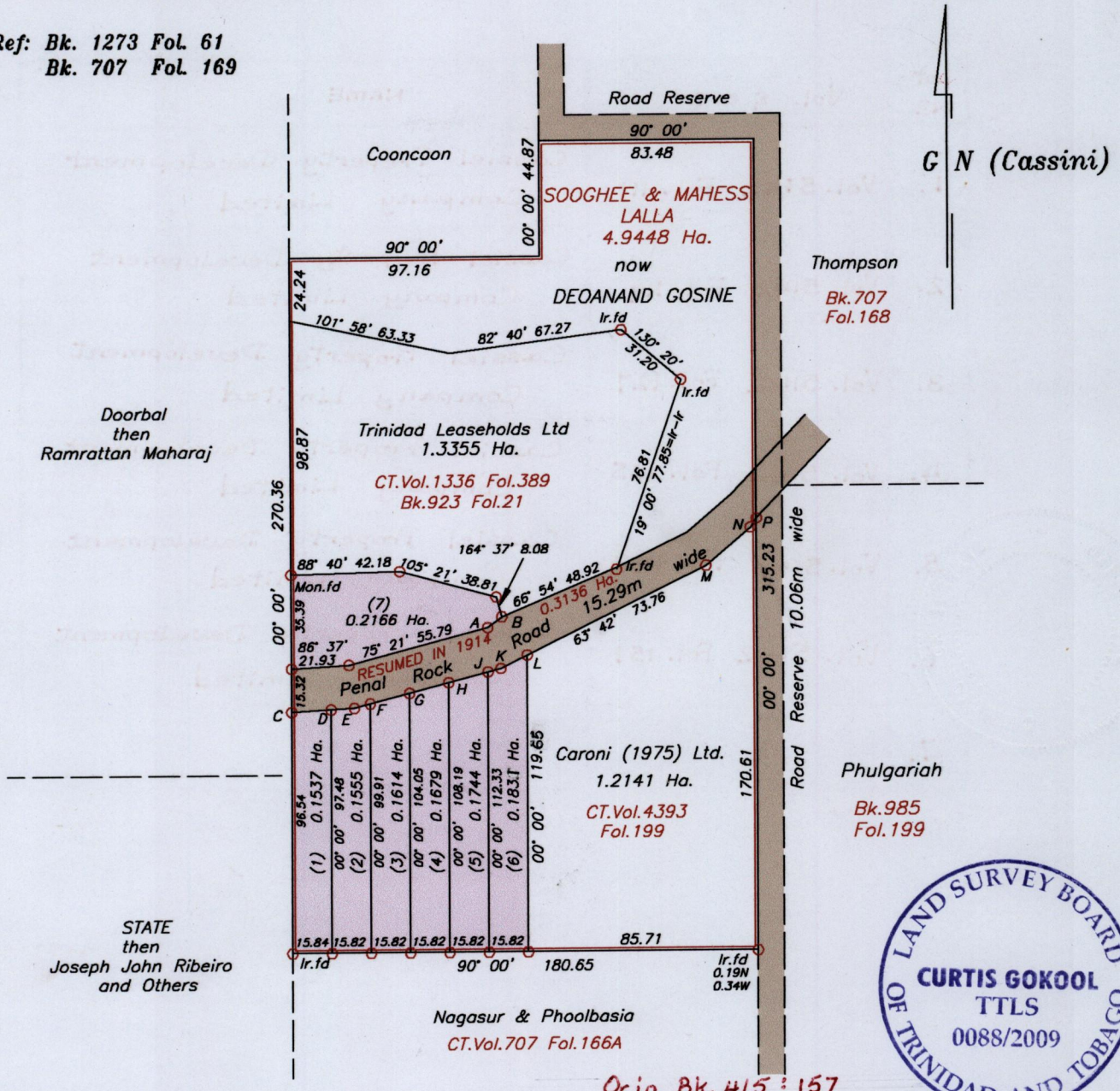

Orig Bk. 415 : 157

C= N1119195 (U.T.M)
E 674912

| | | |
|-----|---------|-------|
| A-B | 63° 42' | 6.55 |
| C-D | 86° 37' | 15.88 |
| D-E | 86° 37' | 8.46 |
| E-F | 75° 21' | 7.62 |
| F-G | 75° 21' | 16.35 |
| G-H | 75° 21' | 16.35 |
| H-J | 75° 21' | 16.35 |
| J-K | 75° 21' | 2.19 |
| K-L | 63° 42' | 15.28 |
| M-N | 49° 27' | 22.76 |
| N-P | 33° 18' | 4.17 |

Approved *[Signature]*
 Director of Surveys
 2009.5.18

Notes: U.T.M 20 Naparima (GPS +/- 3.0m)
 ○ Denotes Iron put unless otherwise stated
 Bearings are Cassini Grid based on solar observations

SCALE 1 : 2500
 Distances are in METRES

PLAN of 7 Parcels of land coloured pink in the Ward of Siparia.
 Containing together one point two one two six hectares.
 Surveyed by me, with due authority, in Dec 2001 & Feb 2009.
 In accordance with Regulation 25 (1) of the Land Surveyors' Regulations 1998,
 I certify that this plan is correct.

Checked by *[Signature]* *[Signature]*
 Entered on Trinidad and Tobago Land Surveyor February 12 2009

500

| Lot No | Vol. & c.T. | NAME |
|--------|--------------------|--|
| 1. | Vol. 5142 Fol. 111 | Cassiel Property Development Company Limited |
| 2. | Vol. 5142 Fol. 119 | Cassiel Property Development Company Limited |
| 3. | Vol. 5142 Fol. 127 | Cassiel Property Development Company Limited |
| 4. | Vol. 5142 Fol. 135 | Cassiel Property Development Company Limited |
| 5. | Vol. 5142 Fol. 143 | Cassiel Property Development Company Limited |
| 6. | Vol. 5142 Fol. 151 | Cassiel Property Development Company Limited |
| 7. | | |

