

Vol 5055 Fol 243
R.P.O. Vol. 14 Fol. 449
C.T. Vol. 1254 Fol. 321

Cadastral Sheet G.13.B. 63C & 63F
Ward of Naparima 3/c 1/b
County of Victoria.

Vide Bk. 1289 fol. 228
Vide Bk. 903 fol. 152
Plan AE 63

Debe Village

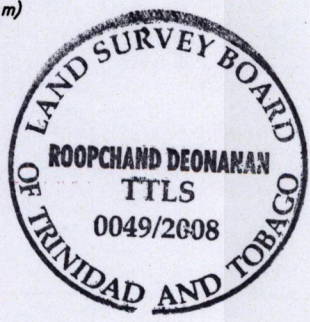
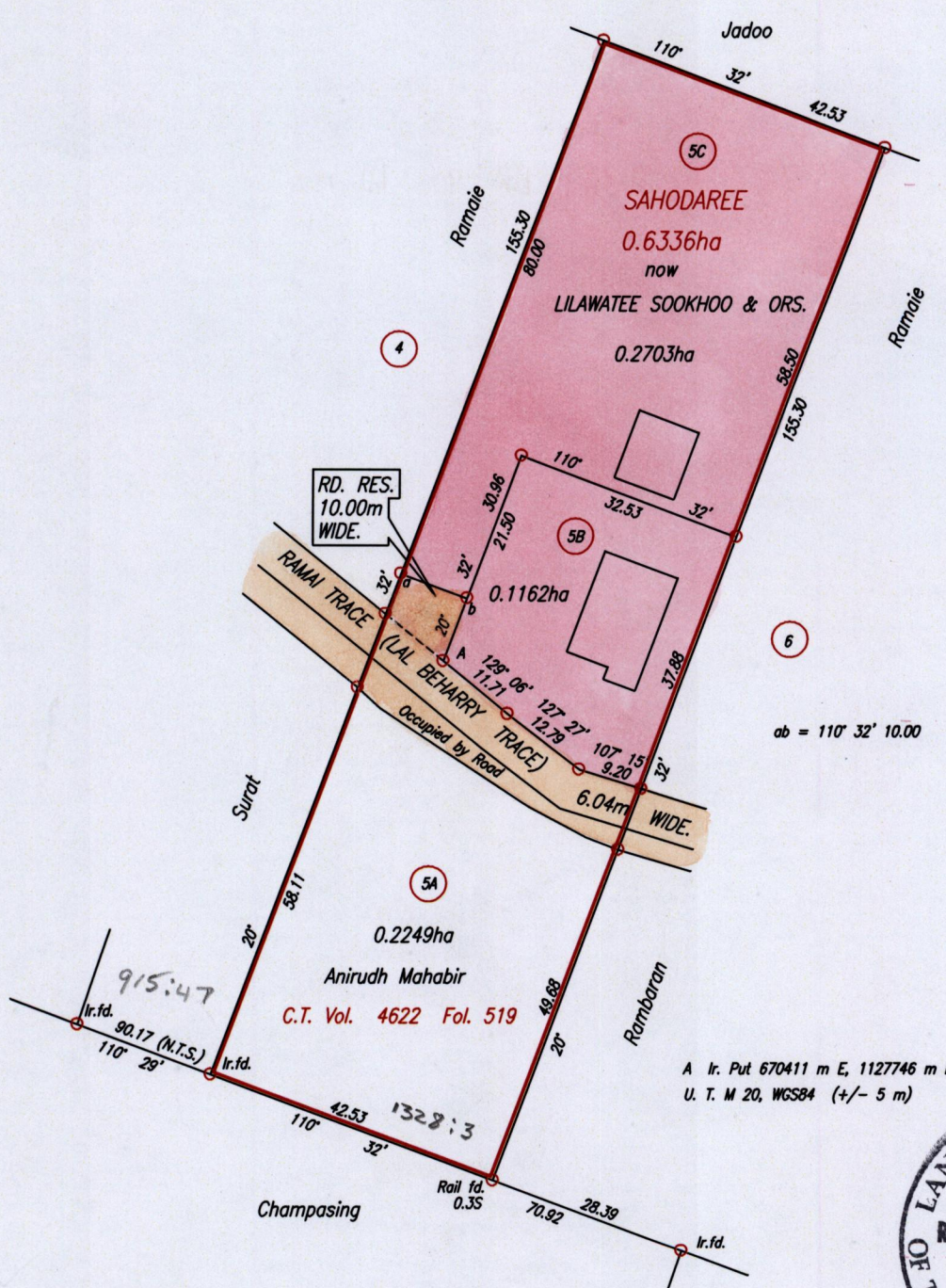

Approved *[Signature]*
Director of Surveys 2008 7-9

Orig - Bk. 903:152

SCALE 1:1000
Distances are in Metres

Note : Coordinates obtained from hand held G.P.S.
o Denotes Iron put except otherwise stated.
Bearings are based on Solar Observations.(Cassini Grid.)
PLAN of 2 Parcels of land coloured pink in the Ward of Naparima
Containing together zero point three eight six five hectare.
Surveyed by me, with due authority, in May, 2007
In accordance with Regulation 25(1) of the Land Surveyors' Regulations 1998,
I certify that this plan is correct.

Checked by *[Signature]* *[Signature]*
Entered on Trinidad & Tobago Land Surveyor *25th January* 2008
PATH = EV700 C:\Drawings08\NSookoo2.dwg.

~~Original BK. 1328 : 3~~

LOT No.	CT. VOLUME & FOLIO	NAMES
58		
50	- Vol 5055 . fol 251	VIJAY RAMAI

Original Survey BK. 903 fol. 152

