

Process ID 81020

REMAINING PORTION

R.P.O. Vol. 64 Fol. 555

C.T. Vol. 1900 Fol. 125

Vol. 5039 fol. 421

Ward of Siparia

County of St. Patrick

Cadastral Sheet (G 13 G) 63.F. 1/d

GN

CASSINI

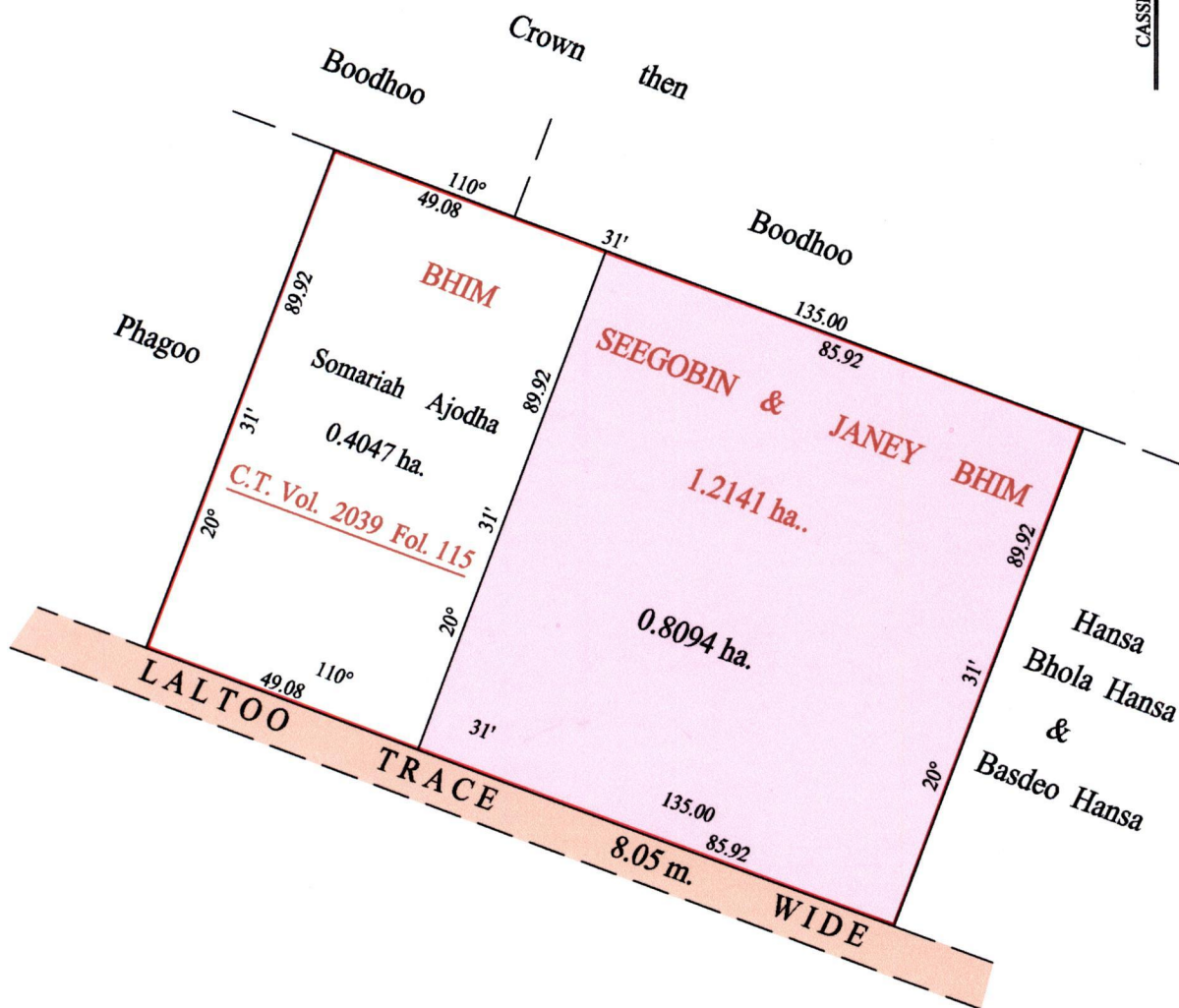

PURNANAND & SHARDA BHIM..

Vide Bk. 993 fol. 97



Approved *[Signature]*
Director of Surveys 2008.7.9

SCALE : 1:1250

Note: Bearings are cassini grid based on solar observations

Distances are in metres

This is a true copy of a diagram of one point two one four one hectares, originally transferred to Bhin Seegobin & Janey Bim, shewing a portion coloured pink and containing zero point eight zero nine four hectare being the remainder after one (1) previous transfer of another portion of the land. In accordance with Regulation 25 (1) of the Land Surveyors' Regulations 1998, I certify that this plan is correct.

Checked by *[Signature]* 8/7/08

Entered on Trinidad & Tobago Land Surveyor ... 26. . . 11: . . . 2007