

Process JD# 80832

Cadastral Sheet G.13.B, 63F

R.P.O Vol. 54

Fol. 317

Ward of Naparima

1/a

C.T. Vol. 2936

Fol. 319

County of Victoria

Vol 4669 Fol 497

Debe

Ref. Bk. 1148 : 07
Ref. Bk. 1175 : 146

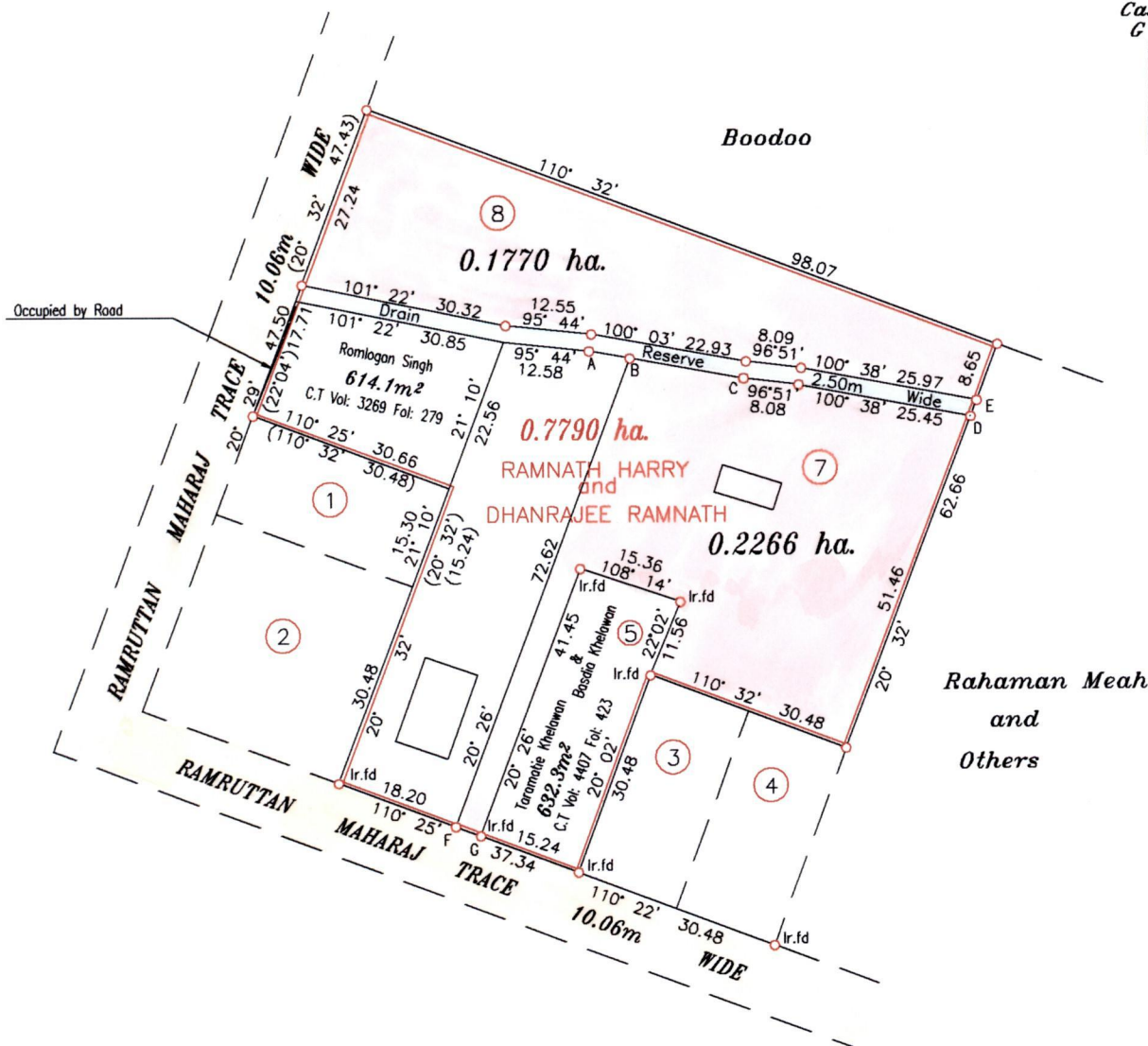
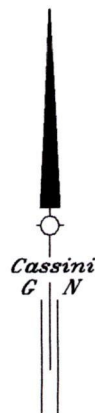

Approved: *[Signature]*
 Director of Surveys
 2005-4-5

A-B	100' 03'	6.04
B-C	100' 03'	16.87
D-E	20' 32'	2.55
F-G	110' 25'	3.90

o Denotes Iron put except otherwise stated
 Bearings are Cassini Grid based on Solar Observations
 Plan of 2 Parcels of land coloured pink in the Ward of Naparima
 Containing together zero point four zero three six hectares
 Surveyed by me with due authority, in May 2004
 In accordance with Regulation 25 (1) of the Land Surveyors' Regulations 1998,
 I certify that this plan is correct.

SCALE 1/1000
 Distances are in Metres

Checked by: *[Signature]* *[Signature]*

Entered..... Trinidad & Tobago Land Surveyor 21.03.2005



7. Vol 4669 Fol 511 YUGANTIE MALA BHOLAI, DEVINDRA
BHOLAI | BHOLAI

8. Vol 4669 Fol 503 RAJEEV SEERAM | JENNIFER
DOOKIE



1195/219