

Vol 4939 Fol 29

R.P.O Vol . 431 Fol 121

C.T Vol. 1997 Fol 483

Process ID# 30866

Ward of Savana Grande

County of Victoria

Cadastral Sheet G·14·C & D $\frac{64 D}{2/b}$

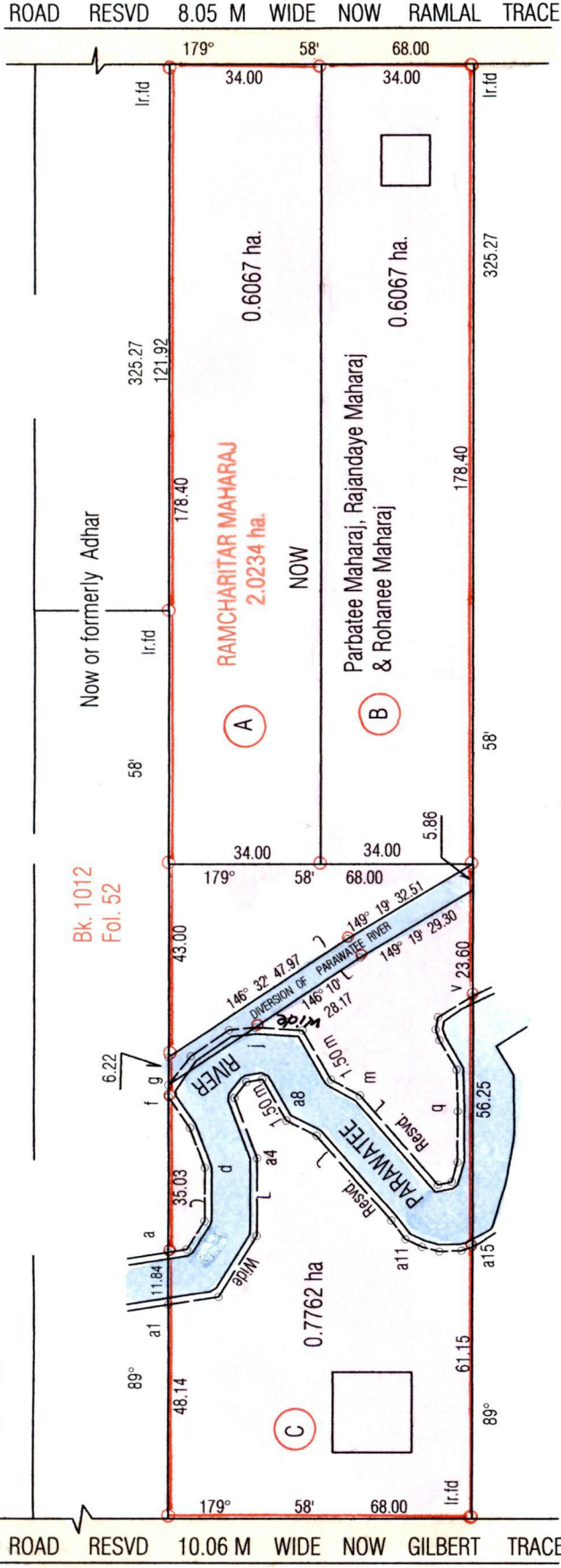
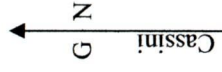

Ramkalliah

Approved *[Signature]*
 Director of Surveys
 2007-05-24

(See back of plan)
 Bearings are CASSINI GRID based on Solar Obs.
 SCALE 1: 1500

○ Denotes iron put except otherwise stated

Note: To obtain compass bearings add/subtract minutes Distances are in metres

PLAN of 3 Parcel s of land coloured Pink in the Ward of Savana Grande

Containing one point nine eight nine six hectares

Surveyed by me, with due authority, in September 2006

In accordance with Regulation 25 (1) of the Land Surveyors' Regulations 1998 I certify that this plan is correct.

Checked by *[Signature]*

Entered *[Signature]*

9-12-2014

[Signature]

Trinidad and Tobago Land Surveyor 5th March 2007





a - b =	171° 02' 4.19
b - c =	121° 43' 7.52
c - d =	90° 00' 12.14
d - e =	69° 20' 9.48
e - f =	55° 38' 8.44
f - k =	183° 29' 10.57
k - l =	239° 54' 12.78
l - m =	208° 21' 7.44
m - n =	228° 52' 26.42
n - o =	168° 23' 3.12
o - p =	106° 27' 4.57
p - q =	90° 23' 11.47
q - r =	88° 08' 9.31
r - s =	59° 42' 7.62
s - t =	70° 30' 2.56
t - u =	100° 42' 2.78
u - v =	149° 05' 9.07

a1 - a2 =	171° 02' 11.40
a2 - a3 =	121° 43' 16.22
a3 - a4 =	90° 00' 17.60
a4 - a5 =	69° 20' 14.39
a5 - a6 =	127° 16' 4.42
a6 - a7 =	169° 56' 3.65
a7 - a8 =	239° 54' 10.66
a8 - a9 =	206° 33' 7.62
a9 - a10 =	228° 52' 25.34
a10 - a11 =	233° 00' 5.33
a11 - a12 =	205° 08' 4.08
a12 - a13 =	195° 20' 3.98
a13 - a14 =	177° 43' 4.97
a14 - a15 =	161° 38' 2.63
f - g =	89° 58' 2.64

- A. Vol 4939 Fol 47 Mohane MaharaJ
- B. Vol 4939 Fol 49 Raghendare MaharaJ
- C. Vol 4939 Fol 51 Paragatte MaharaJ