

Process ID# 81258

U.P.R.N No.....

R.P.O. Vol..... Fol.....

C.T. Vol. 1477 Fol. 7.....

Vol. 4792

Bl. 115

REMAINING PORTION

Cadastral Sheet (B.17.F) 13F  
3/a

Ward of St. Anns

County of St. George

Vide Bk. 936 Fol. 68

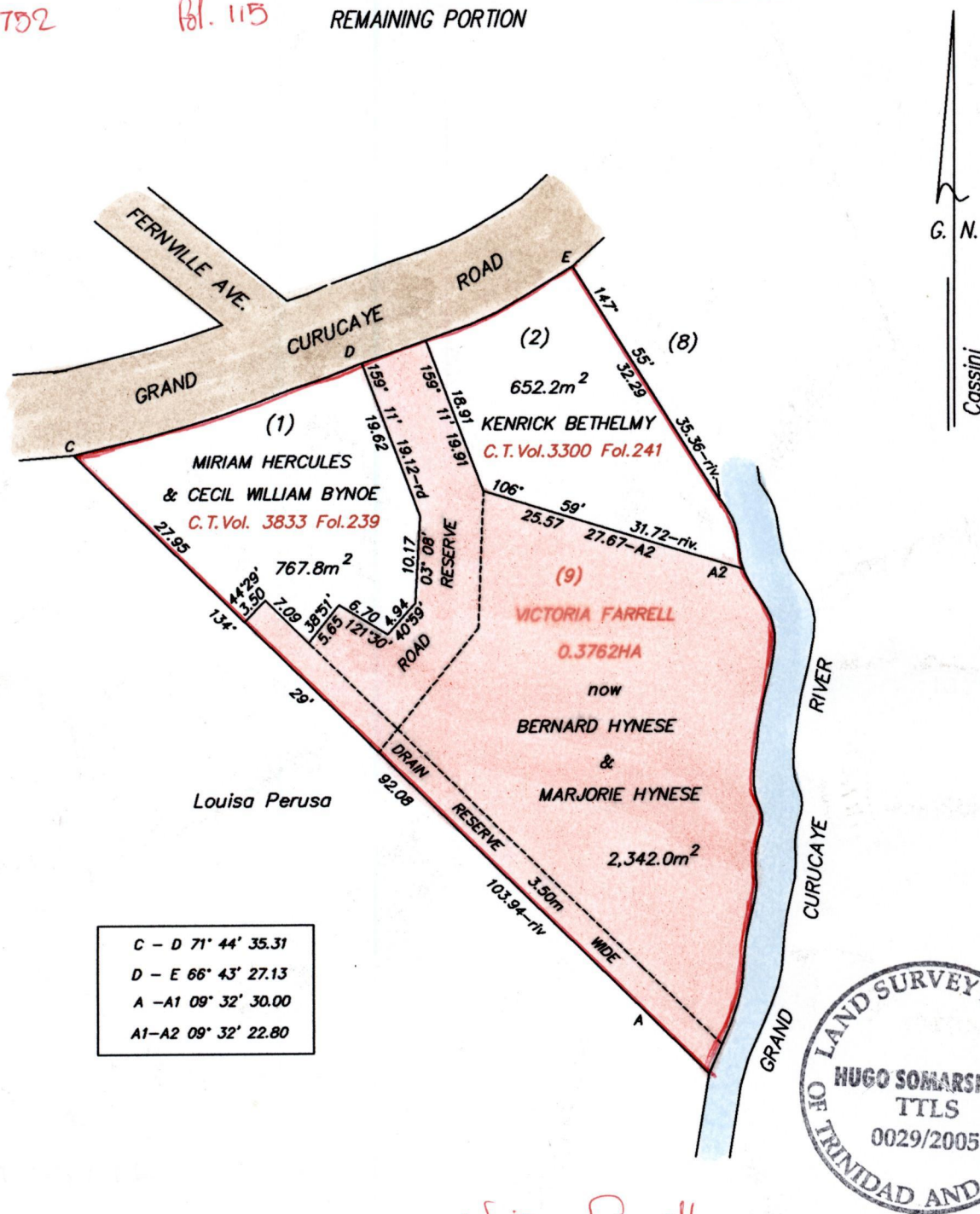

Victor Farrell

SCALE 1/750

Distances are in metres

Approved by *[Signature]*  
Director of Surveys 2006.2.3

Note to obtain compass bearings add/subtract minutes

This is a true copy of a diagram of zero point three seven six two hectares originally transferred to **VICTORIA FARRELL** shewing a portion coloured pink and containing two thousand three hundred and forty two point zero square metres being the remainder after **TWO** previous transfers of another portion of land. In accordance with Regulation 25 (1) of the Land Surveyors' Regulations 1998,

I certify that this plan is correct.

Checked by *[Signature]*

Entered on *[Signature]*

*[Signature]*  
Trinidad and Tobago Land Surveyor *[Signature]* 2005