

REMAINING PORTION

Process ID 81146

Ward of Tacarigua

R.P.O. Vol. 100 Fol. 199

County of St. George

C.T. Vol. 1771 Fol. 381

Cadastral Sheet B.18.0. $\frac{24A}{1/d,2/c}$

Vol. 4706 Fol. 373

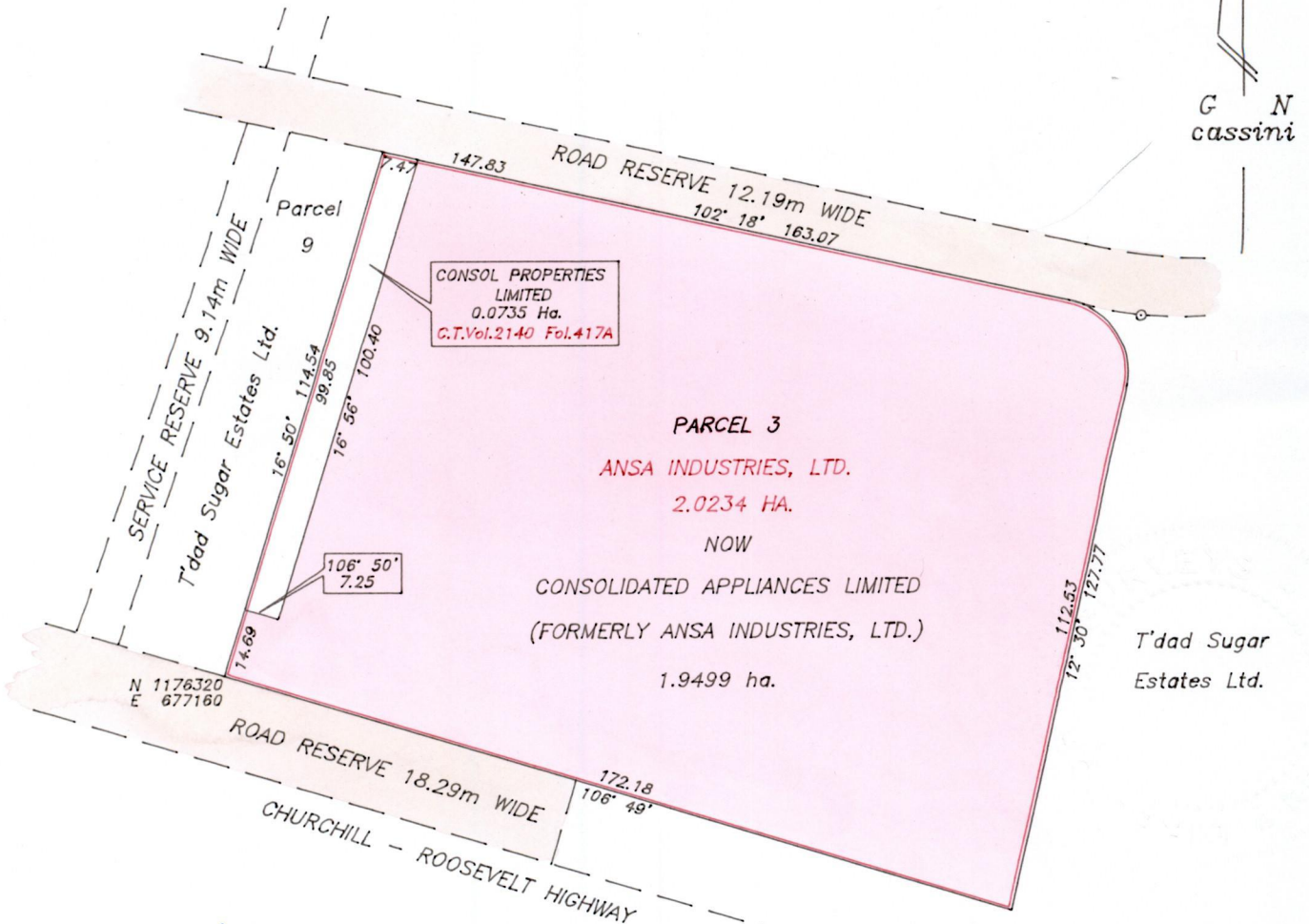

Approved
[Signature]
 Director of Surveys
 2005.6.27

Consolidated Appliances Ltd.

see P.E 128

See Bk.1110 Fol.121

SCALE 1/1500

Distances are in metres



UTM.Co-ordinates are approx.scaled from 1/10,000 sheet
 Bearings are Cassini grid based on Magnetic Needle
 Bearings are based on Control Marks.

This is a true copy of a diagram of two point zero two three four hectares originally granted to Ansa Industries Ltd. , shewing a portion coloured pink and containing one point nine four nine nine hectares being the remainder after one previous transter of another portion of the land. In accordance with Regulation 25 (1) of the Land Surveyors' Regulations 1998, I certify that this plan is correct.

Checked by *[Signature]*
 Entered *[Signature]* 20.11.2014 Trinidad & Tobago Land Surveyor *[Signature]* 18th December 2004

1/10,000

TRINIDAD

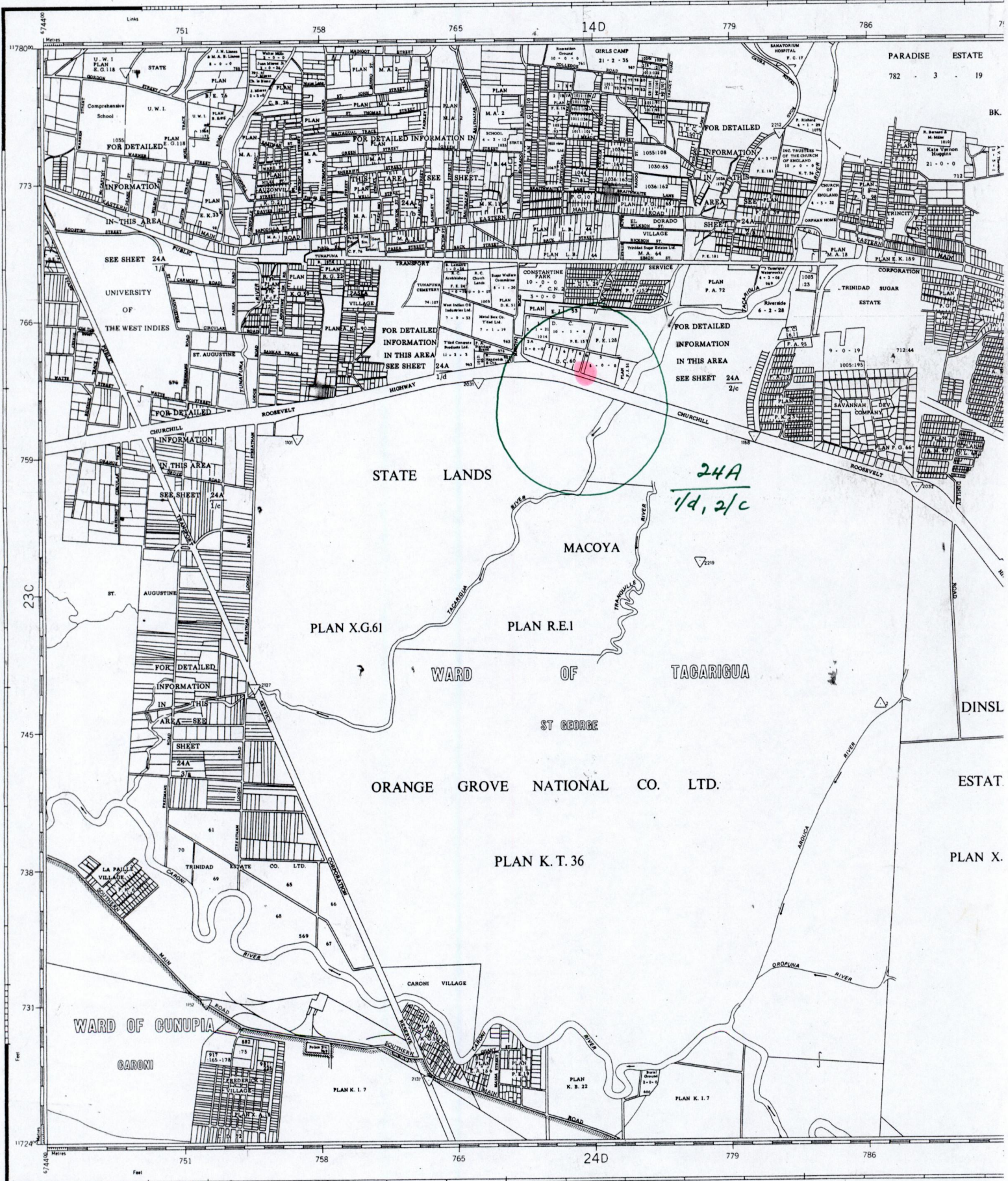

T.T.S. Cad 1
 First Edition January 1979
 Published by Lands & Surveys Division
 © TRINIDAD AND TOBAGO GOVERNMENT 1970

SCALE - 1/10,000

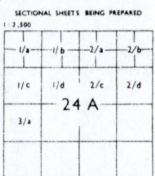

- | | | |
|-----------------------------------|-----------------------------------|-------------------------|
| Administrative Boundary..... | Water Course and Reserve..... | Ridge..... |
| Road..... | Drain..... | Swamp..... |
| Carrage-way or Existing Road..... | Power Transmission Line..... | Cliff..... |
| Trace or Track..... | Pipe Line..... | Quarry..... |
| Footpath..... | Traverse Station..... | Shoreline and Sand..... |
| Bridge or Culvert..... | Trig Station..... | Lighthouse..... |
| | Areas under Oil Mining Lease..... | |

Compiled from existing Cadastral Sheets (1:40,000 SHEETS) and Photogrammetric data obtained from 1957.

Copies of this map can be obtained from the Lands and Surveys Dept. of St. Paul's