

Process 81126  
R.P.C. Vol. 1822 Fol. 309

Cadastral Sheet A.14.6&K.  $\frac{12c}{4/d}$

C.T. Vol. Fol.

Ward of Diego Martin

Vol 4367 Fol 267

County of St. George

INSET

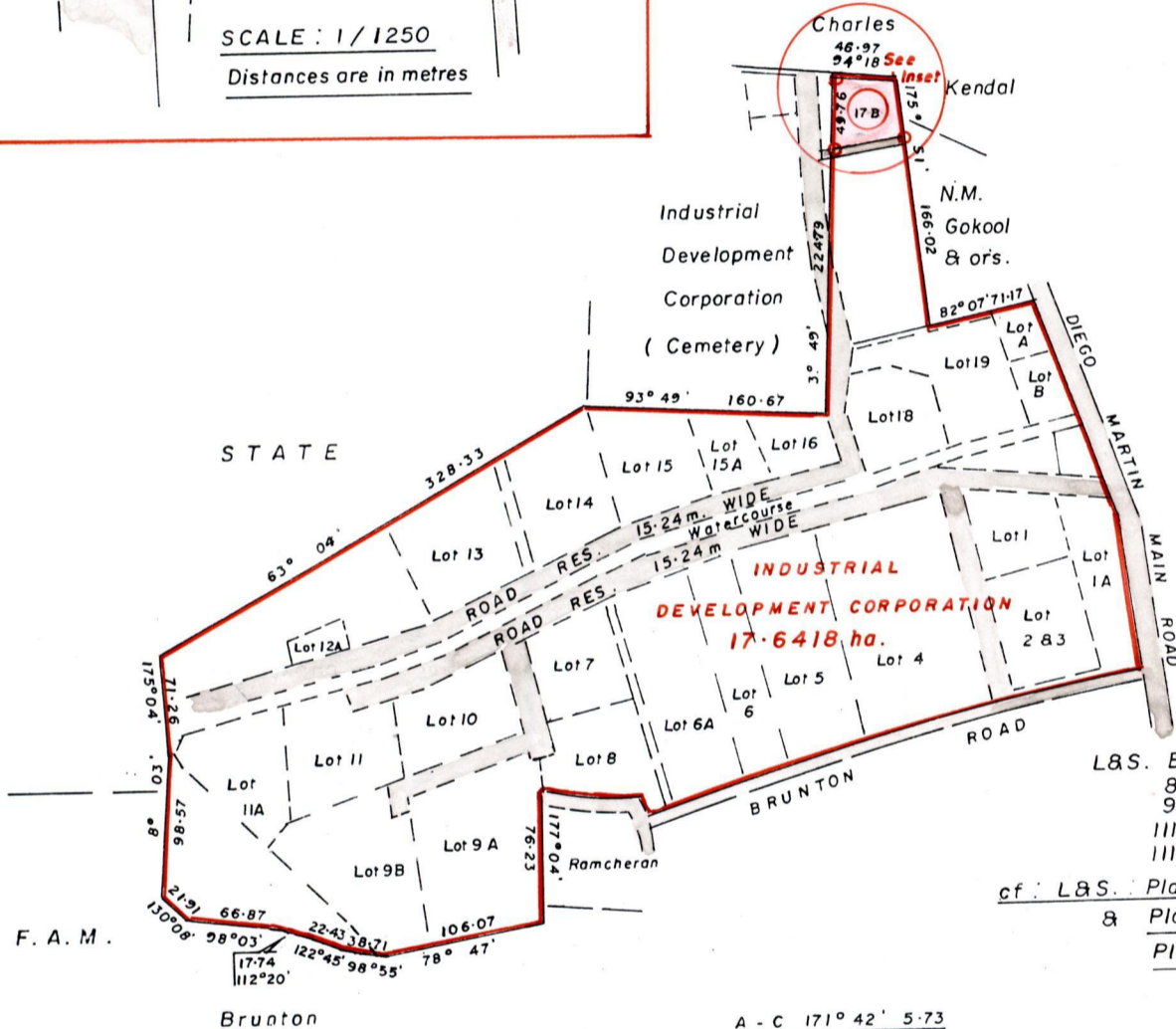
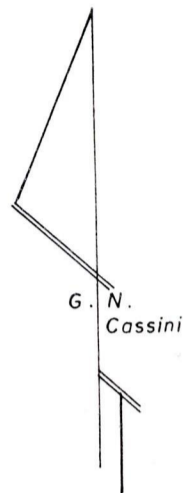
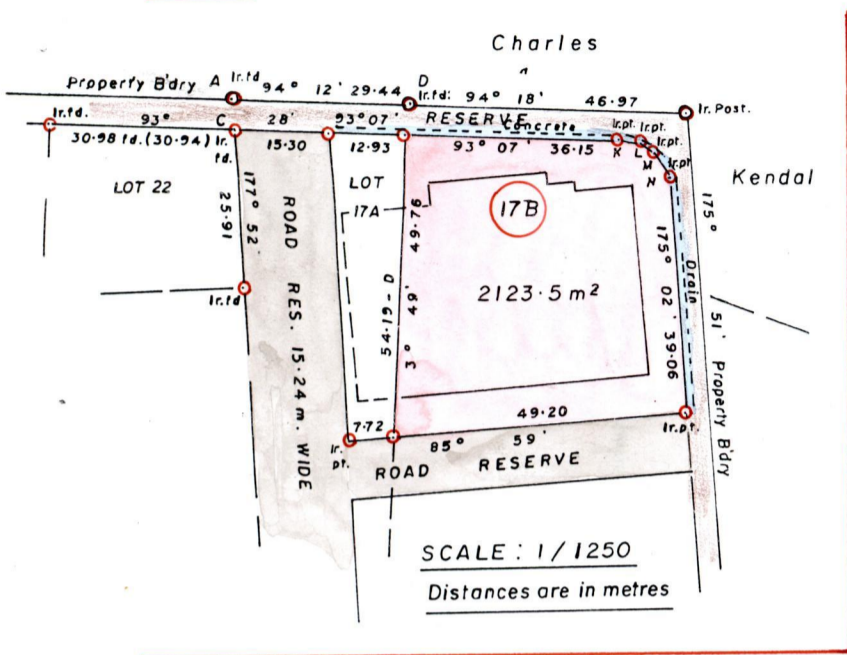

L&S. Bk.	Fol.
816	34
937	8
1118	127
1117	100

cf. L&S. Plan P.K. 56  
& Plan P.K. 28  
Plan CM 73

A - C	171° 42'	5.73
K - L	103° 23'	3.02
L - M	127° 07'	2.78
M - N	159° 06'	3.17

SCALE: 1/5000

Distances are in metres

NOTE: Parcel 17B to be amalgamated with Parcel 17A  
Note: To obtain compass bearings subtract 4 minutes.

PLAN of a Parcel of land coloured pink in the Ward of Diego Martin  
Containing two thousand one hundred and twenty three point five square metres

Surveyed by me with due authority in March 2005

In accordance with Regulation 25(1) of the Land Surveyors' Regulations 1998,

I certify that this plan is correct.

Checked by Udel 4/4/06

Entered.....

Michael Boucaud T.T.S.  
Trinidad & Tobago Land Surveyor. 20<sup>th</sup> April 2005

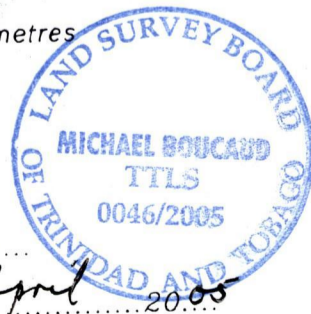

LOTS	AREAS	C of T.	
1	0.3162 ha.	Vol. 2354	Fol. 447
2 & 3	0.4578 ha.	2106	19
5	0.7689 ha.	2100	473
6	0.4553 ha.	1971	37
6A	0.8321 ha.	2033	197
7	0.3794 ha.	2039	231
8	0.4376	4150	529
9A	0.9232	2807	177
9B	5526.9 m <sup>2</sup>	3593	357
10	0.4148 ha.	1951	250
11	0.6070 ha.	2674	21
13	0.5615 ha.	2074	571
14	0.5109 ha.	2119	439
15	0.4199 ha.	2035	453
16	0.1138 ha.		
18 & 19	0.8549 ha.	1978	485
11A	0.4047 ha.	3593	373
12A	9968 m <sup>2</sup>	2558	33
1A	3853.3 m <sup>2</sup>	3145	549
B	1474.5 m <sup>2</sup>	3593	39
A	1016.9 m <sup>2</sup>	3916	81
6A	0.8321 ha.	4220	341
4B	0.4429 ha.	4213	417



1358/245