

Process ~~81121~~ State then Mistree

R. P. O. Vol. 76
C. T. Vol. 1944
Bk. 985 fol. 48

Vol. 4870
fol. 489
fol. 493

Ward of Naparima
County of Victoria
Cadastral Sheet G. 13. C & D 63F
1/b

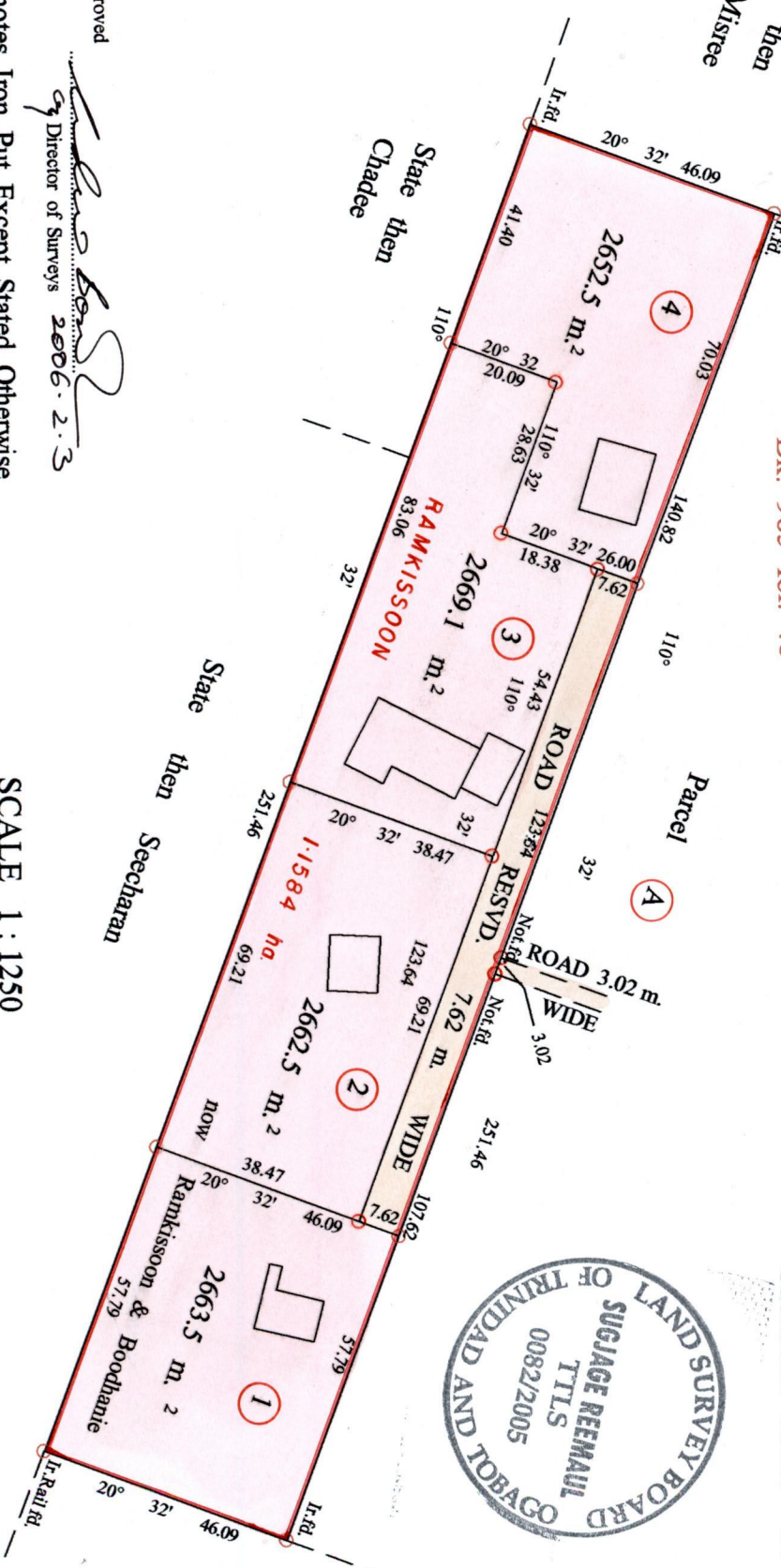

Approved
[Signature]
 Director of Surveys 2006.2.3

Denotes Iron Put Except Stated Otherwise
 Note Bearings are cassini grid based on Solar Observations
 PLAN of 4 Parcels of land coloured pink in the Ward of Naparima
 Containing together ten thousand six hundred and forty seven point six sq. metres
 Surveyed by me, with due authority, in March 2005.
 In accordance with Regulation 25 (1) of the Land Surveyors' Regulations 1998,
 I certify that this plan is correct

SCALE 1 : 1250

Distances are in metres

Checked by *[Signature]*
[Signature]

Entered on
 Trinidad & Tobago Land Surveyor *[Signature]* 2005

CASSINI

G N