

REMAINING PORTION

R.P.O Vol. 712 Fol. 417

C.T Vol. 1072 Fol. 307

Vol. 4785 Fol. 273

Ward of Moruga

County of Victoria

Cadastral Sheet (G.14.K). 64D
4/a

Process SAH 81079

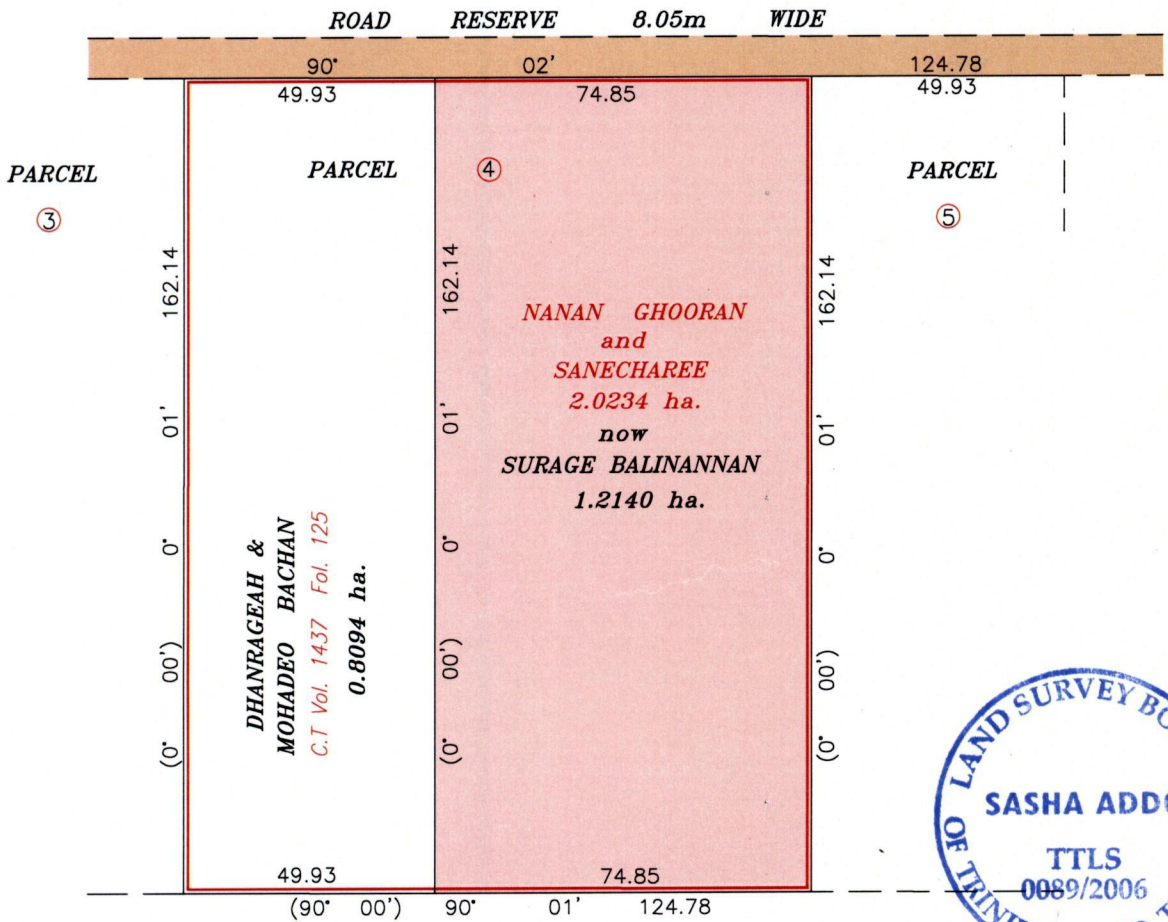
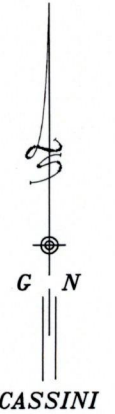

JOHN BRIDGLALSINGH

MERLIN ALEAN BOYCE

Approved *[Signature]*
Director of Surveys 2006-3-24

Ref Bk. 856 : 104
Bk. 935 : 12

SCALE 1 : 1500

Note : To obtain compass bearing subtract 1 minutes.

Distances are in metres

This is a true copy of a diagram of two point zero two three four hectares. originally transferred to Nanan Ghooran and Sanecharee showing a portion coloured pink and containing one point two one four zero hectares being the remainder after one (1) previous transfer of a portion of the land. In accordance with Regulation 25 (1) of the Land Surveyors' Regulations 1998, I certify that this plan is correct.

Checked by *[Signature]* 9/2/06

Entered on

Trinidad & Tobago Land Surveyor.....

9/2/2006