

Process ID # 81110
Vol 4897 Fol 157

R.P.O. Vol. 13 Fol. 309
C.T. Vol. 1957 Fol. 271

REMAINING PORTION

Cadastral Sheet G.14.B. 64A
Ward of Naparima 3/d
County of Victoria.

Vide Bk. 455 fol. 183
Vide Bk. 1135 fol. 667
Vide Bk. 980 fol. 76
Vide Bk. 1145 fol. 122
" " 1152 " 39
" " 1282 " 49

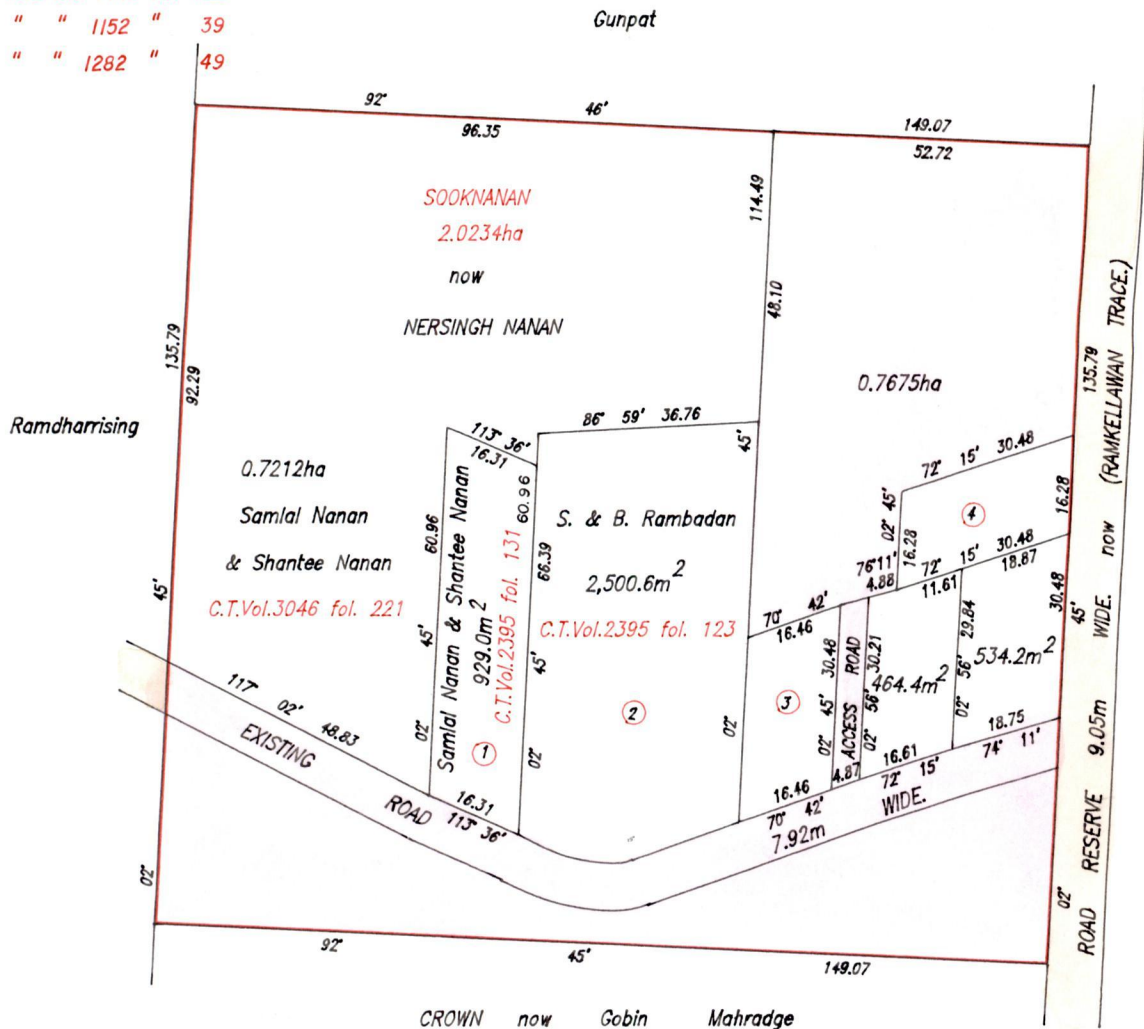

Lot No.	NAME	AREA	C.T.Vol.	Fol.
3	A.Nanan & Rosey	464.5m ²	2395	113
4	T.Mahasing & Raimoon	464.5m ²	2395	107
	K.S. Yacobali, I.Mohammed & N.Mohammed	534.2m ²	4449	235
	Ramdai Rambadan	464.4m ²	3436	223

Approved

[Signature]
Director of Surveys
2005.12.07

Andrea & P. Nanan

SCALE 1:1250

Distances are in Metres

This is a true copy of a diagram of a Parcel of land in the Ward of Naparima Containing two point zero two three four hectares originally transferred to SOOKNANAN, showing a portion coloured pink and containing zero point seven six seven five hectare being the remainder after seven previous transfers of other portions of the land.

In accordance with Regulation 25(1) of the Land Surveyors' Regulations 1998, I certify that this plan is correct.

Checked by *mm. 1/12/05* *[Signature]*

Entered CMS 02-09-2014 Trinidad & Tobago Land Surveyor 21st October 2005
Edgill PATH = E:\700 D:\Drawings05\PNanan.dwg

