

REMAINING PORTION

Vol. 4838 Fol. 109

R.P.O. Vol. 49 Fol. 671

C.T. Vol. 1286 Fol. 325

U.P.R.N. No.:

Ward of Siparia

County of St. Patrick

Cadastral Sheet G.12.H. 63E
1/d

now or formerly
Paul Stanley Sheldon
(Pluck Estate)

G.N.
Cassini

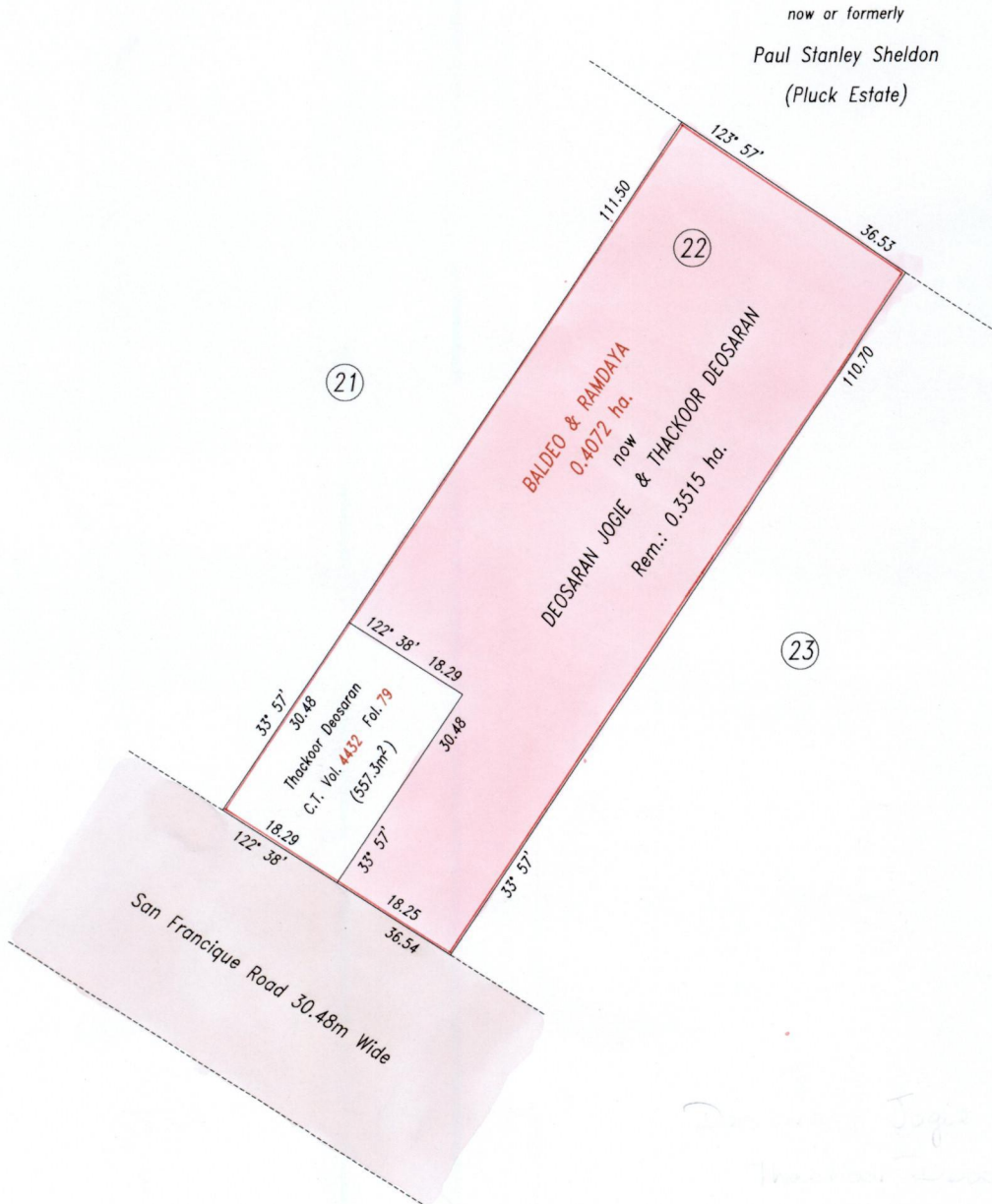

Approved *[Signature]*
Director of Surveys
2006.5.22

Deosaran Jogie & Thackoor Deosaran

References: Plan D.H. 6
Bk.1280 Fol.184

SCALE 1: 1000

Distances are in metres

This is a true copy of a diagram of zero point four zero seven two hectare originally transferred to BALDEO & RAMDAYA, showing a portion coloured pink and containing zero point three five one five hectare being the remainder after one (1) previous transfer of another portion of the land. In accordance with Regulation 25(1) of the Land Surveyors' Regulations 1998, I certify that this plan is correct.

Checked by *[Signature]*
Entered

[Signature]
Trinidad & Tobago Land Surveyor 18/4/2006

