

Ward of Ortoire
County of Victoria
Cadastral Sheet (H.1.M.) 54.F
4/a

Vol. 4967 fol. 75

R.P.O. Vol. 51 Fol. 205

C.T. Vol. 1622 Fol. 119

Process 50781083

STATE

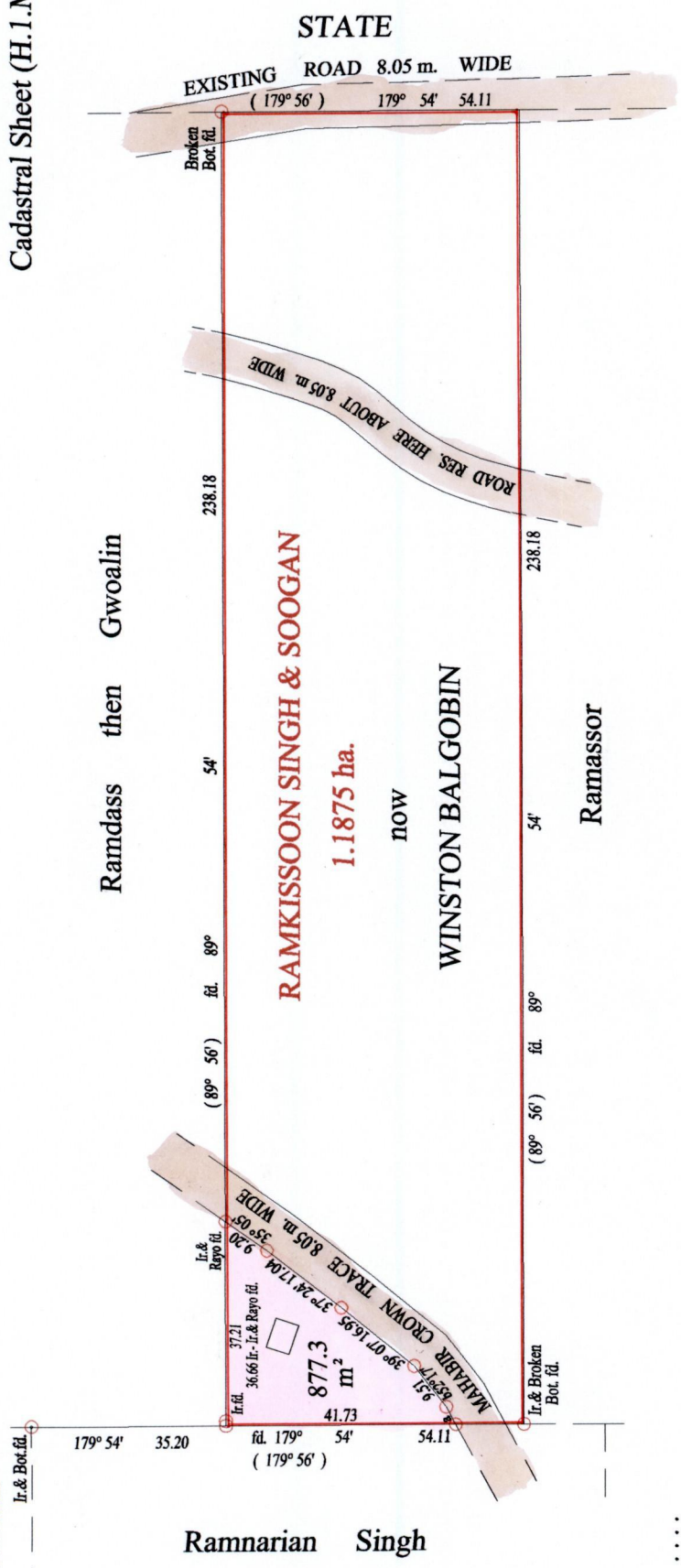

Sookdeo Singh

a - b 62° 05' 3.69

Vide Bk. 712 fol. 142
Orig. Bk. 334 fol. 360
Bk. 716 fol. 126
Plan K. E. 17



SCALE : 1:1250

○ Denotes Iron put except stated otherwise.

Note: Bearings are cassini grid based on solar observations Distances are in metres
PLAN of a Parcel of land coloured pink in the Ward of Ortoire
Containing eight hundred and seventy seven point three square metres
Surveyed by me, with due authority, in October 2003
In accordance with Regulation 25 (1) of the Land Surveyors' Regulations 1998,
I certify that this plan is correct.

Approved *[Signature]*
Director of Surveys
2006 10 11

Checked by *[Signature]* M.M. 7/12/06

Entered on Trinidad & Tobago Land Surveyor 31- 10 2006