

1304  
 Process SA 74511  
 R.P.O. Vol. 123 Fol. 61  
 C.T. Vol. 613 Fol. 311  
 Vol. 4641 Fol. 441

1328

Ward of Siparia  
 County of St. Patrick.  
 Cadastral Sheet (G.12.H) 63.E.  
 1/d

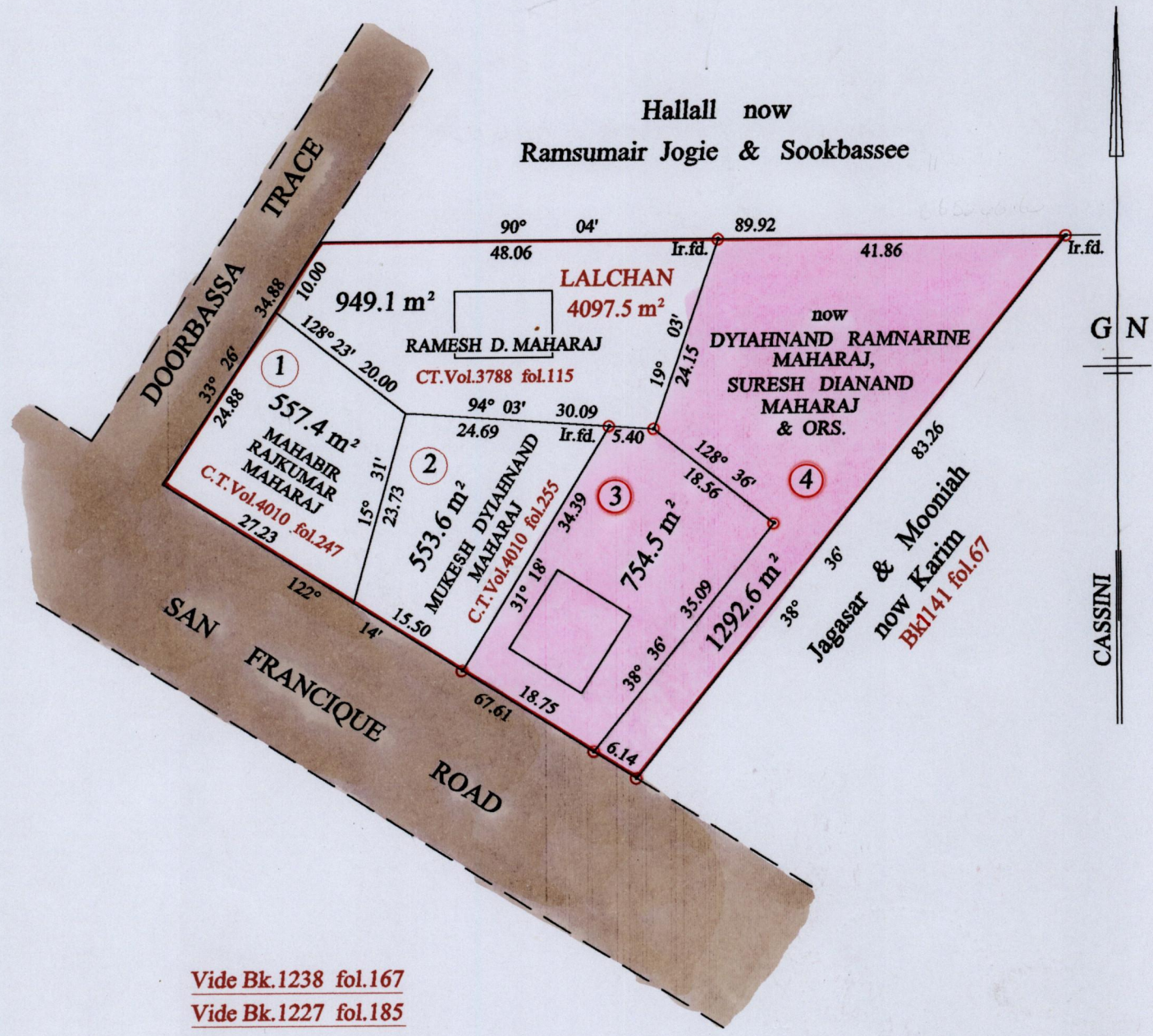

Vide Bk.1238 fol.167  
 Vide Bk.1227 fol.185

Approved *[Signature]*  
 Director of Surveys  
 2504-3-25

○ Denotes Iron put except stated otherwise. SCALE : 1:750  
 Note: Bearings are cassini grid based on solar observations Distances are in metres

PLAN of 2 Parcels of land coloured pink in the Ward of Siparia  
 Containing together two thousand and forty seven point one square metres  
 Surveyed by me, with due authority, in September 2002 for Mr. Ramteoh Mahooj  
 In accordance with Regulation 25 (1) of the Land Surveyors' Regulations 1998.  
 I certify that this plan is correct.

Checked by *[Signature]* 4-3-04  
 Entered on *[Signature]* Trinidad & Tobago Land Surveyor 23-04-2003

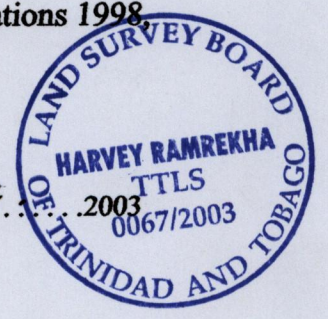

3. Vol. 4641 Fol. 447 BISSOONDAYE MAHARAJ

H. Vol. 4641 Fol. 453 SURESH DIANAND MAHARAJ.

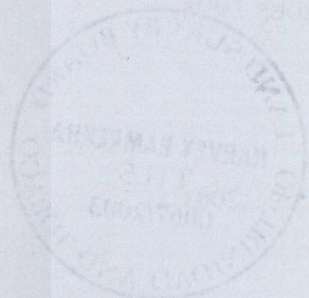
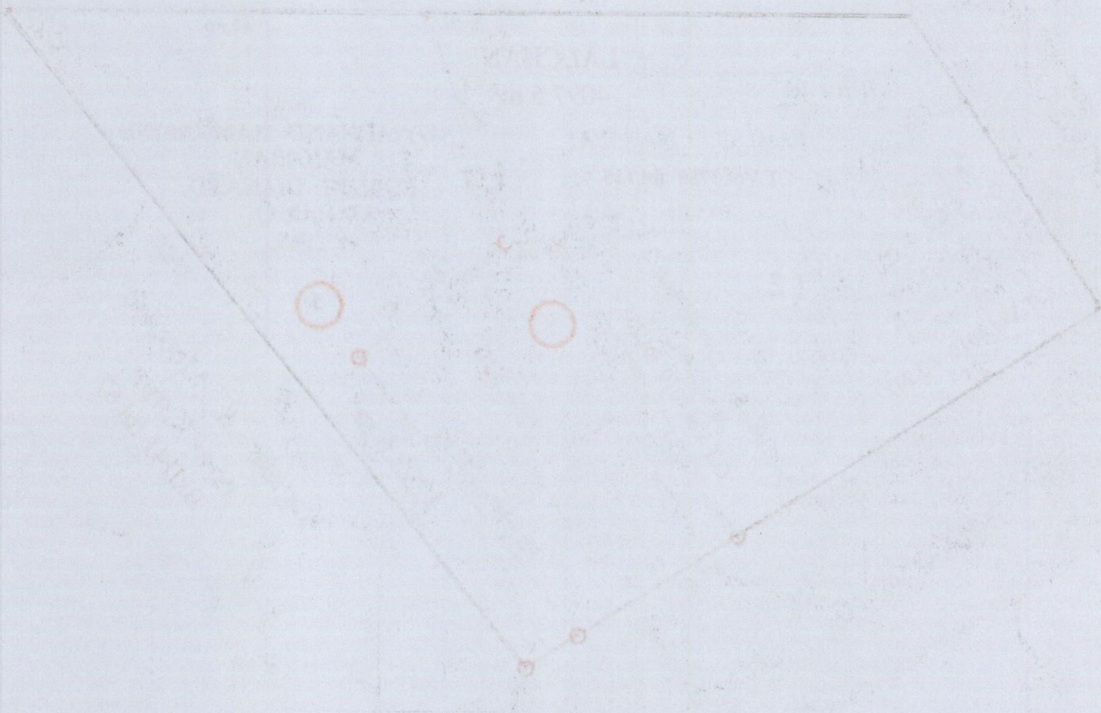

40.80

