

Process ID# 75512  
 R.P.O Vol. 175 Fol. 13  
 C.T. Vol. 362 Fol. 627  
 U.P.R.N No.

1328

Ward of Siparia  
 County of St. Patrick  
 Cadastral Sheet G.18.G.73.C.  
 2/c

76

Vol 4635 Fol 35

Bk. 402 Fol. 51  
 Bk. 716 Fol. 271  
 PLAN L.C.33

State then  
 Stella Moolchan

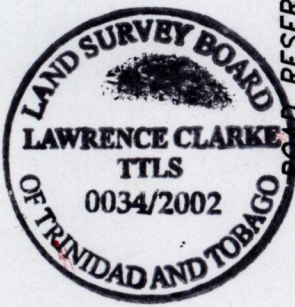
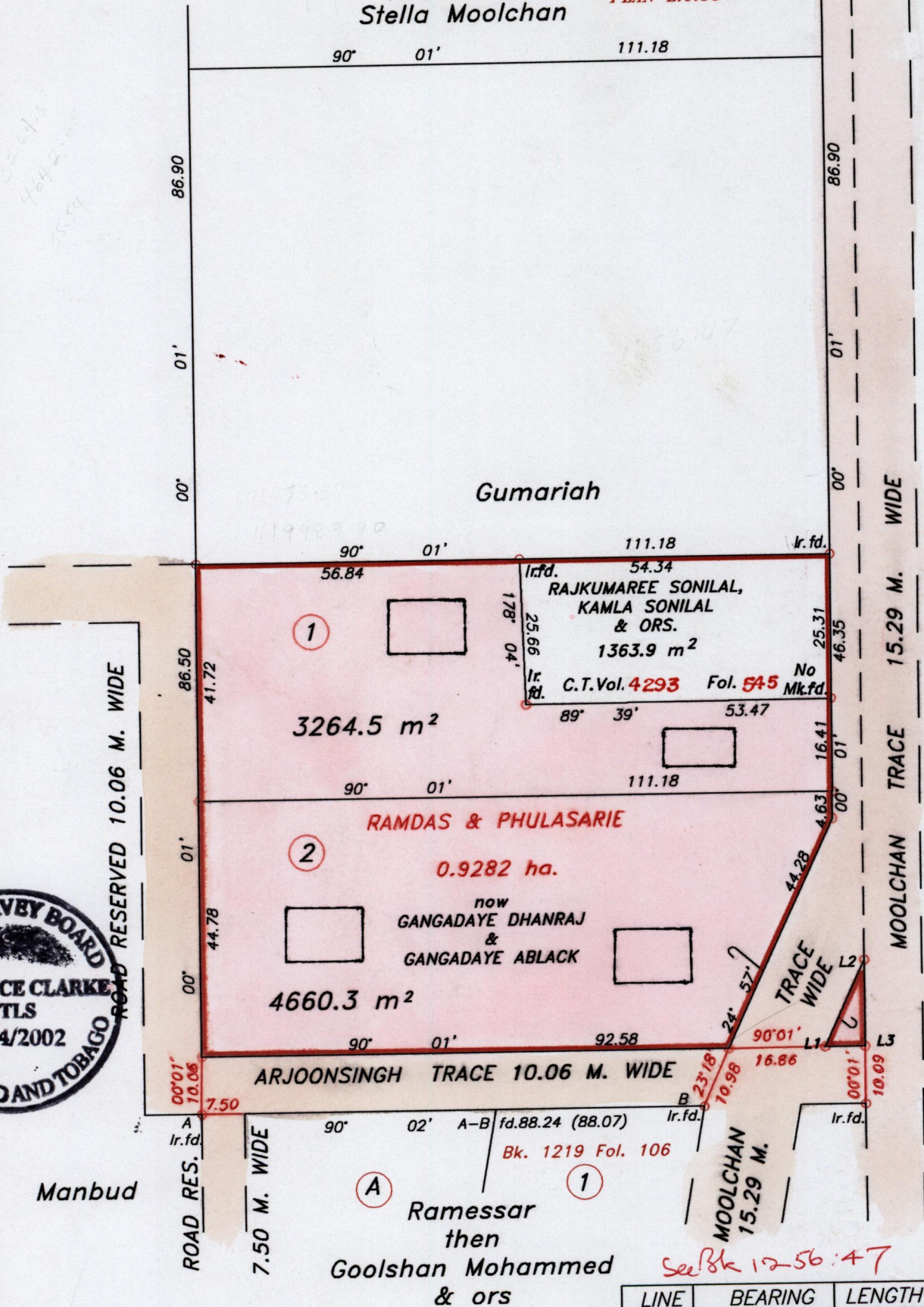

LINE	BEARING	LENGTH
L1-L2	24°57'	16.70
L2-L3	180°01'	15.14
L3-L3	90°01'	7.04

Approved *[Signature]*  
 Director of Surveys

Denotes Iron put except stated otherwise.

Bearings are Cassini Grid based on Solar Observations  
 Plan of 2 Parcels of land coloured pink in the Ward of Siparia  
 Containing together seven thousand nine hundred and twenty four point eight square metres  
 Surveyed by me, with due authority, in January 2002  
 In accordance with Regulation 25 (1) of the Land Surveyors' Regulations 1998,  
 I certify that this plan is correct.

Checked by *[Signature]*

Entered by *[Signature]*

*[Signature]*  
 Trinidad & Tobago Land Surveyor... 3<sup>rd</sup> March 2002

SCALE 1/1000

Distances are in metres

Original Bk 402:51

1 - Vol. 4635 Fol. 49 GANGADAYE + LIONEL ABLACK

2 - Vol. 4635 Fol. 41 GANGADAYE + LIONEL ABLACK

25 NOV 2002  
Lands and  
Surveys

1195/103