

Process ID #74279

R.P.O. Vol. 12  
C.T. Vol. 2066

Fol. 505  
Fol. 85

Vol. 4708

Fol. 55

Ward of Savana Grande  
County of Victoria  
Cadastral Sheet D.24.O. 54C  
3/a

Vide: Bk. 1002/83

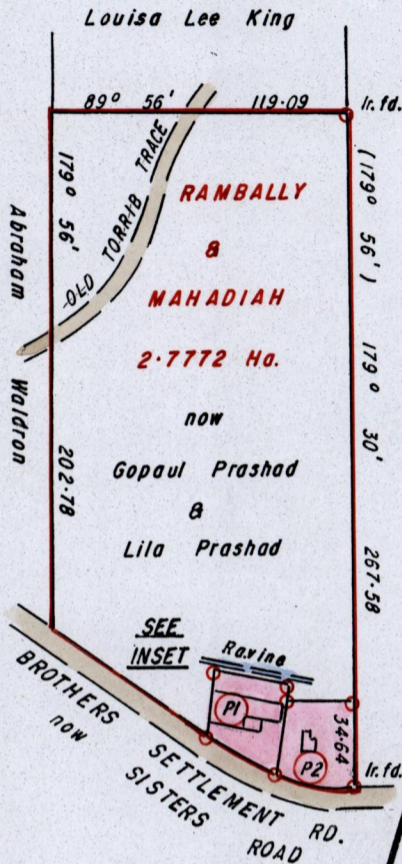

Scale: 1 / 3000

Elvira Moore  
now  
Pooran Pariag  
Bk. 1014 / 54  
Bk. 1157 / 73

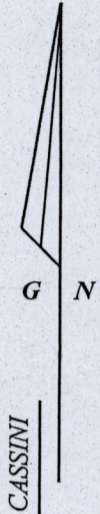
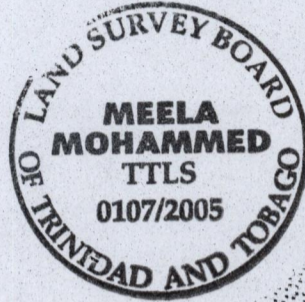

INSET

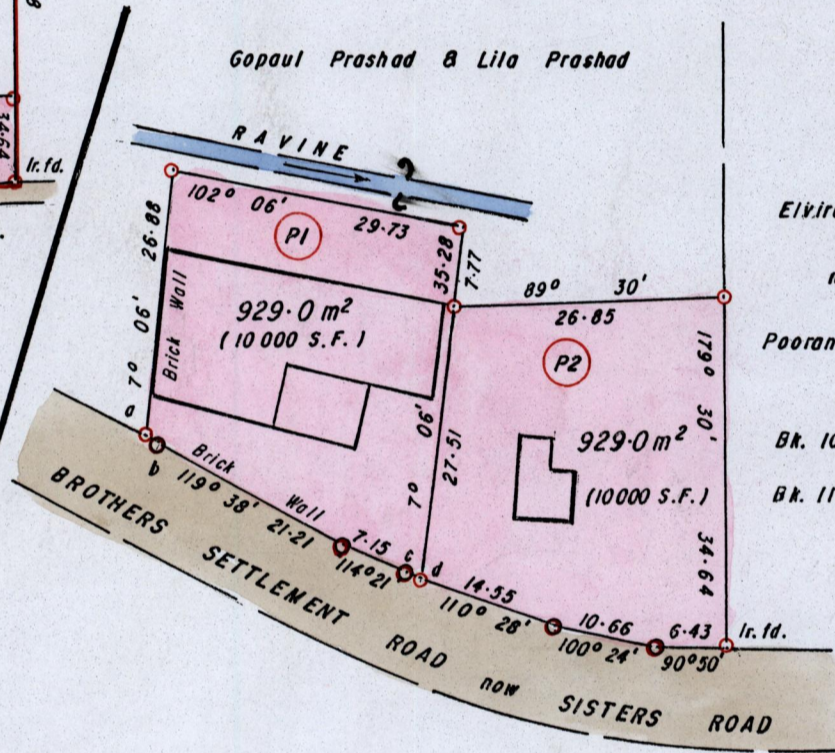

Elvira Moore  
now  
Pooran Pariag  
Bk. 1014 / 54  
Bk. 1157 / 73

SAMUEL K. RANTERLAD

a - b 109° 33' 1.17  
c - d 110° 28' 2.11

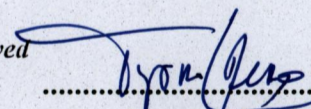
Approved   
Director of Surveys  
2005.6.13

○ Denotes Iron put unless otherwise stated  
Bearings are Cassini Grid based on Solar Obs.  
SCALE 1 / 750 (INSET)  
Distances are in METRES

Note: To Obtain compass bearings add/subtract minutes

PLAN of 2 Parcels of land coloured PINK in the Ward of Savana Grande  
Containing together zero point one eight five eight hectare  
Surveyed by me, with due authority, in November 2004  
In accordance with Regulation 25 (1) of the Land Surveyors' Regulations 1998,  
I certify that this plan is correct.

Checked by  2005.6.13

Meela Mohammed

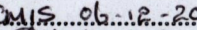
Entered  2005.6.13

Trinidad and Tobago Land Surveyor. 28th. February 2005

P<sub>1</sub> - Vol. 4708 Fol. 61

SAMUEL K. RAMPERSAD

P<sub>2</sub> - Vol. 4708 Fol. 63

SAMUEL K. RAMPERSAD.



1195/267