

R.P.O. Vol. 96 Fol. 217  
 C.T. Vol. 745 Fol. 197

*Vol. 4650 Fol. 459*

Process ID# 74498

Ramlakhan

BHOLA & SOOMAFIA BHOLA  
 0.7183 ha.  
 C.T. Vol. 1828 Fol. 375

GOPEE EXT. CROWN TRACE 8.04 m. WIDE  
 213.32 04' 90° 213.32 04'

LILY RAMLAL  
 465.1 m<sup>2</sup>  
 C.T. Vol. 745 Fol. 197

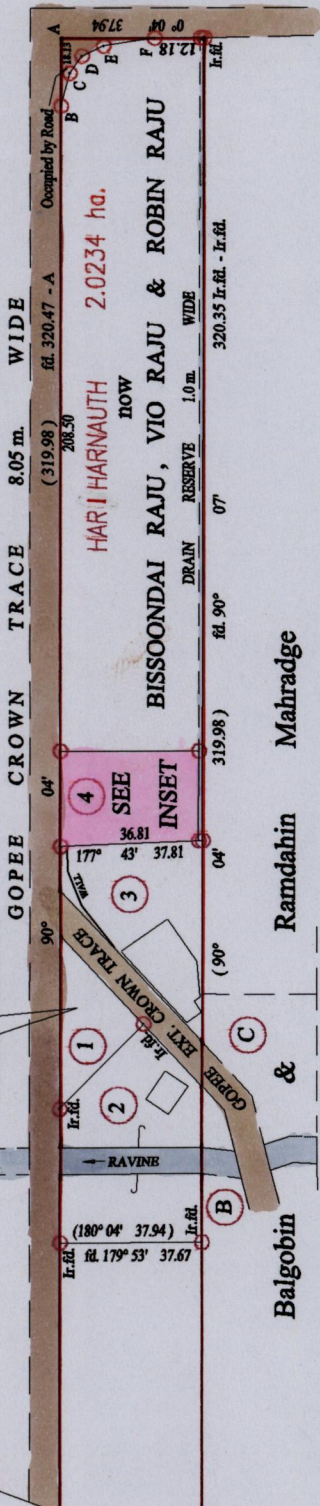

*Original*  
 Vide Bk. 1157 fol. 117  
 Vide Bk. 1010 fol. 168

Approved *[Signature]*  
 Director of Surveys  
 1004-13

○ Denotes Iron put except stated otherwise.

Note: Bearings are cassini grid based on solar observations

PLAN of a Parcel of land coloured pink in the Ward of Siparia

Containing nine hundred and five point nine square metres

Surveyed by me, with due authority, in May 2001

In accordance with Regulation 25 (1) of the Land Surveyors' Regulations 1998,

I certify that this plan is correct.

Checked by *[Signature]*

Entered on *[Signature]* Trinidad & Tobago Land Surveyor ... 30.09.2003

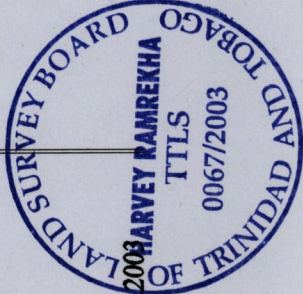

Ward of Siparia  
 County of St. Patrick  
 Cadastral Sheet (G.13.E.&F.) 63.E.  
 2/d

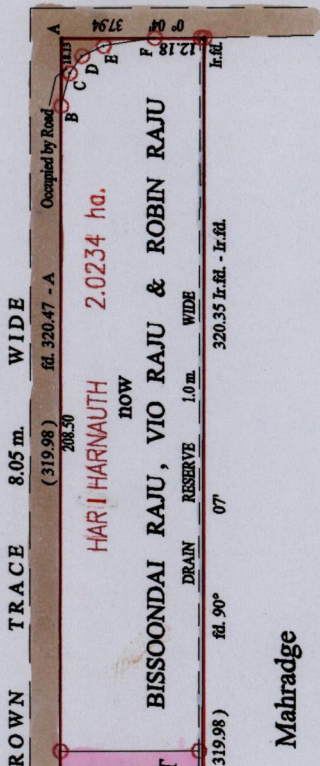

B - C	104° 48'	9.09
C - D	125° 00'	5.54
D - E	154° 59'	6.42
E - F	171° 20'	13.62
B - A	90° 04'	18.13

*SHARON MOHAMMED*

SCALE : 1:2000

Distances are in metres

1328

INSET

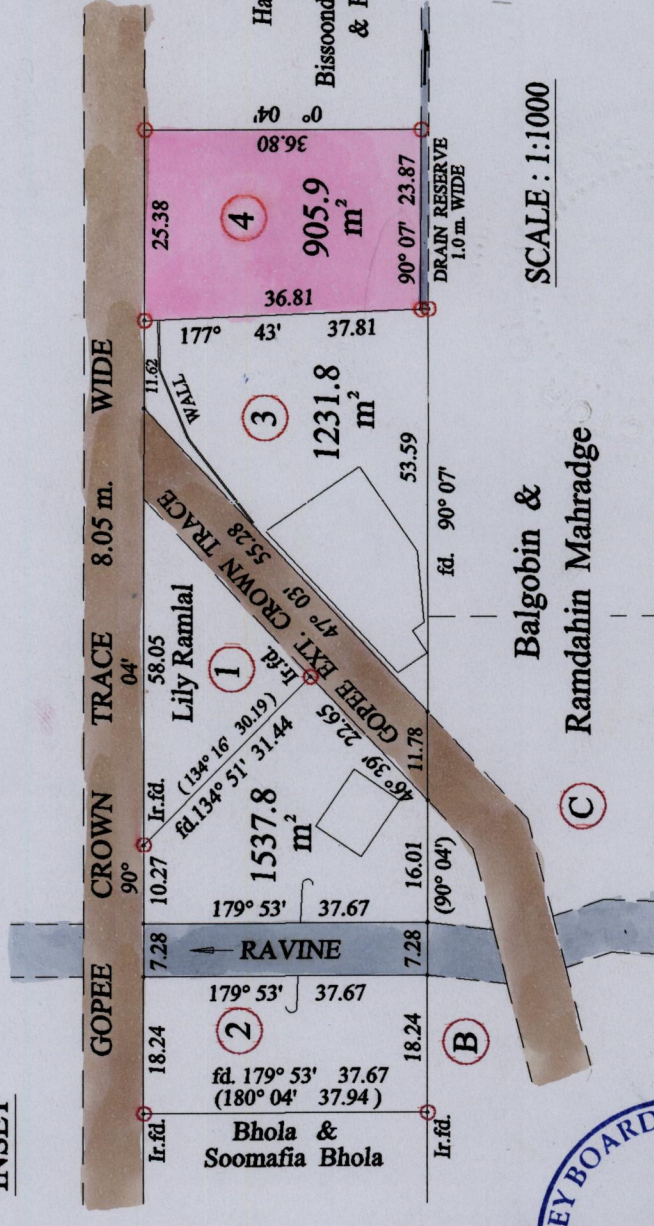

Balgobin & Ramdahin Mahradge

SCALE : 1:1000

12/53/163

165