

Process ID#73009

R.P.O. Vol. 3  
C.T. Vol. 2609  
U.P.R.N. No.

Fol. 399  
Fol. 77

Cadastral Sheet (E.2.A.) 25F/37b  
Ward of Turure  
County of St. Andrew

VOL. 4614 FOL. 5

Vide Bk. 915 Fol. 112  
Bk. 997 Fol. 74  
Bk. 997 Fol. 96  
Bk. 1148 Fol. 116

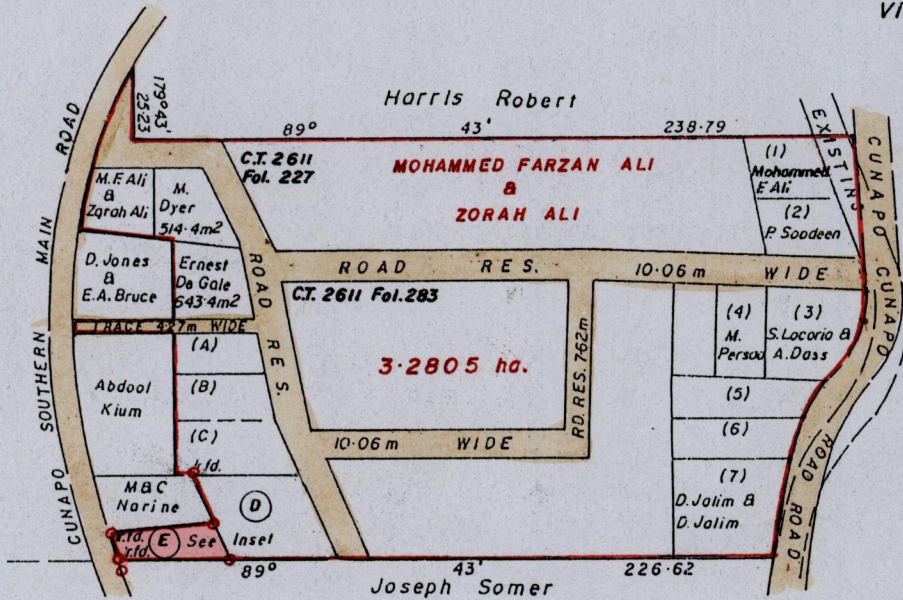

G. N. Cassini

INSET

Distances are in metres  
SCALE 1:750

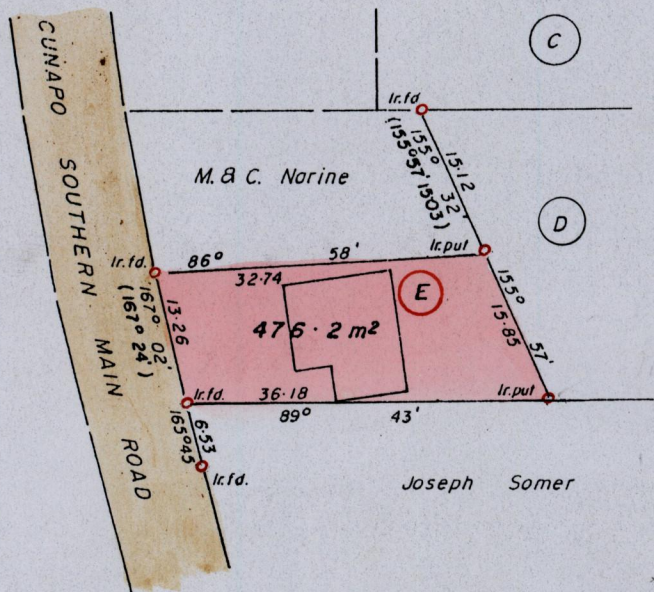

Lot	Area	C.T. Vol.	Fol.
2	494.5m <sup>2</sup>	4003	251
3	864.9m <sup>2</sup>	3204	237
4	464.5m <sup>2</sup>	2845	301
7	1035.5m <sup>2</sup>	2856	355
1	556.8m <sup>2</sup>	4289	309

Approved by

*[Signature]*  
 Director of Surveys  
 2002-07-01

Bearing are based on solar observations.

Note: To obtain compass bearings add/subtract 17 minutes

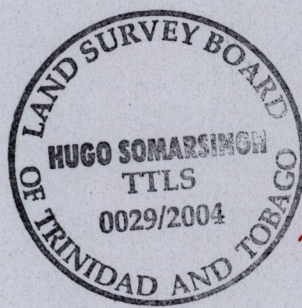

EUGENE ALVAREZ & WENDY EMMANUEL

SCALE:- 1:2500  
Distances are in metres

PLAN of a Parcel of land coloured pink in the Ward of Turure

Containing four hundred and seventy six point two square metres

Surveyed by me, with due authority in February 2002  
In accordance with Reg.25(1) of the Land Surveyors' Regulations 1998, I certify that this plan is correct.

Checked by *[Signature]* 23-6-04

Entered on *[Signature]* Trinidad & Tobago Land Surveyor 1st March 2004