

1328

45

Process ID#74383

R.P.O. Vol 30 Fol. 141

C.T. Vol 1759 Fol. 355

U.P.R.N. No.

Cadastral Sheet G.8.N. 63C. 3/c

Ward of Naparima

County of Victoria

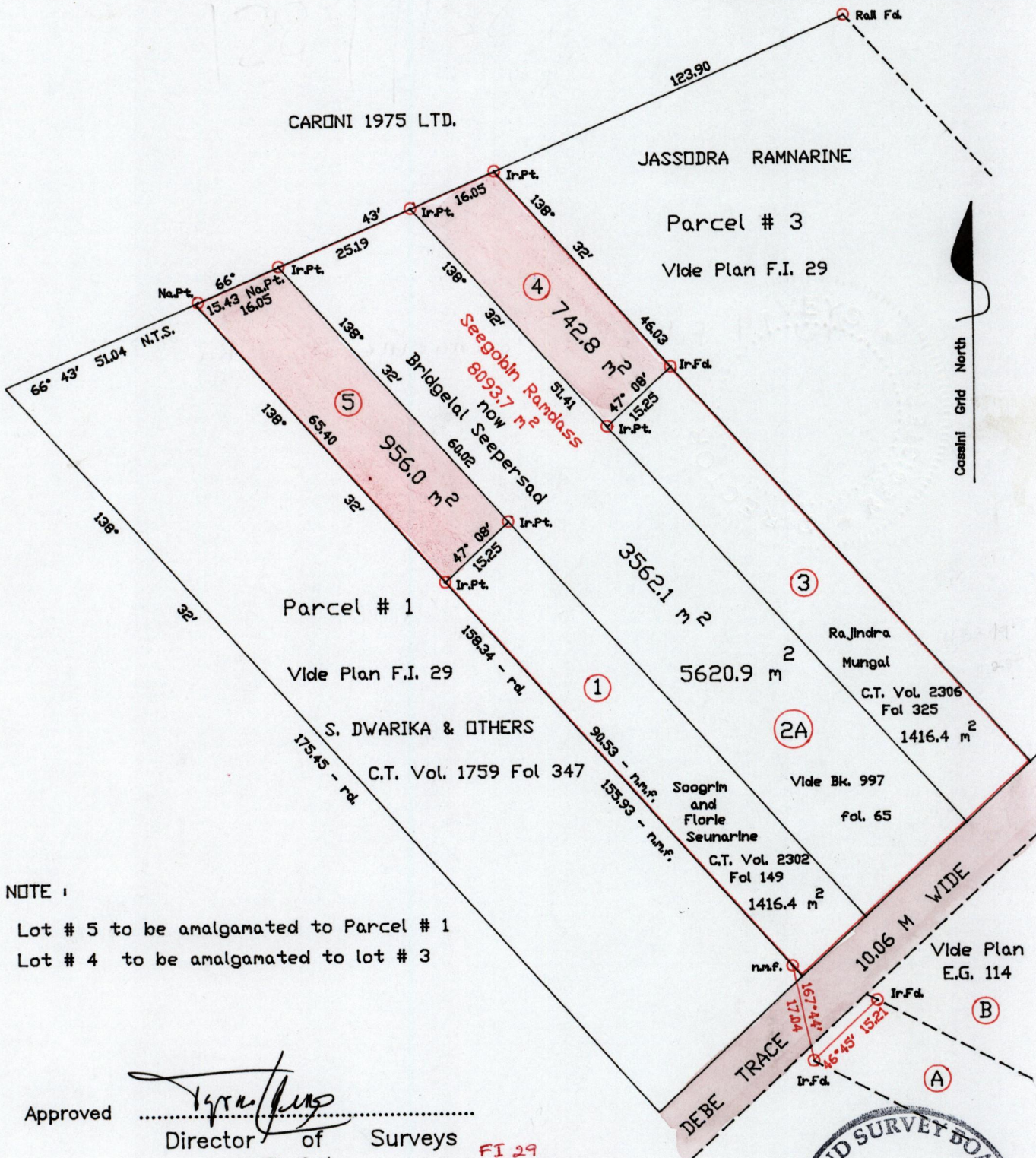

NOTE :

Lot # 5 to be amalgamated to Parcel # 1

Lot # 4 to be amalgamated to lot # 3

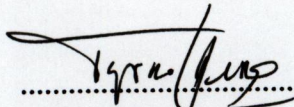
Approved 
Director of Surveys
25.04.04

SCALE 1 : 1000

Distances are in Metres.

Bearings are Cassini Grid, based on Solar Observations.

PLAN of Two Parcels of land coloured pink in the Ward of Naparima Containing together one thousand six hundred and ninety eight point eight square metres.

Surveyed by me, with due authority, May 2002.

In accordance with Regulation 25 (1) of the Land Surveyors' Regulations 1998,

I certify that this plan is correct.

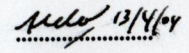
Checked by  13/4/04

Entered on 

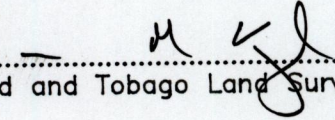
Trinidad and Tobago Land Surveyor
30th May 2002



1273
105

4

5 Vol. 4579 Fd. 285 Seunarine Dwarika

-6 APR 2004
Lands and
Surveys
Division

1289/158