

1328 14928

1364

34

Process ID 75304

R.P.O. Vol. 241 Fol. 553
C.T. Vol. 3384 Fol. 31

Cadastral Sheet G.13.K. 63F
Ward of Siparia 4/d
County of St.Patrick

Bk.1189 fol.144 Original

Vol. 4675 fol. 211

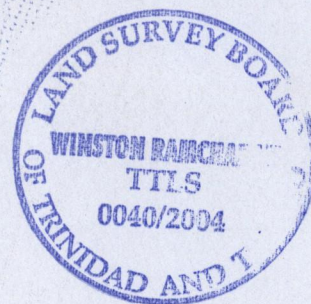
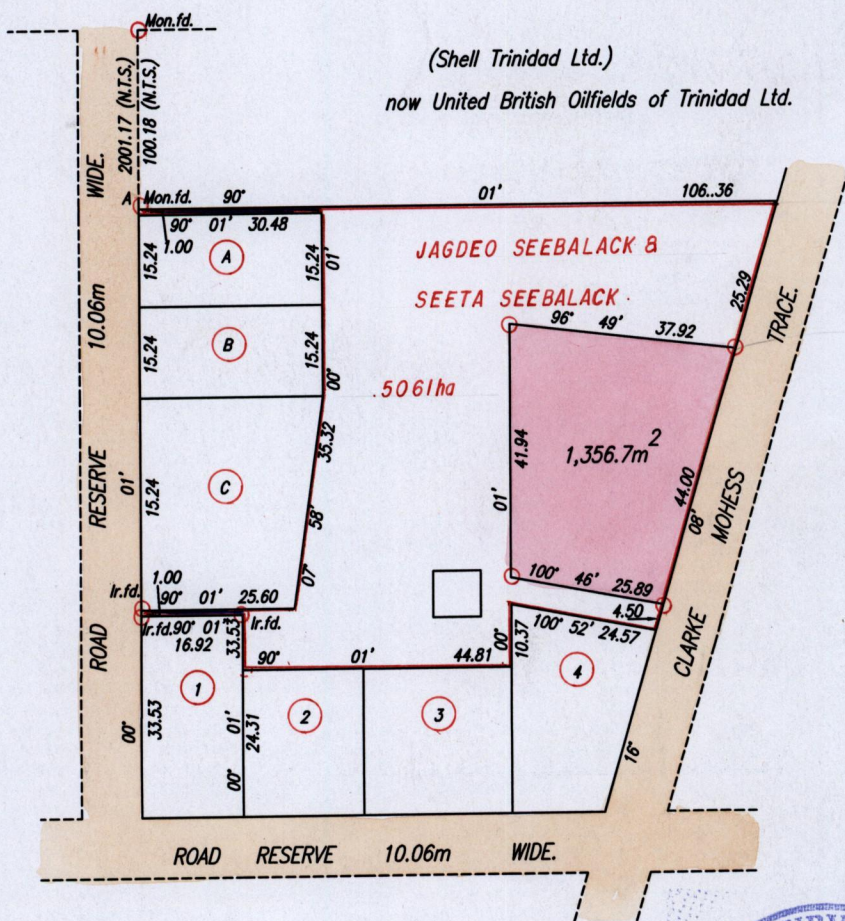

Chabindranand and Aeleima Ali Jagdeo

Approved

[Signature]
Director of Surveys

Existing Conc. Drain 1.00m Wide.

○ Denotes Iron put except otherwise stated.

Bearings are based on Solar Observations.(Cassini Grid.)

SCALE 1:1250

Distances are in Metres

PLAN of a Parcel of land coloured pink in the Ward of Siparia
Containing one thousand, three hundred and fifty six point seven square metres.
Surveyed by me, with due authority, in September, 2003
In accordance with Regulation 25(1) of the Land Surveyors' Regulations 1998,
I certify that this plan is correct.

Checked by *[Signature]*

Winston Ramcharan

Entered on *[Signature]*

Trinidad & Tobago Land Surveyor 27th February . . . 2004