

Vol. 4646 fol. 365

1328

31

R.P.O. Vol. 149 Fol. 291
C.T. Vol. 3511 Fol. 267

Ward of Siparia
County of St. Patrick
Cadastral Sheet (G.13.E). $\frac{63E}{2/c}$

Process ID# 74499

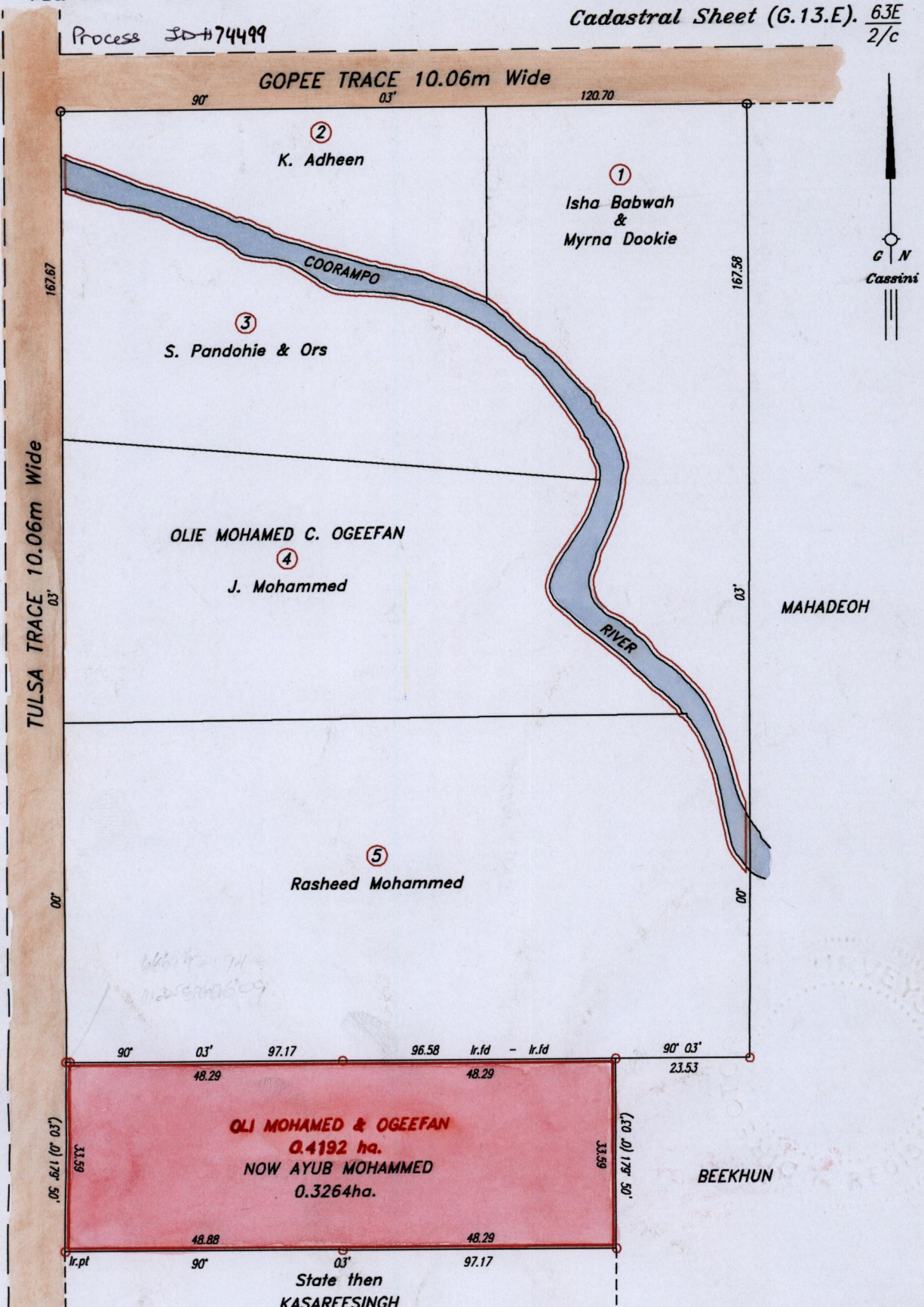

Approved

Director of Surveys

2004.9.20

○ Denotes Iron found except stated otherwise.

Bearings are Cassini based on Solar Observations.

Plan of a parcel of land coloured pink in the Ward of Siparia

Containing ~~zero point four one nine two hectares~~ zero point three two six four hectares.

Re-defined by me with due authority, in February, 2004

In accordance with Regulation 25 (1) of the Land Surveyors' Regulations 1998,

I certify that this plan is correct.

Checked by *M. de Silva* 15/10/04

Entered on *[Signature]*

Razi Mohammed

See Bk. 1200 Fol. 42

See Bk. 398 Fol. 189

Plan EH-155

SCALE 1 : 1000

Distances are in metres

Lenny W. Hanomansingh
Trinidad & Tobago Land Surveyor.....2004

