

1328

3

Process ID# 75805

R.P.O. Vol. 14 Fol. 449

C.T. Vol. 1254 Fol. 321

Vide Bk. 903 fol. 152

Plan AE 43

Vol. 4622 fol. 517

Cadastral Sheet G.13.B. 63F
Ward of Naparima 1/b
County of Victoria.

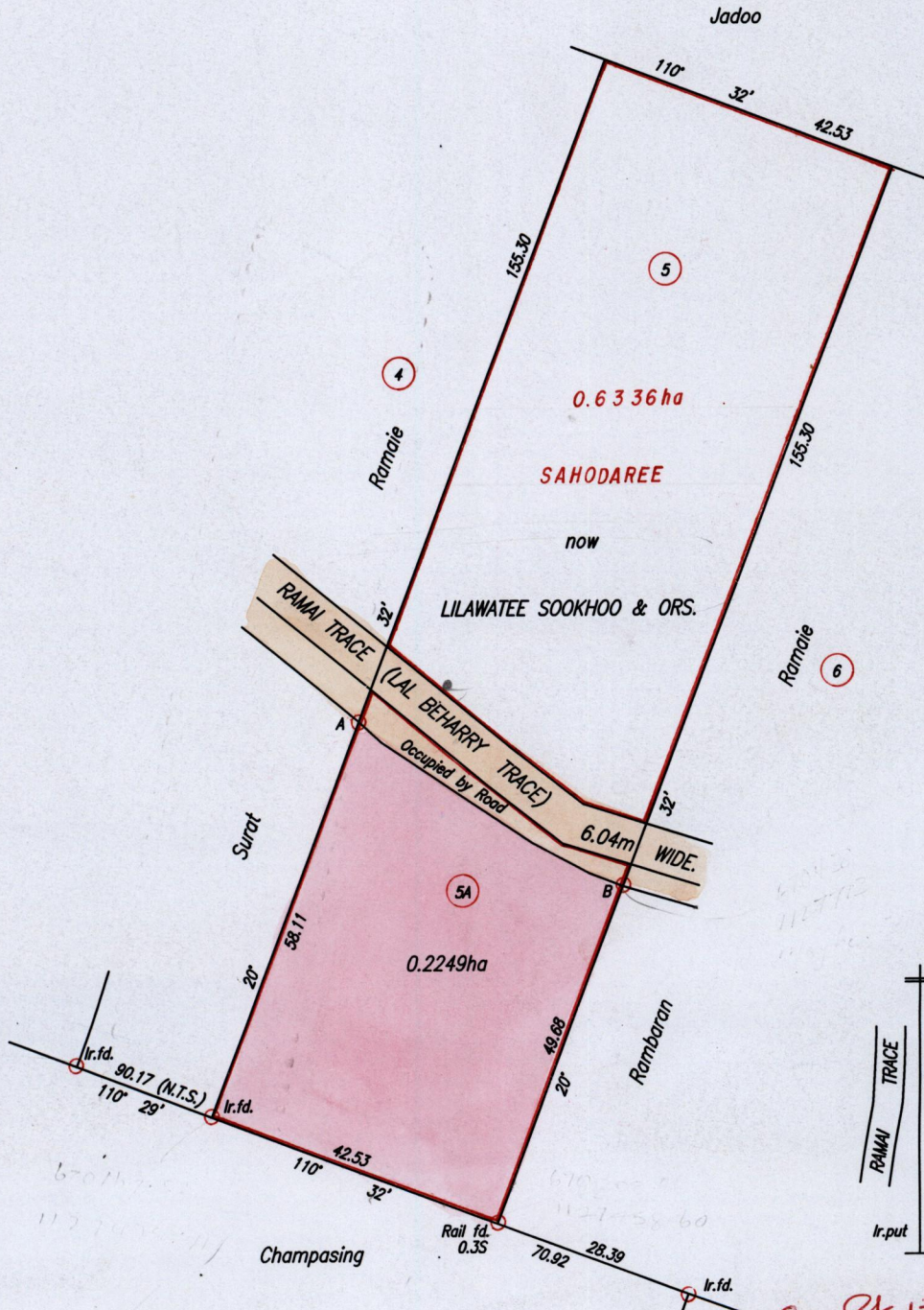

	B	Ir.put
RAMAI TRACE	43.36	0.0
	38.30	0.90
	29.45	1.50
	4.20	0.75
	0	0.0
Ir.put	A	121° 45'

Approved

[Signature]
Director of Surveys
2004-6-18

SCALE 1:1000

Distances are in Metres

○ Denotes Iron put except otherwise stated.

Bearings are based on Solar Observations.(Cassini Grid.)

PLAN of a Parcel of land coloured pink in the Ward of Naparima

Containing zero point two two four nine hectare.

Surveyed by me, with due authority, in March, 2004

In accordance with Regulation 25(1) of the Land Surveyors' Regulations 1998,
I certify that this plan is correct.

Checked by: *Zm 09/06/04*

[Signature]

Entered on: *[Signature]*

Trinidad & Tobago Land Surveyor *25th March* 2004
PATH = EV700 C:\Drawings04\NSookoo.dwg.

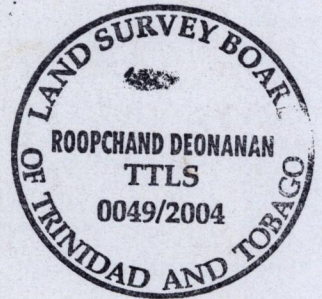

See Bk 1332:10 (5)
ANIRJOH MAHABIR