

1328

REMAINING PORTION

27

R.P.O. Vol. 144 Fol. 159

C.T. Vol. 4136 Fol. 11

Vol. 4620 Fol. 321

Ward of Siparia

County of St. Patrick

Cadastral Sheet (G.13.I.) 63.E.

4/b

Process ID 174473

a-b	152° 01'	6.64
b-c	116° 11'	3.11
c-d	117° 02'	3.19

Jagdish Deolart &
Saroj Basdeo
C.T. Vol. 4242 fol. 51

Mc. Coker then Matura

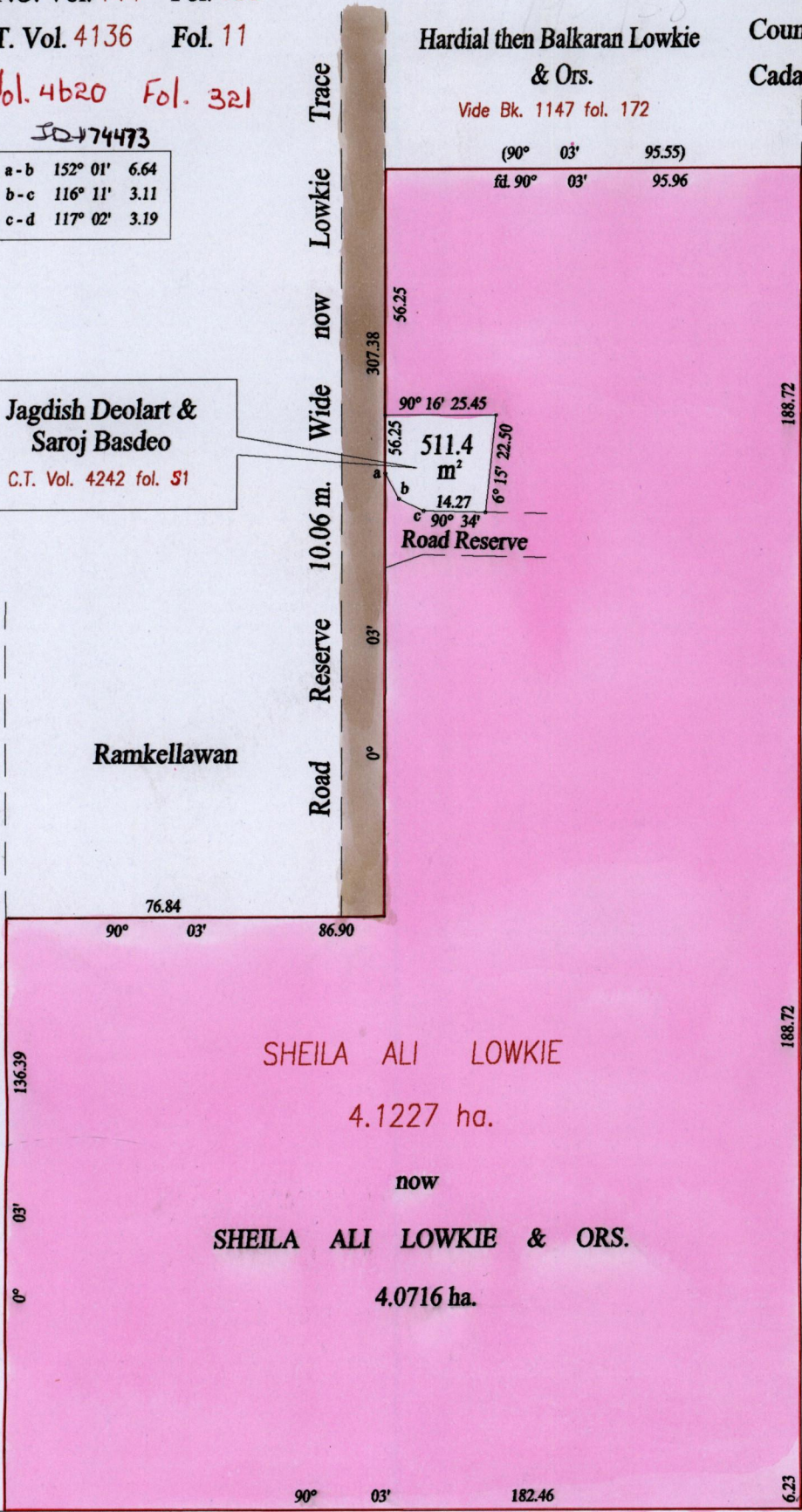

then
Eug. Goolcharan Lowkie
Cipriani
then
Clarke
now Seecharan Lowkie

Vide Plan B.F. 80

CASSINI

G N

Eug. Cipriani then Clarke

Approved

Director of Surveys

2004.10.11

3K 1287 fol. 134
Sheela & Radat Ali, Lowkie Lloyd

SCALE : 1:1500

Note: Bearings are cassini grid based on solar observations

Distances are in metres

This is a true copy of a diagram of four point one two two seven hectares, originally transferred to SHEILA ALI LOWKIE, shewing a portion coloured pink and containing four point zero seven one six hectares being the remainder after (1) previous transfer of another portion of the land.

In accordance with Regulation 25 (1) of the Land Surveyors' Regulations 1998, I certify that this plan is correct.

Checked by

Entered on ... Trinidad & Tobago Land Surveyor ... 13-07-2004

