

1328

181

REMAINING PORTION

R.P.O. Vol. 13 Fol. 309

C.T. Vol. 3046 Fol. 221

Vol. 4927 Fol. 467

Process ID # 75345

Ward of Naparima

County of Victoria

Cadastral Sheet (G.14.B) 64.A

3/d

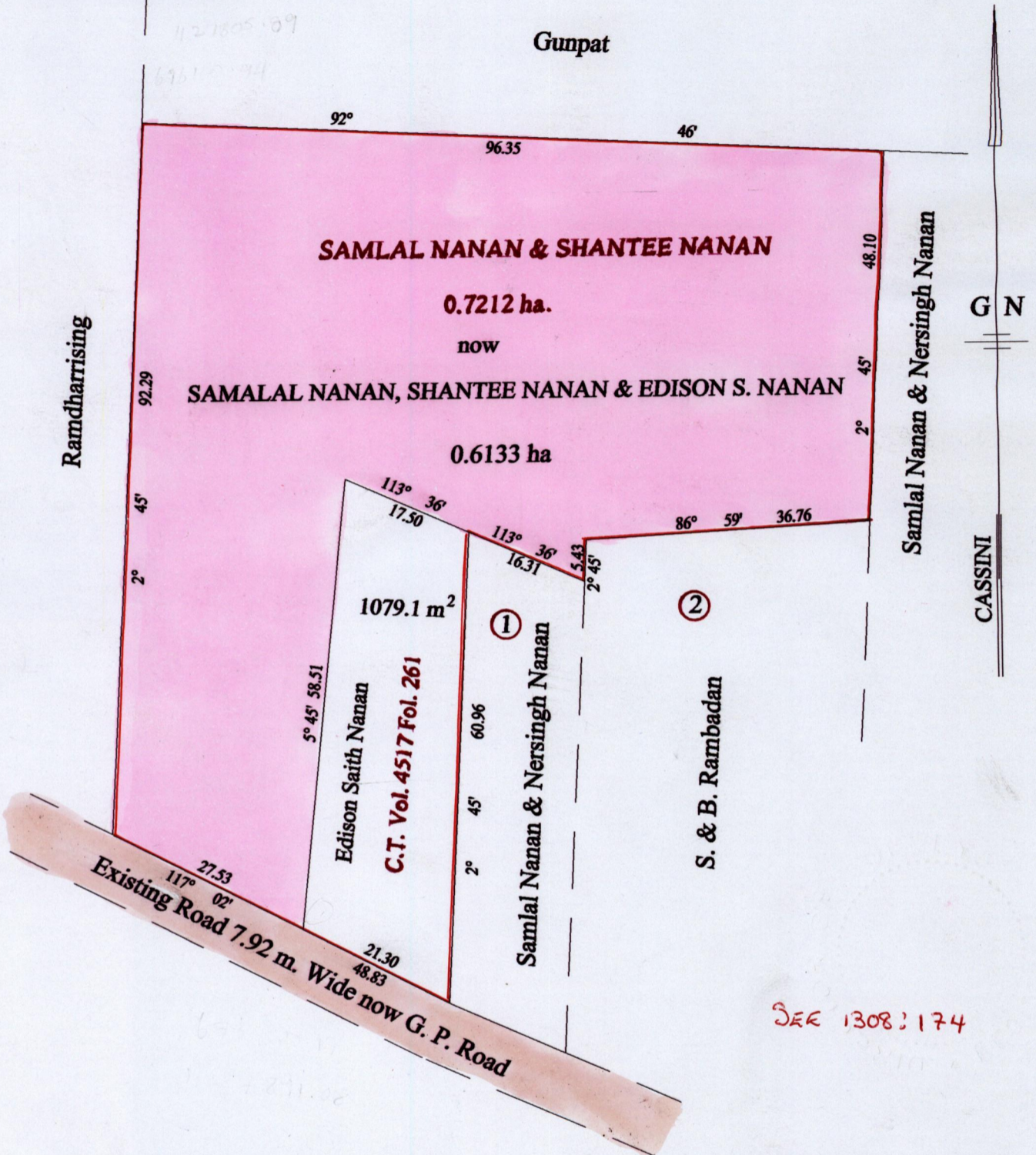

SEE 1308:174

Billy & Shanta Ramesar-Nayan

Approved *[Signature]*
Director of Surveys 2006.2.20

SCALE : 1:750

Note: Bearings are cassini grid based on solar observations Distances are in metres
This is a true copy of a diagram of zero point seven two one two hectares, originally transferred to SAMLAL NANAN & SHANTEE NANAN, shewing a portion coloured pink and containing zero point six one three three hectares being the remainder after one (1) previous transfer of another portion of the land. In accordance with Regulation 25 (1) of the Land Surveyors' Regulations 1998, I certify that this plan is correct.

Checked by *[Signature]* 10/2/06

Entered on RMS 11-12-2003 Trinidad & Tobago Land Surveyor *[Signature]* 4.08.2005

