

1328

176

Process ID#74475

Cadastral Sheet G.13.F. 63E  
2/d

R.P.O. Vol 97 Fol. 1

Ward of Siparia

C.T. Vol. 1597 Fol. 181

County of St. Patrick.

Vide Bk. 960 fol. 209, 211

Vol. 4600 fol. 433

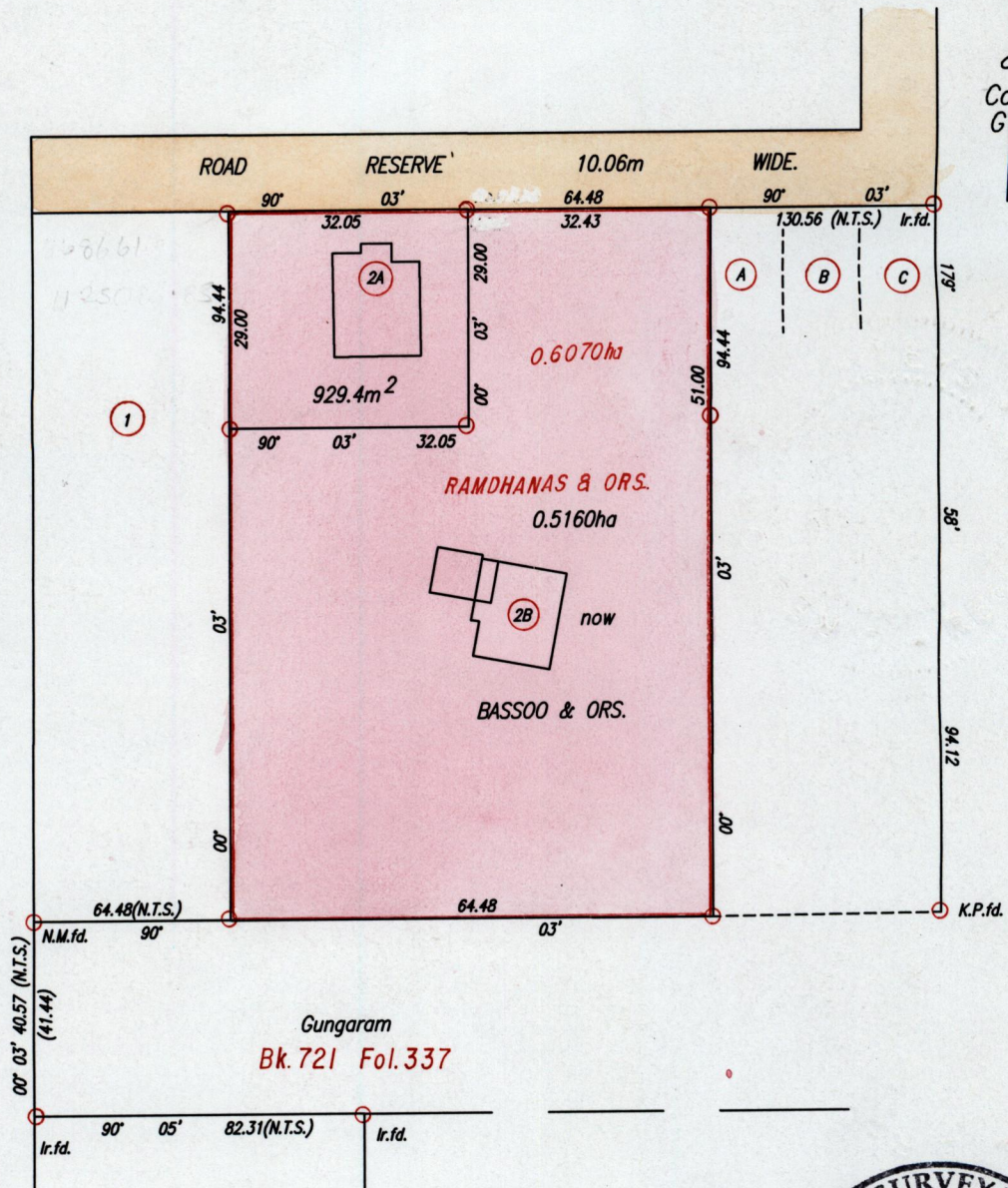

Cassini  
G | N

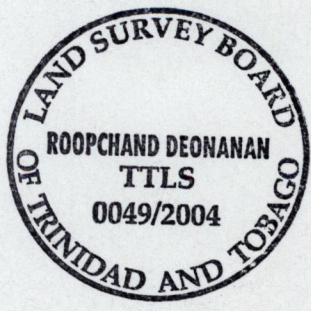

Approved *[Signature]*  
Director of Surveys  
25/04/04

SCALE 1:1000  
Distances are in Metres

○ Denotes Iron put except otherwise stated.  
Bearings are based on Solar Observations

PLAN of 2 Parcels of land coloured pink in the Ward of Siparia  
Containing together zero point six zero eight nine hectare.  
Surveyed by me, with due authority, in January, 2003  
In accordance with Regulation 25(1) of the Land Surveyors' Regulations 1998,  
I certify that this plan is correct.

Checked by *[Signature]* 1/04/04

Entered on *[Signature]* Trinidad & Tobago Land Surveyor 29<sup>th</sup> January 2004  
PATH = EV700 C:\Drawings\MRamdhanas.dwg

Original Bk 960: 209

Lot. (2A) Vol. 460 Fol. 4416 Mahendra & Sumatee Ramdhanas

Lot. (2B)

-5 FEB 2004  
Lands and  
Surveys  
Division

1289/449