

Process SD#73014

1328

R.P.O. Vol. 23 Fol. 121

C.T. Vol. 2040 Fol. 117

U.P.R.N. No.

Vol. 5022 Fol. 127

Cadastral Sheet E.2.B. 25F
3/b&4/a

Ward of Turure

County of St. Andrew

Vide Bk. 993 Fol. 166

See Bk 1280: 199

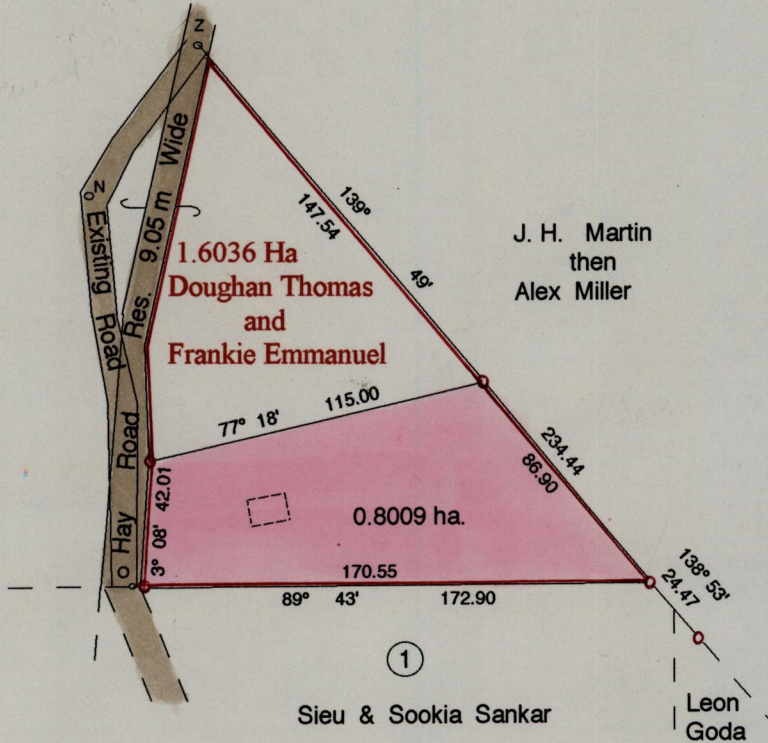

1.21	131.12	6.64
8.05	70.01	1.41
4.22	40.23	3.42
6.84	0.00	2.41
	N	173° 30'
6.84	61.50	2.41
4.22	30.98	4.22
4.22	0.00	4.22
	Z	216° 20'

Approved *[Signature]*
Director of Surveys
2000 7 5

SCALE 1: 2500

Distances are in metres

○ Denotes Iron Found unless otherwise stated.

Bearings are Cassini Grid based on Solar Obs.
To obtain compass bearings add 17 minutes

PLAN of a Parcel of land coloured pink in the Ward of Turure
Containing zero point eight zero zero nine hectares
Surveyed by me, with due authority, in April 2000 for Frankie Emmanuel
In accordance with rule 25 (1) of the Land Surveyors' Regulations 1998
I certify that this plan is correct.



Checked by *[Signature]* 06.06.06

Entered on *[Signature]*

[Signature]
Trinidad & Tobago Land Surveyor 26th May 2000