

Process ID H74214

VIDE BK. 610 / 184  
1135 / 473

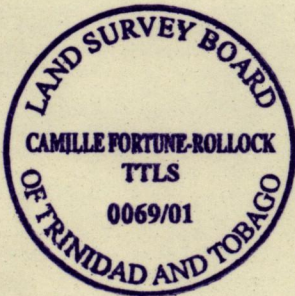
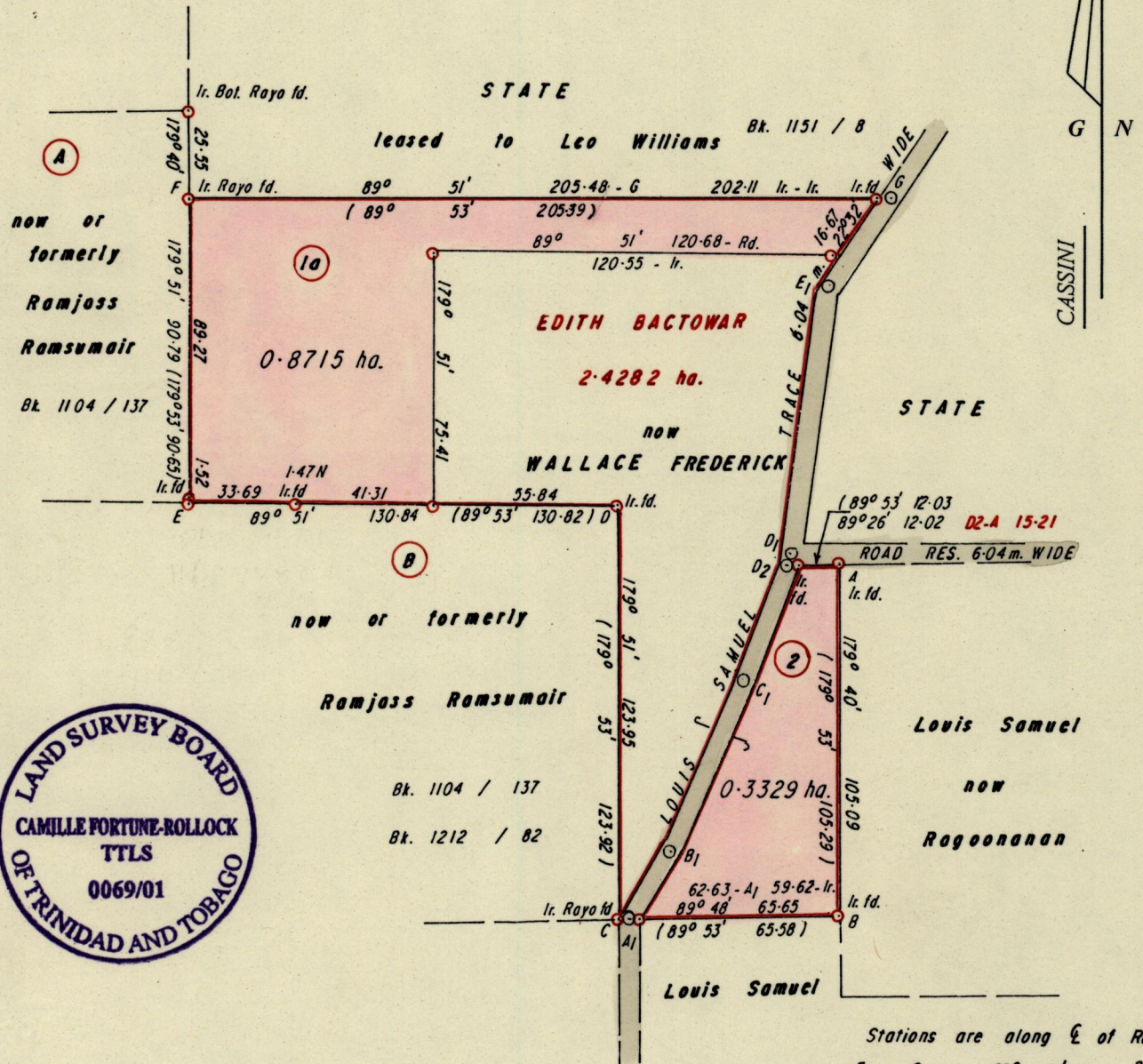

Approved

*[Signature]*  
Director of Surveys  
2002-03-04

Stations are along E of Road		
E1 - G	22° 44'	25.08
A1 - B1	30° 16'	23.62
B1 - C1	28° 15'	55.90
C1 - D1	13° 23'	36.87
C1 - D2	13° 23'	36.51
D1 - E1	9° 31'	87.49

○ Denotes Iron put unless otherwise stated  
Bearings are Cassini Grid based on Solar Obs.

SCALE 1 / 2000

Distances are in METRES

Note: To Obtain compass bearings add/subtract minutes

PLAN of 2 Parcels of land coloured PINK in the Ward of San Raphael  
Containing together one point two zero four four hectares  
Surveyed by me, with due authority, in March 2001  
In accordance with Rule 25 (1), of the Land Surveyors Regulations 1998,  
I certify that this plan is correct.

Checked by *[Signature]* 2002-02-18  
Entered *[Signature]* 2002-05-11-2013  
Trinidad and Tobago Land Surveyor *Camille Fortune-Rollock*  
31<sup>st</sup> December 2001



Lot 1a.

Lot 2. Vol. 4442 7d. 241 Lily Lane

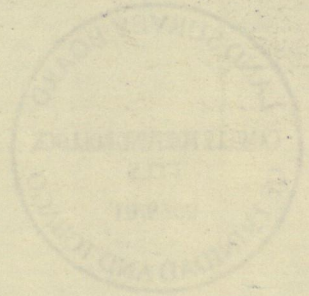
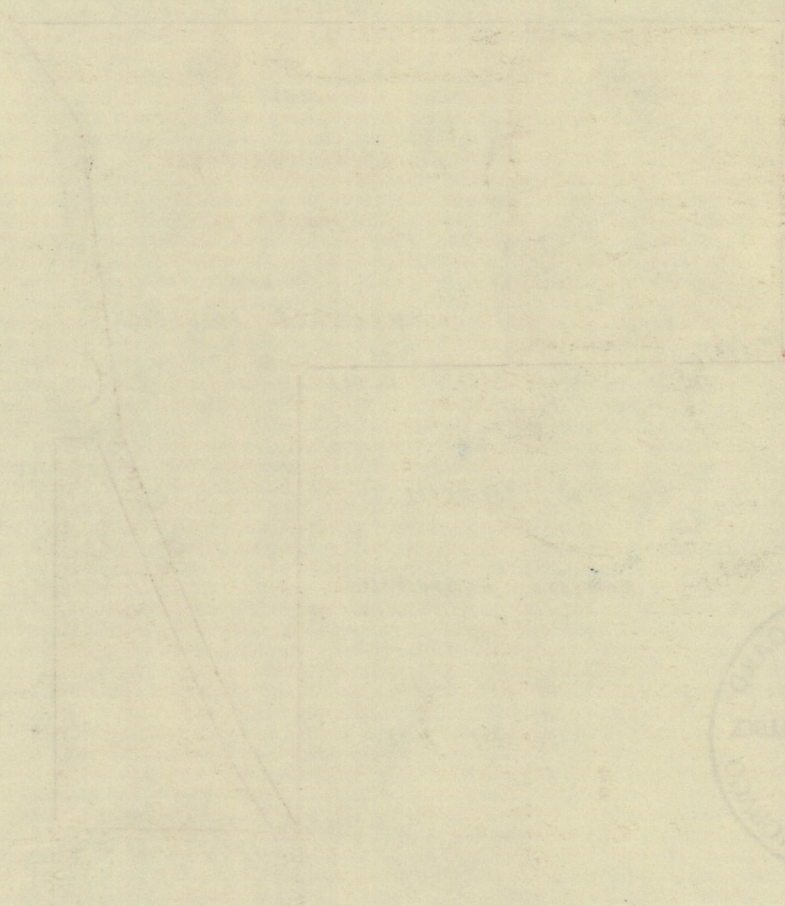

30 DEC 2001  
Lands and  
Surveys  
Division