

Process Id #73061

1328

L. and S.—53

142

U.P.R.N.

A No 6572

Cadastral Sheet B. 24.1. $\frac{24C}{376}$

Borough of Arima.

R.P.O. Vol. 729. Fol. 171.

C.T. Vol. 3096 Fol. 105.

County of St. George.

Vide Bk. 1163 fol. 43.

Vol. 4621 Fol. 189

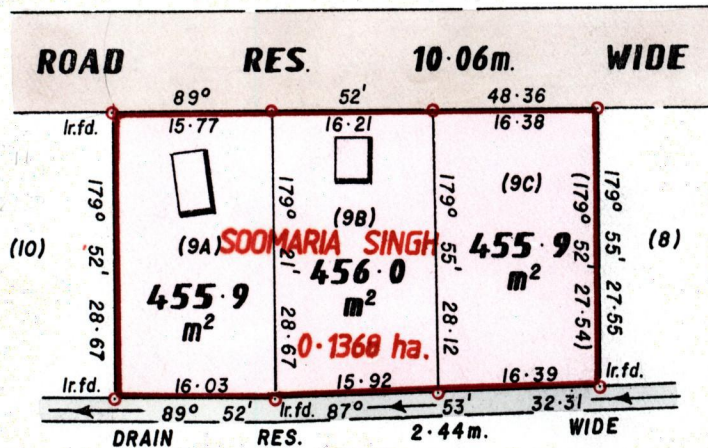

Cassini
G N

N. H. A.

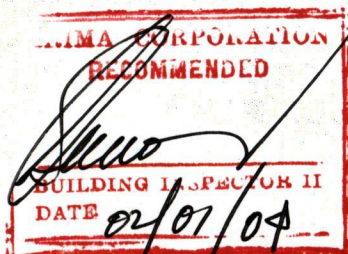

Approved

Director of Surveys

• Denotes iron put except otherwise stated.

SCALE 1: 750.

Cassini Grid bearings based on Solar Observations.

Note: To obtain compass bearing subtract minutes Distances are in metres.

PLAN of 3 Parcel(s) of land coloured pink in the Borough of Arima.

Containing together zero point one three six eight hectares.

Surveyed by me, with due authority, in November 2000.

In Accordance with Rule 25 (1) of the Land Surveyors' Regulations 1998, I certify that this plan is correct.

Checked by Winston Ramcharan Trinidad & Tobago
Entered on 1st May 2001 Land Surveyor

9A. Vol. 4621 Fol. 195 VISHNEW & SHARMIN KOON KOON.

20

9B.

9C. Vol. 4621 Fol. 203 SOOKNATH & SHERENE KOON KOON.

20

20

25 MAY 2001
Lands and
Surveys
Division

1289/94