

Process SD#74605

R.P.O. Vol. 111 Fol. 281

C.T. Vol. 4204 Fol. 67

U.P.R.N. No.:

Vd. 4666 7d. 211

now or formerly
Louis Maloney

1328

1376

Ward of Siparia

County of St. Patrick

Cadastral Sheet G.13.N. $\frac{63F}{3/c}$

137

9

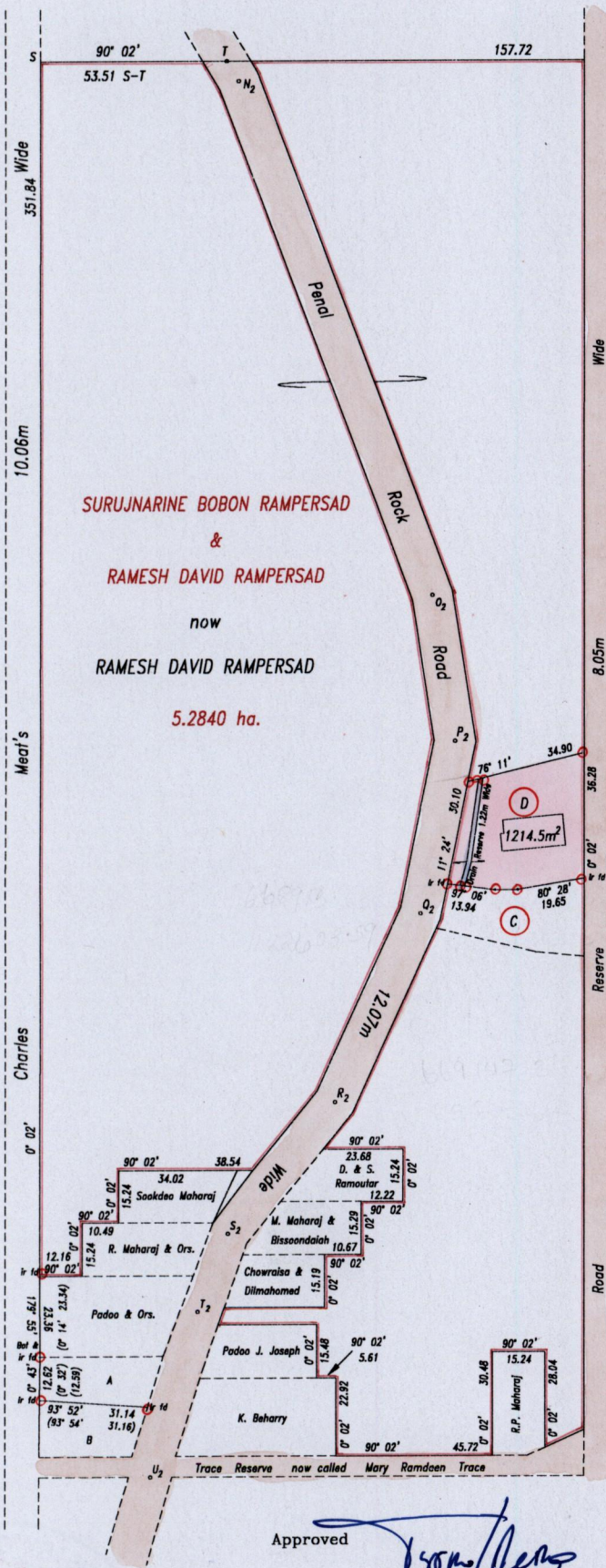

Legend		
Centre Line of Penal Rock Road 12.07m Wide		
T - N ₂	149° 23'	6.79
N ₂ - O ₂	159° 15'	159.33
O ₂ - P ₂	171° 12'	42.85
P ₂ - Q ₂	191° 24'	51.00
Q ₂ - R ₂	204° 41'	59.85
R ₂ - S ₂	219° 08'	49.29
S ₂ - T ₂	201° 06'	24.14
T ₂ - U ₂	195° 45'	83.48

G.N. Cassini

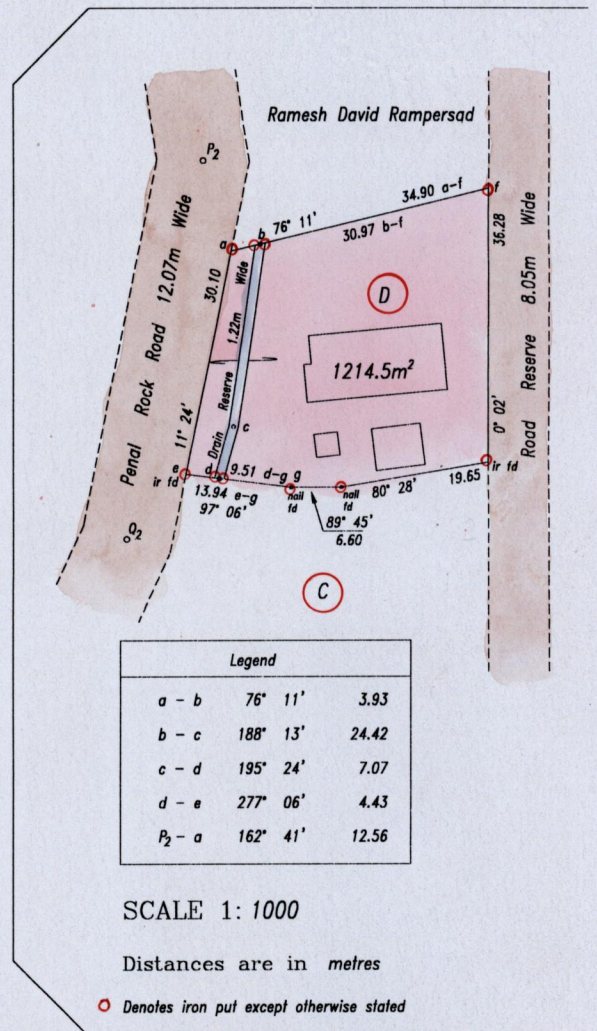

Legend		
a - b	76° 11'	3.93
b - c	188° 13'	24.42
c - d	195° 24'	7.07
d - e	277° 06'	4.43
P ₂ - a	162° 41'	12.56

SCALE 1: 1000

Distances are in metres

○ Denotes iron put except otherwise stated

Ramesh David Rampersad

References: Bk.391 Fol.123

Plan B.A. 36

Bk.723 Fol.146

Bk.723 Fol.165-167

Bk.723 Fol.206

Bk.834 Fol.197-199

Bk.1211 Fol.168

Bk.1238 Fol.129

Parcel	Transferee	Area	C.T. Vol.	Fol.
C	Ramesh David Rampersad	711.4m ²	4559	203

SCALE 1: 2000

Distances are in metres

○ Denotes iron put except otherwise stated

Approved

Director of Surveys

SEE 1308:24

Bearings are Cassini Grid based on Solar Observations

PLAN of a parcel of land coloured pink in the Ward of Siparia

Containing one thousand two hundred and fourteen point five square metres

Surveyed by me, with due authority, in February & September 2003

In accordance with Regulation 25(1) of the Land Surveyors' Regulations 1998, I certify that this plan is correct.

Checked by mm. 21/03/05

Entered CM.S. 18.10.2013

L.A. Roperand

Trinidad & Tobago Land Surveyor 7/3/2005

