

1328

1361

12

113

REMAINING PORTION

R.P.O. Vol. 104 Fol. 565

C.T. Vol. 3342 Fol. 145

Vol. 4683 fol. 261

Process IDA 74627

Ward of Siparia

County of St. Patrick

Cadastral Sheet (G.13.G.) 63.F
1/d

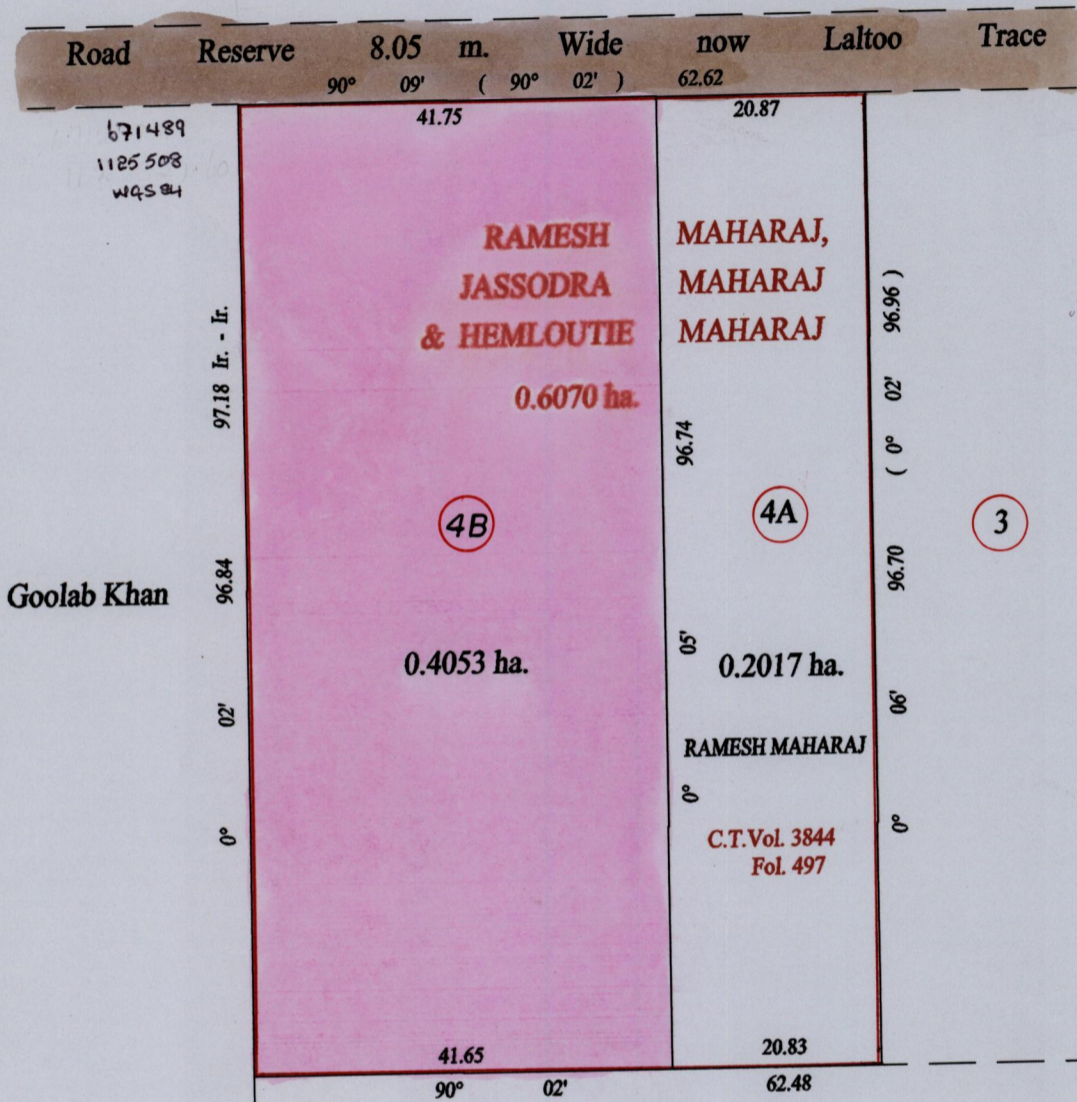

Goolab Khan

U.B.O.T.

Vide Bk. 1233 fol. 57

1189.62

Original Bk 1189:62

Sienarine & Sterling Sienarine
Persad

Approved *[Signature]*
Director of Surveys

SCALE : 1:750

Note: Bearings are cassini grid based on solar observations

Distances are in metres

This is a true copy of a diagram of zero point six zero seven zero hectares, originally transferred to RAMESH MAHARAJ, JASSODRA MAHARAJ & HEMLOUTIE MAHARAJ, shewing a portion coloured pink and containing zero point four zero five three hectares being the remainder after one (1) previous transfer of another portion of the land. In accordance with Regulation 25 (1) of the Land Surveyors' Regulations 1998, I certify that this plan is correct.

Checked by *[Signature]* *[Signature]*



Entered on *[Signature]* 22. 11. 2002