

1328

REMAINING PORTION

Process ID# 74464

R.P.O. Vol. 138 Fol. 29

C.T. Vol. 1745 Fol. 131

U.P.R.N. No.:

Vol. 4647 fol. 71

Ward of Siparia

County of St. Patrick

Cadastral Sheet G.12.L 63E
4/a

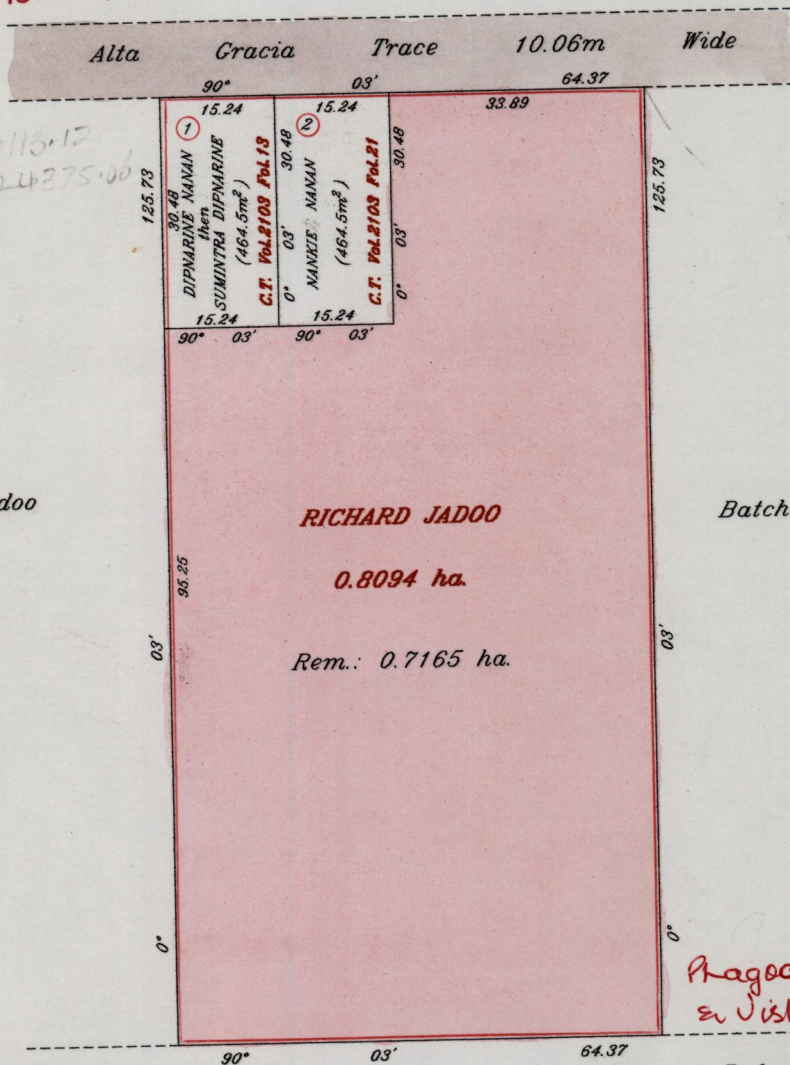

666113.12
1124375.06

114553

Boodram Jadoo
then
Parcel 2

RICHARD JADOO

0.8094 ha.

Rem.: 0.7165 ha.

Batchan Baboolal
1308 : 73

Pragee, Kishore, David
& Vishnu Rampersad

Approved

[Signature]
Director of Surveys 2000.9.18

Reference: Bk.1003 Fol.99
Angela Seenathsingh & Shakula Mahase

SCALE 1: 1000

Distances are in metres

This is a true copy of a diagram of zero point eight zero nine four hectares originally transferred to RICHARD JADOO, showing a portion coloured pink and containing zero point seven one six five hectares being the remainder after two (2) previous transfers of another portion of the land. In accordance with Rule 25(1) of the Land Surveyors' Regulations 1998, I certify that this plan is correct.

Checked by 24.00.09.12

Entered *[Signature]*

[Signature]
Trinidad & Tobago Land Surveyor 24/7/2000

