

Process IDA73026

Nº 46710

Vol. 4592 fol. 159

R.P.O. Vol. 36

Fol. 387

C.T. Vol. 1348

Fol. 181

Rem. Portion Plan - R.P.O. Vol. 476 fol. 361

Ward of Manzanilla

County of St. Andrew

Cadastral Sheet C.22.M. (25 F / 1/b)

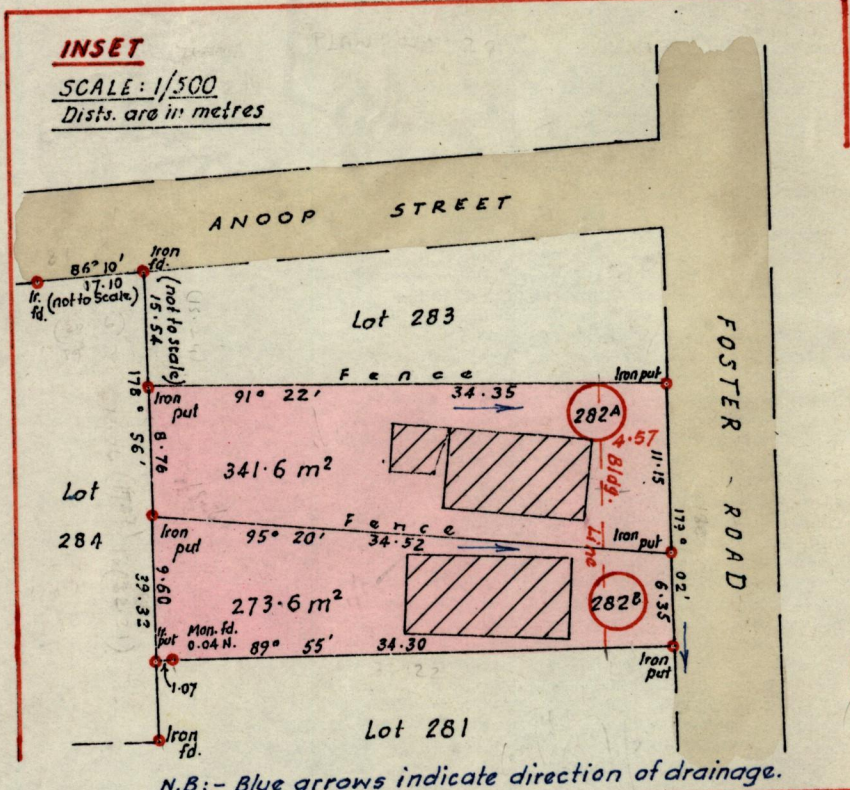
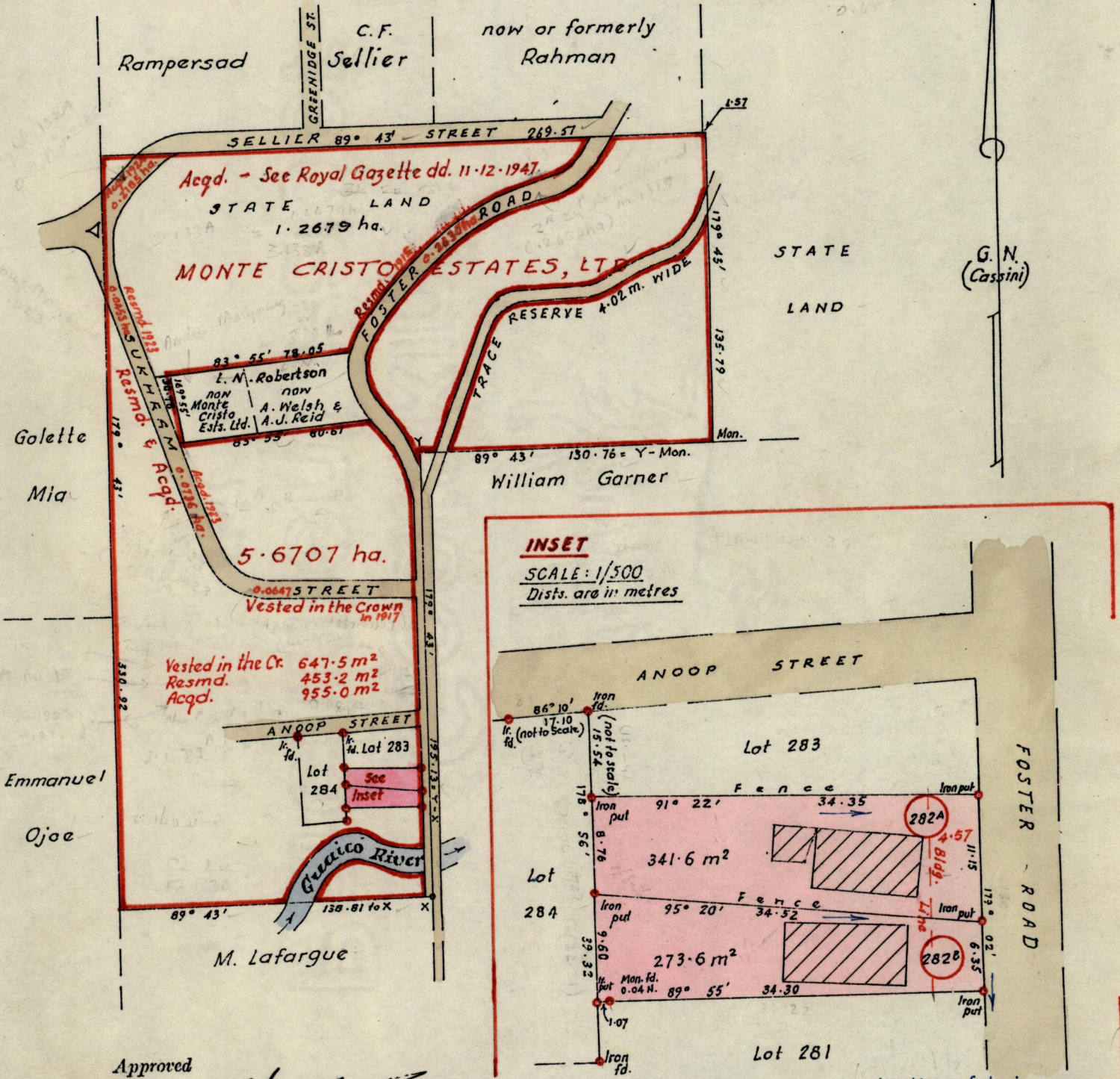

Approved

Alonso Kilgus
 Director of Surveys
 89.01.09

Note: To obtain compass bearings add 17 minutes

PLAN of 4 Parcels of land coloured pink

~~Containing~~

Surveyed by me, with due authority, in November 1987.

I certify that I have complied with rule 76 under Section 14 (2) (d) of the Land Surveyors' Ordinance 1952, and that this plan is correct.

Checked by *[Signature]* 5/1/89

Entered *[Signature]*

[Signature]
 Land Surveyor, Trinidad 10th December 1987

SCALE: 1/2500

EX 1328 : 103

Distances are in metres in the Ward of Manzanilla

15651

Orig. Sur. Bk. 156 : 51

282 A - Vol. 4592 fol. 193.

Esau Hosein

282 B - Vol. 4592 fol. 195

Esau Hosein

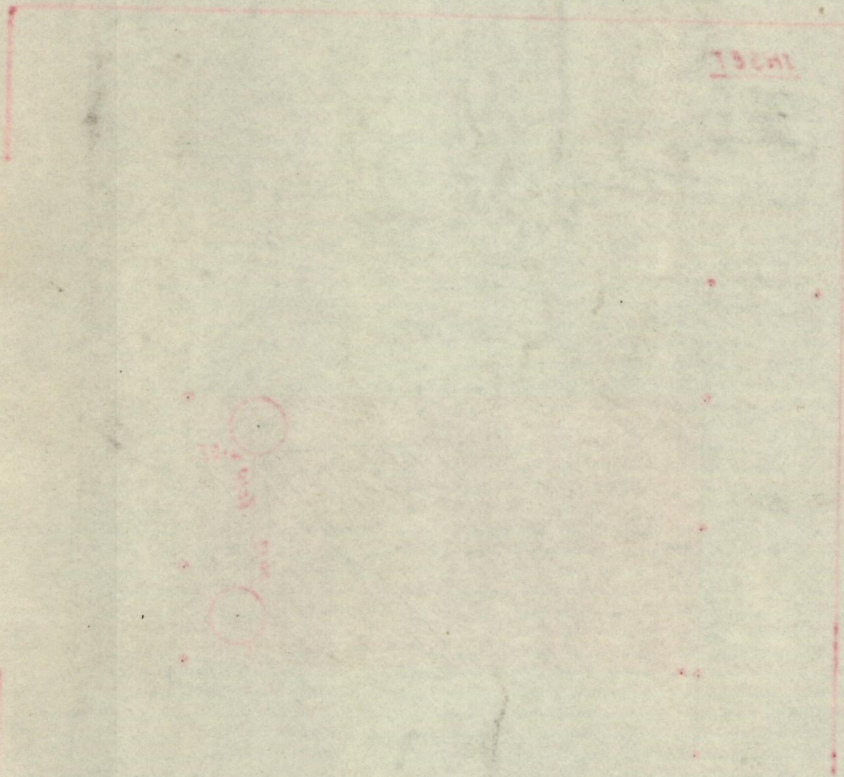
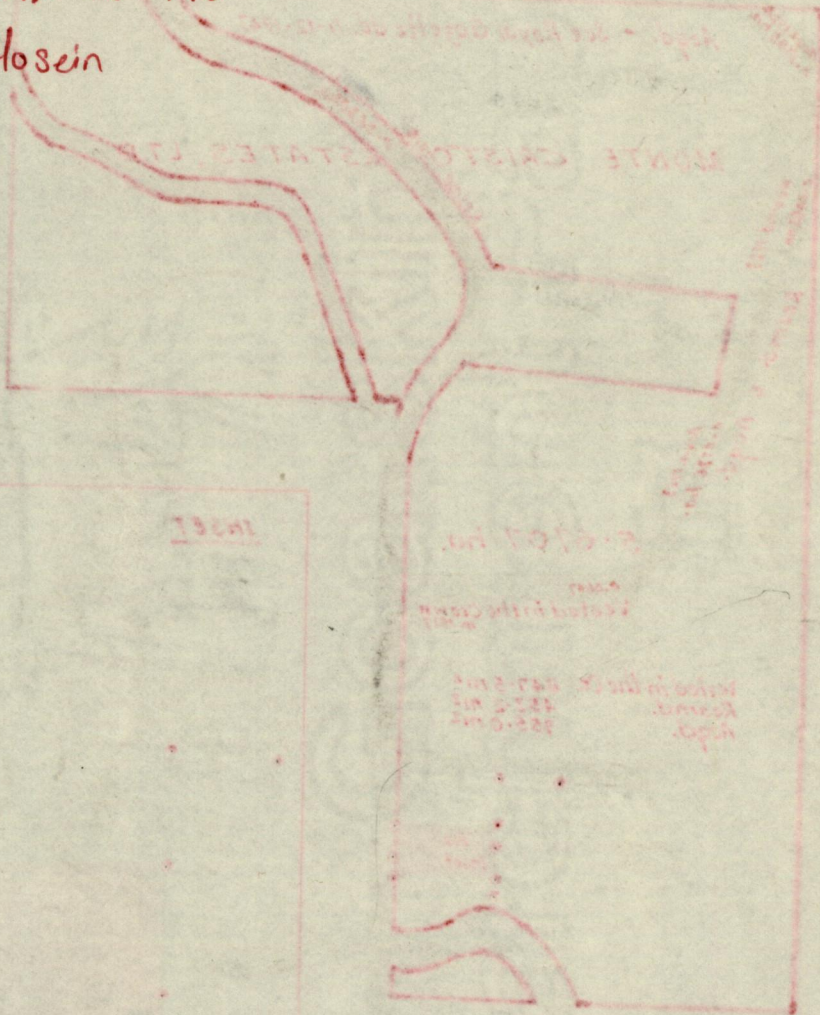

Esau Hosein