

1328

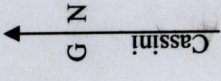

Ward of Naparima
County of Victoria
Cadastral Sheet G 8 N 63 C
3/c

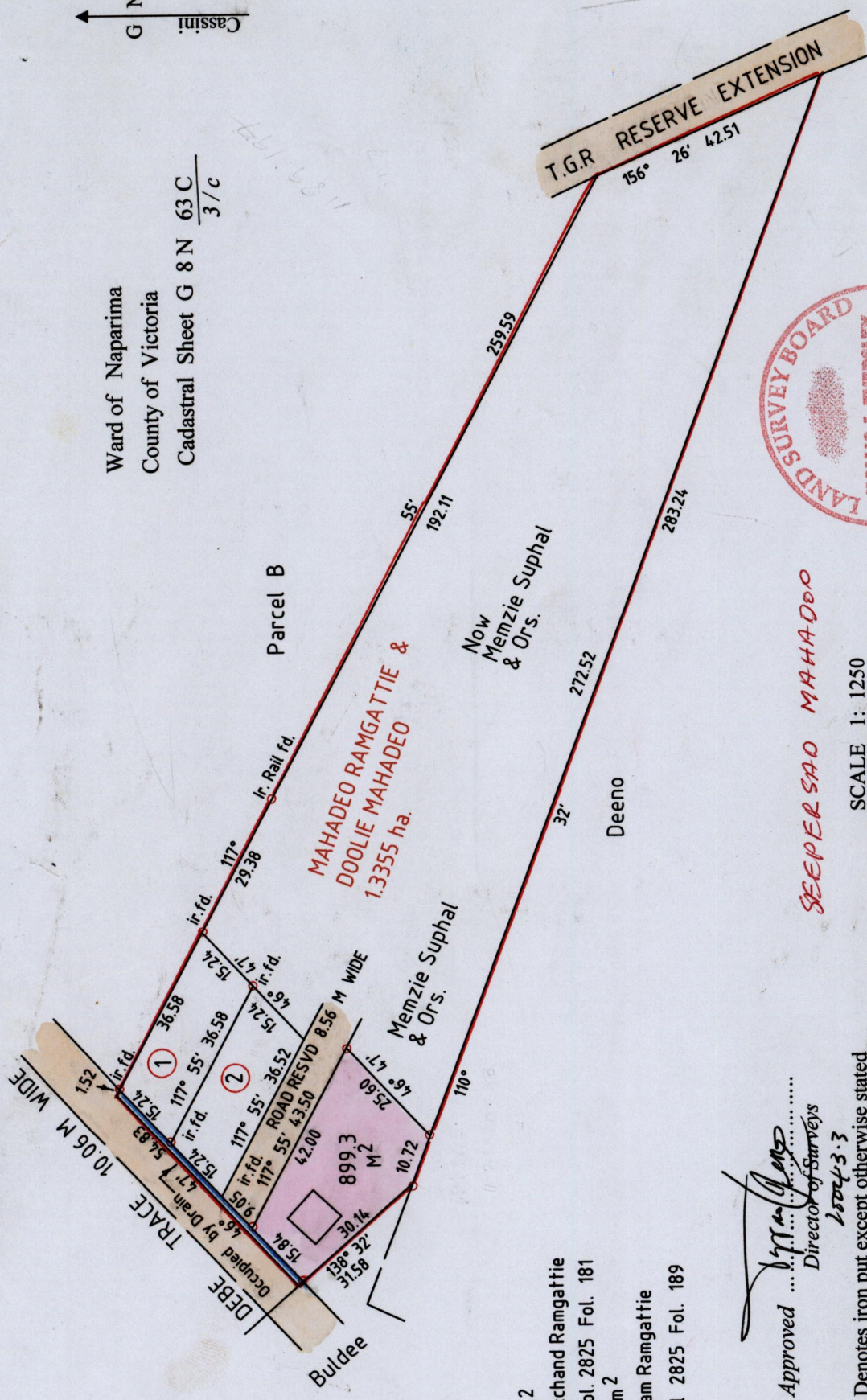

R.P.O Vol. 28 Fol 563
C.T Vol. 1994 Fol 307
Vide Plan E.G 114
Bk. 1137 Fol 192
Bk. 1249 Vol. 2 Fol. 28

Vol. 4688 Fol. 37

Process *SD#74388*

Lot 1 = 549.4 m²
Manickchand Ramgattie
C.T Vol. 2825 Fol. 181
Lot 2 = 549.4 m²
Gangaram Ramgattie
C.T Vol 2825 Fol. 189

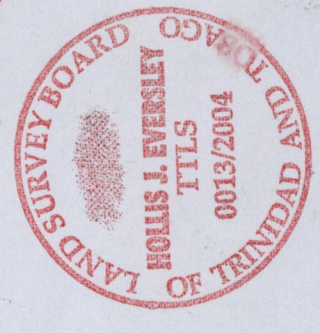

SEEPERSAO MAHADEO

Approved
Director of Surveys
2004.3.3

o Denotes iron put except otherwise stated
Note: To obtain compass bearings add/subtract minutes
PLAN of a Parcel of land coloured Pink in the Ward of Naparima

Containing eight hundred and ninety nine point three Square metres
Surveyed by me, with due authority, in September 2002

In accordance with Regulation 25 (1) of the Land Surveyors Regulations 1998, I certify that this plan is correct.
Checked by *M.M. 13/2/04*

[Signature]
Trinidad and Tobago Land Surveyor *20. January 2004*

Entered. *[Signature]*