

133

Process J2+66389

1308

96

R.P.O. Vol. 568 fol. 171
C.T. Vol. 4274 fol. 181

Ward of Siparia
County of St. Patrick
Cadastral Sheet (G.14. I.) $\frac{63 F}{4/b}$ $\frac{64 D}{3/a}$

Vol. 4652 Fol. 395

Maneeram then
George Skeete



STATE

Plan Q.D. 145

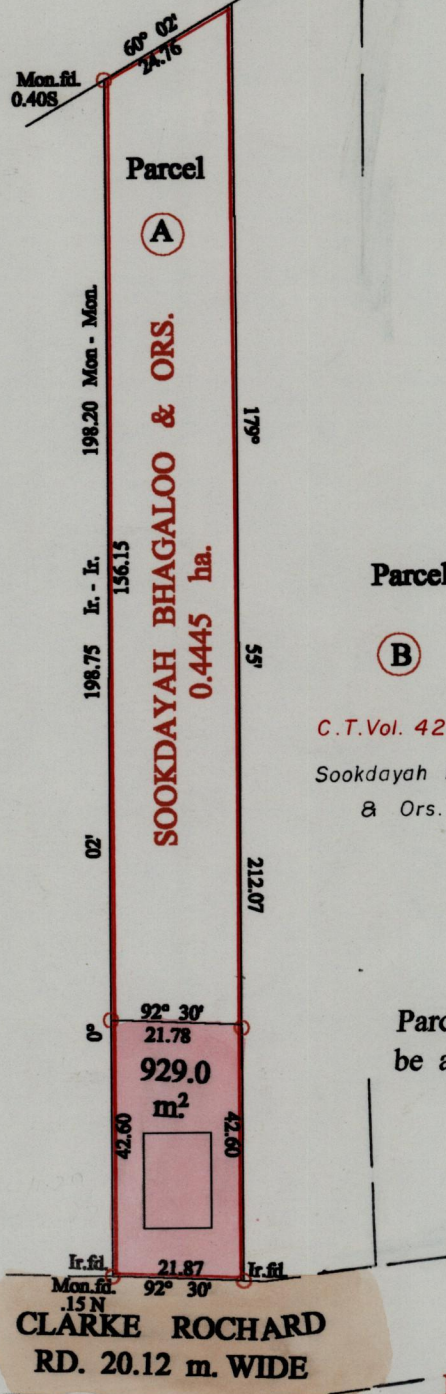

Approved *[Signature]*
Director of Surveys
2002.10.26

○ Denotes Iron Put Except
Otherwise Stated

SCALE : 1: 1250

Note: Bearings are cassini grid based on solar observations Distances are in metres
PLAN of a Parcel of land coloured pink in the Ward of Siparia
Containing nine hundred and twenty nine sq. metres
Surveyed by me, with due authority, in Oct. 2002
In accordance with Regulation 25 (1) of the Land Surveyors' Regulations 1998,
I certify that this plan is correct.

Checked by *[Signature]* 20/10/03. *[Signature]*

Entered on *[Signature]* Trinidad & Tobago Land Surveyor 20th October, 2002